

# Quick-Fit<sup>®</sup> and Flanged Ducting



## Price List 2023

Prices remain effective from August 1, 2022



Made in  
the USA



## Ordering from Nordfab Ducting

This condensed price list contains pricing for many of Nordfab's standard products. Contact Nordfab or your Nordfab Authorized Dealer when you need pricing for duct in larger sizes, a gauge not shown here, or a customized product.

Nordfab manufactures duct in sizes up to 72" and gauges as thick as 10ga.

If you need parts with mixed end types such as an Angle Flange on one end of a QF Branch, add the price of the appropriate size Angle Flange to the needed QF Branch and be sure to specify that X end is ANGFL when ordering.

Nordfab does not require part numbers for ordering. Just tell us what you need.

### Examples:

Pipe Galv 14QF

Branch Galv 20QF 18QF 12QF 45deg

Reducer 304SS 12AFL 8AFL

Elbow Galv 14ga 8QF

Double Branch 10ga Galv 72AFL 70AFL 62AFL 62AFL 30deg

## Information Needed to Order Nordfab Products

| REQUIRED for any Nordfab product   |  |  |  |   | Product Dependent  |   |   |  |
|--|--|--|--|---|--|---|---|--|
| Product Name   | Material Type  | Material Thickness   | Dimensions   | End Type  | Angle & Radius   | Length  | Control   | Clamp Seal   |
| <i>Examples:</i><br>Pipe<br>Clamp<br>Elbow<br>Branch<br>Hose Adapter<br>Clear Rubber Hose<br>Canopy Hood<br>Ball Joint | <i>Examples:</i><br>Galvanized Steel<br>Stainless Steel<br>Mild Steel<br><br>If you do not specify material, Nordfab will supply as standard Galvanized Steel. | <i>Examples:</i><br>20ga<br>16ga<br>14ga<br>10ga<br><br>If you do not specify gauge, Nordfab will supply the product with our standard gauge material. | The A dimension is required.<br><br>Reducers: A and B are required.<br>Branches: A, B, and C are required.<br>Double Branches: specify A, B, C, D.<br><br>See our Branches section for other configurations. | <i>Examples:</i><br>QF<br>AFL<br>Hose<br>Raw ID | Required for Elbows<br><br>Branch parts are supplied standard with 30° angle. 45° can be supplied. | <i>Example:</i><br>10ft Black Rubber Hose<br><br>Nordfab hose is supplied in 5 foot increments. | Auto Diverter Valves and Blast Gates can be made with various AC or DC requirements. Blast Gates can be provided with single or double cylinders. Reed Switches are also available. | <i>Examples:</i><br>Nitrile<br>Silicone<br>ePTFE<br><br>If you do not specify the seal, Nordfab will supply Nitrile as standard. |

| Galvanized Steel Material Thickness Options | Stainless Steel Material Thickness Options |
|---|--|
| 22ga  | 22ga                                       |
| 20ga  | 20ga                                       |
| 18ga  | 18ga                                       |
| 16ga  | 16ga                                       |
| 14ga  | -  |
| 12ga  | -  |
| 10ga  | -  |

| End Type     | Abbreviation |
|--------------|--------------|
| Quick-Fit    | QF           |
| No Fit       | NF           |
| Raw ID       | RI           |
| Raw OD       | RO           |
| Rawflex      | RF           |
| Angle Flange | AFL          |
| Flat Flange  | FFL          |
| Vanstone     | VS           |

**Use this Price List with our Product Reference to specify and purchase Nordfab ductwork.**

Contact Nordfab for assistance with pricing on heavier gauge items as well as larger diameter items if pricing is not included in this price book.

| Type  | Description               | Page | Type  | Description   | Page | Type  | Description                            | Page | Type  | Description                             | Page |
|---|---------------------------|------|---|---|------|---|--|------|---|---|------|
| <b>Pipe &amp; Clamps</b>  |                           |      | <b>Adapters</b>   |   |      | <b>Hoods</b>  |  |      | <b>Accessories</b>  |   |      |
|    | QF Clamp                  | 4    |    | Reducer   | 14   |    | Barrel Hood                            | 18   |    | Weather Cap                             | 21   |
|     | QF Pipe & Flanged Pipe    | 4-5  |    | Angle Flange Adapter                                  | 6    |    | Bell Mouth Hood                        | 18   |    | No-Loss Stackhead                       | 21   |
|    | Quick-Fit Sleeve & O-Ring | 5    |    | Machine Adapter                                       | 15   |    | Canopy Hood                            | 18   |    | Jet Cap                                 | 22   |
|    | Quick-Fit Sleeve Assembly | 5    |    | Hose Adapter  | 15   |    | Radial Arm Saw Hood                    | 18   |    | Silencer                                | 22   |
|     | Angle Flange              | 6    |    | Transition Rectangular to Round                       | 14   |    | Router Hood & Router Hood w/ Magnet    | 18   |    | Suction Nozzle Assembly                 | 22   |
|     | Angle Flange Gasket       | 6    |    | End Cap & End Cap with Bird Screen                    | 15   |    | Suction Hood                           | 18   |    | In Line Back Draft Damper               | 23   |
| <b>Elbows</b>   |                           |      |    | End Plate   | 15   | <b>Diverter Valves</b>  |  |      |    | Ball Joint                              | 22   |
|    | QF Elbow & Flanged Elbow  | 6-8  | <b>Blast Gates</b>  |   |      |    | Diverter Valve Manual                  | 19   |   | Bleed-In Valve                          | 22   |
|    | Elbows Long Radius        | 8-10 |   | Blast Gate Manual                                     | 16   |   | Diverter Valve Automatic               | 19   |  | Butterfly Valve                         | 22   |
|  | Elbows Tubed              | 8    |  | Blast Gate NFMS                                       | 16   |  | SD Diverter Valve - Manual & Automatic | 19   |  | Viewing Spool                           | 23   |
|  | Elbow Tubed Long Radius   | 9    |  | Blast Gate Automatic NFES                             | 16   | <b>Hangers &amp; Installation</b>   |  |      |  | Sliding Access Panel                    | 22   |
| <b>Branches</b>   |                           |      |  | Blast Gate Automatic SD                               | 16   |  | Gripple Hanger                         | 20   |  | Floor Sweep                             | 23   |
|  | Branch                    | 11   | <b>Hoses &amp; Clamps</b>   |   |      |  | Strut Hanger                           | 20   |  | Drop Out Box                            | 23   |
|  | Y-Branch                  | 11   |  | Rubber Hose, Black & Clear                            | 17   |  | Pipe Hanger                            | 20   |  | Vibration Isolator                      | 23   |
|  | Double Branch             | 12   |  | Static Dissipative Urethane Hose                      | 17   |  | Pipe Hanger HJ                         | 20   |  | In-line Spark Trap 2.0                  | 23   |
|  | Tee Branch                | 12   |  | Hose Clamp  | 17   |  | Clamp Hanger                           | 20   | <b>Special Applications</b>   |   |      |
|  | In-Cut                    | 13   |  | Bridge Clamp (Hose)                                   | 17   |  | Wall Flashing & Roof Flashing          | 21   |  | QFS Molded Gasket / QFS O-Ring          | 24   |
|  | Tap-In                    | 13   |  | Rigid Flex Steel & Ultra Flex Steel Hose & Assemblies | 17   |  | Roof Skirt                             | 21   |  | Oil Mist Recycler / Drain Back for Hose | 24   |



**Quick-Fit® Clamp with Pin**

| Ø<br>in | QF Clamps with Nitrile Seals |           | QF Clamps with Silicone Seals |           | QF Clamps with ePTFE Seals |            |
|---------|------------------------------|-----------|-------------------------------|-----------|----------------------------|------------|
|         | Galv.                        | 304SS     | Galv.                         | 304SS ◊   | Galv.                      | 304SS      |
| 3       | \$14.20 #                    | \$30.40 # | \$17.70 #                     | \$38.10 # | \$29.60 #                  | \$45.00 #  |
| 4       | \$15.20 #                    | \$30.40 # | \$19.20 #                     | \$38.10 # | \$29.60 #                  | \$45.00 #  |
| 5       | \$16.30 #                    | \$32.60 # | \$20.30 #                     | \$40.80 # | \$31.70 #                  | \$50.20 #  |
| 6       | \$16.90 #                    | \$34.70 # | \$21.10 #                     | \$43.40 # | \$33.90 #                  | \$52.50 #  |
| 7       | \$17.70 #                    | \$36.70 # | \$22.10 #                     | \$45.90 # | \$40.40 #                  | \$57.10 #  |
| 8       | \$18.30 #                    | \$39.00 # | \$23.00 #                     | \$48.90 # | \$42.60 #                  | \$65.50 #  |
| 9       | \$18.90 #                    | \$40.80 # | \$23.70 #                     | \$51.00 # | \$45.00 #                  | \$66.80 #  |
| 10      | \$20.50 #                    | \$42.90 # | \$25.70 #                     | \$53.70 # | \$49.40 #                  | \$70.30 #  |
| 11      | \$22.20 #                    | \$47.60 # | \$27.80 #                     | \$59.50 # | \$57.20 #                  | \$98.80 #  |
| 12      | \$22.20 #                    | \$47.60 # | \$27.80 #                     | \$59.50 # | \$57.20 #                  | \$98.80 #  |
| 13      | \$24.20 #                    | \$53.80 # | \$30.40 #                     | \$67.30 # | \$61.50 #                  | \$101.40 # |
| 14      | \$24.20 #                    | \$53.80 # | \$30.40 #                     | \$67.30 # | \$61.50 #                  | \$101.40 # |
| 15      | \$26.80 #                    | \$60.50 # | \$33.50 #                     | \$75.80 # | \$65.70 #                  | \$104.50 # |
| 16      | \$26.80 #                    | \$60.50 # | \$33.50 #                     | \$75.80 # | \$65.70 #                  | \$104.50 # |
| 17      | \$27.80 #                    | \$62.70 # | \$34.80 #                     | \$78.30 # | \$69.40 #                  | \$107.30 # |
| 18      | \$27.80 #                    | \$62.70 # | \$34.80 #                     | \$78.30 # | \$69.40 #                  | \$107.30 # |
| 19      | \$29.00 #                    | \$64.70 # | \$36.30 #                     | \$81.30 # | \$74.40 #                  | \$110.60 # |
| 20      | \$29.00 #                    | \$64.70 # | \$36.30 #                     | \$81.30 # | \$74.40 #                  | \$110.60 # |
| 21      | \$30.40 #                    | \$66.80 # | \$38.10 #                     | \$83.60 # | \$78.00 #                  | \$113.50 # |
| 22      | \$30.40 #                    | \$66.80 # | \$38.10 #                     | \$83.60 # | \$78.00 #                  | \$113.50 # |
| 23      | \$35.00 #                    | \$77.00 # | \$43.90 #                     | \$96.10 # | \$89.70 #                  | \$130.50 # |
| 24      | \$35.00 #                    | \$77.00 # | \$43.90 #                     | \$96.10 # | \$89.70 #                  | \$130.50 # |

| Additional Bridge Pins |                 |                 |                 |
|------------------------|-----------------|-----------------|-----------------|
|                        | Galv            | 304SS           |                 |
| LARGE PINS             | \$0.70          | \$2.10          |                 |
| Additional Seals       |                 |                 |                 |
| Ø in                   | Nitrile         | Silicone        | ePTFE           |
| 3 - 6                  | \$0.30 per foot | \$1.30 per foot | \$2.10 per foot |
| 7 - 11                 | \$0.40 per foot | \$1.40 per foot | \$3.10 per foot |
| 12 - 24                | \$0.60 per foot | \$1.60 per foot | \$3.60 per foot |



**Pipe**

| Ø<br>in | Ends | Standard gauge |            | 18ga     | 18ga     | 16ga     | 16ga     | 14ga     |
|---------|------|----------------|------------|----------|----------|----------|----------|----------|
|         |      | Galv           | 304SS      | Galv     | 304SS    | Galv     | 304SS    | Galv     |
| 3       | QF   | \$45.00 #      | \$96.30 #  |          |          |          |          |          |
| 4       |      | \$45.00 #      | \$96.30 #  | \$58.20  |          |          |          |          |
| 5       |      | \$49.10 #      | \$106.10 # | \$64.00  |          |          |          |          |
| 6       |      | \$59.30 #      | \$123.10 # | \$77.00  |          |          |          |          |
| 7       |      | \$72.50 #      | \$153.90 # | \$94.30  |          |          |          |          |
| 8       |      | \$81.50 #      | \$164.10 # | \$106.10 | \$213.30 | \$114.30 | \$229.70 | \$146.60 |
| 9       |      | \$88.10 #      | \$186.90 # | \$114.80 | \$243.00 | \$123.40 | \$261.70 | \$158.70 |
| 10      |      | \$94.80 #      | \$204.40 # | \$123.40 | \$265.60 | \$133.30 | \$286.00 | \$170.60 |
| 11      |      | \$113.60 #     | \$243.60 # | \$147.90 | \$316.70 | \$159.10 | \$341.00 | \$204.60 |
| 12      |      | \$113.60 #     | \$243.60 # | \$147.90 | \$316.70 | \$159.10 | \$341.00 | \$204.60 |
| 13      |      | \$146.40 #     | \$310.10 # | \$190.50 | \$403.00 | \$205.00 | \$434.10 | \$263.50 |
| 14      |      | \$146.40 #     | \$310.10 # | \$190.50 | \$403.00 | \$205.00 | \$434.10 | \$263.50 |
| 15      |      | \$190.10 #     | \$380.90 # | \$247.00 | \$495.20 | \$266.00 | \$533.30 | \$342.00 |
| 16      |      | \$190.10 #     | \$380.90 # | \$247.00 | \$495.20 | \$266.00 | \$533.30 | \$342.00 |
| 17      |      | \$209.40 #     | \$456.60 # | \$272.40 | \$593.60 | \$293.30 | \$639.20 | \$377.30 |
| 18      |      | \$209.40 #     | \$456.60 # | \$272.40 | \$593.60 | \$293.30 | \$639.20 | \$377.30 |
| 19      |      | \$251.40 #     | \$546.90 # | \$327.10 | \$711.10 | \$351.50 | \$765.70 | \$452.40 |
| 20      |      | \$251.40 #     | \$546.90 # | \$327.10 | \$711.10 | \$351.50 | \$765.70 | \$452.40 |
| 21      |      | \$278.20 #     | \$609.70 # | \$361.50 | \$792.60 | \$389.50 | \$853.60 | \$500.50 |
| 22      |      | \$278.20 #     | \$609.70 # | \$361.50 | \$792.60 | \$389.50 | \$853.60 | \$500.50 |
| 23      |      | \$319.90 #     | \$701.10 # | \$416.00 | \$911.40 | \$448.20 | \$981.60 | \$575.90 |
| 24      |      | \$319.90 #     | \$701.10 # | \$416.00 | \$911.40 | \$448.20 | \$981.60 | \$575.90 |

#-Denotes an item that is returnable. See page 26 for a full listing of returnable items.

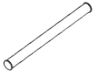

| Ø<br>in | Ends | Standard gauge |            | 18ga     | 18ga       | 16ga     | 16ga       | 14ga       | 12ga       | 10ga       |
|---------|------|----------------|------------|----------|------------|----------|------------|------------|------------|------------|
|         |      | Galv           | 304SS      | Galv     | 304SS      | Galv     | 304SS      | Galv       | Galv       | Galv       |
| 3       |      | \$70.60        | \$235.20   |          |            |          |            |            |            |            |
| 4       |      | \$95.20        | \$235.20   | \$88.30  |            |          |            |            |            |            |
| 5       |      | \$95.80        | \$281.50   | \$97.10  |            |          |            |            |            |            |
| 6       |      | \$105.20       | \$288.30   | \$118.30 |            |          |            |            |            |            |
| 7       |      | \$118.70       | \$337.90   | \$138.50 |            |          |            |            |            |            |
| 8       |      | \$132.00       | \$341.10   | \$160.80 | \$387.70   | \$168.90 | \$404.00   | \$160.00   |            |            |
| 9       |      | \$137.20       | \$342.30   | \$175.80 | \$417.60   | \$184.30 | \$436.30   | \$173.80   |            |            |
| 10      |      | \$158.50       | \$386.20   | \$195.90 | \$445.00   | \$205.80 | \$465.40   | \$187.70   | \$216.20   |            |
| 11      |      | \$184.60       | \$458.00   | \$242.80 | \$504.80   | \$254.00 | \$529.20   | \$221.40   | \$255.50   |            |
| 12      |      | \$184.60       | \$458.00   | \$242.80 | \$504.80   | \$254.00 | \$529.20   | \$235.60   | \$269.60   | \$303.80   |
| 13      |      | \$208.50       | \$516.10   | \$308.40 | \$601.80   | \$322.90 | \$632.70   | \$291.70   | \$335.80   | \$379.70   |
| 14      |      | \$208.50       | \$516.10   | \$308.40 | \$601.80   | \$322.90 | \$632.70   | \$296.40   | \$340.30   | \$384.30   |
| 15      |      | \$292.60       | \$590.50   | \$407.70 | \$734.10   | \$426.70 | \$772.20   | \$367.40   | \$424.60   | \$481.50   |
| 16      |      | \$292.60       | \$590.50   | \$407.70 | \$734.10   | \$426.70 | \$772.20   | \$406.60   | \$463.60   | \$520.80   |
| 17      |      | \$304.20       | \$820.40   | \$442.10 | \$908.10   | \$463.10 | \$953.80   | \$442.90   | \$505.70   | \$568.60   |
| 18      |      | \$304.20       | \$820.40   | \$442.10 | \$908.10   | \$463.10 | \$953.80   | \$447.10   | \$510.00   | \$572.90   |
| 20      |      | \$376.10       | \$821.30   | \$505.30 | \$1,052.00 | \$529.90 | \$1,106.70 | \$526.90   | \$602.30   | \$677.60   |
| 22      |      | \$410.80       | \$888.30   | \$560.20 | \$1,168.70 | \$588.30 | \$1,229.70 | \$577.70   | \$661.20   | \$744.60   |
| 24      |      | \$442.40       | \$1,022.50 | \$629.20 | \$1,352.10 | \$661.30 | \$1,422.30 | \$648.20   | \$744.10   | \$840.20   |
| 26      |      | \$471.90       | \$1,445.90 |          |            | \$471.90 | \$1,445.90 | \$650.00   | \$739.30   | \$828.50   |
| 28      |      | \$512.10       | \$1,456.00 |          |            | \$512.10 | \$1,456.00 | \$706.70   | \$803.90   | \$901.00   |
| 30      | AFL  | \$589.60       | \$1,590.30 |          |            | \$589.60 | \$1,590.30 | \$822.80   | \$939.00   | \$1,055.50 |
| 32      |      | \$614.60       | \$1,602.60 |          |            | \$614.60 | \$1,602.60 | \$856.70   | \$977.70   | \$1,098.80 |
| 34      |      | \$682.80       | \$1,611.10 |          |            | \$682.80 | \$1,611.10 | \$957.60   | \$1,095.40 | \$1,232.70 |
| 36      |      | \$729.30       | \$1,714.30 |          |            | \$729.30 | \$1,714.30 | \$1,024.40 | \$1,171.80 | \$1,319.40 |
| 38      |      | \$806.80       | \$1,891.40 |          |            | \$806.80 | \$1,891.40 | \$1,051.30 | \$1,199.30 | \$1,347.20 |
| 40      |      | \$931.20       | \$2,115.00 |          |            | \$931.20 | \$2,115.00 | \$1,103.30 | \$1,259.10 | \$1,414.50 |
| 42      |      |                |            |          |            |          |            | \$1,224.00 | \$1,399.80 | \$1,575.70 |
| 44      |      |                |            |          |            |          |            | \$1,282.10 | \$1,466.40 | \$1,650.60 |
| 46      |      |                |            |          |            |          |            | \$1,338.40 | \$1,530.90 | \$1,723.70 |
| 48      |      |                |            |          |            |          |            | \$1,397.10 | \$1,598.40 | \$1,799.20 |
| 50      |      |                |            |          |            |          |            | \$1,454.30 | \$1,663.60 | \$1,872.90 |
| 52      |      |                |            |          |            |          |            |            | \$1,730.80 | \$1,948.60 |
| 54      |      |                |            |          |            |          |            |            | \$1,796.10 | \$2,022.00 |
| 56      |      |                |            |          |            |          |            |            | \$1,861.60 | \$2,096.00 |
| 58      |      |                |            |          |            |          |            |            | \$1,927.00 | \$2,169.80 |
| 60      |      |                |            |          |            |          |            |            | \$1,992.60 | \$2,243.80 |
| 62      |      |                |            |          |            |          |            |            | \$2,058.20 | \$2,317.80 |
| 64      |      |                |            |          |            |          |            |            | \$2,124.20 | \$2,392.10 |
| 66      |      |                |            |          |            |          |            |            | \$2,190.00 | \$2,466.20 |
| 68      |      |                |            |          |            |          |            |            | \$2,255.80 | \$2,540.60 |
| 70      |      |                |            |          |            |          |            |            | \$2,321.70 | \$2,614.70 |
| 72      |      |                |            |          |            |          |            |            | \$2,387.30 | \$2,688.80 |



| Ø<br>in | Ends | Standard gauge |            | 18ga     |
|---------|------|----------------|------------|----------|
|         |      | Galv           | 304SS      | Galv     |
| 3       |      | \$26.00 #      | \$58.90 #  |          |
| 4       |      | \$26.00 #      | \$58.90 #  | \$33.80  |
| 5       |      | \$26.50 #      | \$60.70 #  | \$34.60  |
| 6       |      | \$27.30 #      | \$64.10 #  | \$35.20  |
| 7       |      | \$32.80 #      | \$75.30 #  | \$42.90  |
| 8       |      | \$33.40 #      | \$77.00 #  | \$43.30  |
| 9       |      | \$35.10 #      | \$79.70 #  | \$46.00  |
| 10      |      | \$35.90 #      | \$83.10 #  | \$46.50  |
| 11      |      | \$41.00 #      | \$95.40 #  | \$53.40  |
| 12      |      | \$41.00 #      | \$95.40 #  | \$53.40  |
| 13      | QF   | \$55.40        | \$129.90   | \$72.30  |
| 14      |      | \$55.40 #      | \$129.90 # | \$72.30  |
| 15      |      | \$63.70        | \$149.90   | \$82.90  |
| 16      |      | \$63.70 #      | \$149.90 # | \$82.90  |
| 17      |      | \$74.40        | \$171.90   | \$96.70  |
| 18      |      | \$74.40 #      | \$171.90 # | \$96.70  |
| 19      |      | \$91.10        | \$209.40   | \$118.40 |
| 20      |      | \$91.10 #      | \$209.40 # | \$118.40 |
| 21      |      | \$107.80       | \$247.00   | \$140.10 |
| 22      |      | \$107.80 #     | \$247.00 # | \$140.10 |
| 23      |      | \$124.00       | \$284.20   | \$161.20 |
| 24      |      | \$124.00 #     | \$284.20 # | \$161.20 |



| Ø<br>in | Ends | 16ga Galv | 14ga Galv |
|---------|------|-----------|-----------|
| 8       |      | \$186.00  | \$188.20  |
| 9       |      | \$202.80  | \$202.40  |
| 10      |      | \$224.10  | \$214.80  |
| 11      |      | \$271.40  | \$254.80  |
| 12      |      | \$271.40  | \$254.80  |
| 13      |      | \$352.00  | \$331.90  |
| 14      |      | \$352.00  | \$331.90  |
| 15      |      | \$459.90  | \$419.60  |
| 16      | QF   | \$459.90  | \$419.60  |
| 17      |      | \$502.20  | \$468.30  |
| 18      |      | \$502.20  | \$468.30  |
| 19      |      | \$578.10  | \$564.30  |
| 20      |      | \$578.10  | \$564.30  |
| 21      |      | \$644.40  | \$633.60  |
| 22      |      | \$644.40  | \$633.60  |
| 23      |      | \$726.30  | \$728.90  |
| 24      |      | \$726.30  | \$728.90  |



| Ø<br>in | Black Buna-N | Red Silicone |
|---------|--------------|--------------|
| 3       | \$3.40 #     | \$6.60 #     |
| 4       | \$3.40 #     | \$6.60 #     |
| 5       | \$3.40 #     | \$6.60 #     |
| 6       | \$3.40 #     | \$6.60 #     |
| 7       | \$5.20 #     | \$10.80 #    |
| 8       | \$5.20 #     | \$10.80 #    |
| 9       | \$5.20 #     | \$10.80 #    |
| 10      | \$5.20 #     | \$10.80 #    |
| 11      | \$5.20 #     | \$10.80 #    |
| 12      | \$5.20 #     | \$10.80 #    |
| 13      | \$8.30 #     | \$17.60 #    |
| 14      | \$8.30 #     | \$17.60 #    |
| 15      | \$8.30 #     | \$17.60 #    |
| 16      | \$8.30 #     | \$17.60 #    |
| 17      | \$8.30 #     | \$17.60 #    |
| 18      | \$8.30 #     | \$17.60 #    |
| 19      | \$8.30 #     | \$17.60 #    |
| 20      | \$8.30 #     | \$17.60 #    |
| 21      | \$8.30 #     | \$17.60 #    |
| 22      | \$8.30 #     | \$17.60 #    |
| 23      | \$8.30 #     | \$17.60 #    |
| 24      | \$8.30 #     | \$17.60 #    |

#-Denotes an item that is returnable. See page 26 for a full listing of returnable items.





Angle Flange

| Ø in | Standard gauge |          | Ø in | Standard gauge |          |
|------|----------------|----------|------|----------------|----------|
|      | Galv           | 304SS    |      | Galv           | 304SS    |
| 3    | \$14.30        | \$67.30  | 33   | \$193.40       | \$300.60 |
| 4    | \$14.30        | \$67.30  | 34   | \$193.40       | \$300.60 |
| 5    | \$15.90        | \$71.50  | 35   | \$199.40       | \$306.30 |
| 6    | \$19.80        | \$75.30  | 36   | \$199.40       | \$306.30 |
| 7    | \$21.10        | \$80.70  | 37   | \$202.40       | \$366.10 |
| 8    | \$26.10        | \$83.20  | 38   | \$202.40       | \$366.10 |
| 9    | \$29.10        | \$83.30  | 39   | \$216.80       | \$408.50 |
| 10   | \$34.60        | \$85.50  | 40   | \$216.80       | \$408.50 |
| 11   | \$45.20        | \$89.80  | 42   | \$223.00       |          |
| 12   | \$45.20        | \$89.80  | 44   | \$234.70       |          |
| 13   | \$56.30        | \$94.80  | 46   | \$245.40       |          |
| 14   | \$56.30        | \$94.80  | 48   | \$256.20       |          |
| 15   | \$76.70        | \$114.00 | 50   | \$266.50       |          |
| 16   | \$76.70        | \$114.00 | 52   | \$277.90       |          |
| 17   | \$81.00        | \$150.00 | 54   | \$287.30       |          |
| 18   | \$81.00        | \$150.00 | 56   | \$298.20       |          |
| 19   | \$85.00        | \$162.60 | 58   | \$310.40       |          |
| 20   | \$85.00        | \$162.60 | 60   | \$320.50       |          |
| 21   | \$94.80        | \$179.40 | 62   | \$323.40       |          |
| 22   | \$94.80        | \$179.40 | 64   | \$332.40       |          |
| 23   | \$101.70       | \$210.20 | 66   | \$342.20       |          |
| 24   | \$101.70       | \$210.20 | 68   | \$351.90       |          |
| 25   | \$141.60       | \$281.60 | 70   | \$361.70       |          |
| 26   | \$141.60       | \$281.60 | 72   | \$371.40       |          |
| 27   | \$155.90       | \$286.10 |      |                |          |
| 28   | \$155.90       | \$286.10 |      |                |          |
| 29   | \$170.60       | \$290.70 |      |                |          |
| 30   | \$170.60       | \$290.70 |      |                |          |
| 31   | \$179.10       | \$296.80 |      |                |          |
| 32   | \$179.10       | \$296.80 |      |                |          |

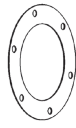

Angle Flange Gasket

| Ø in | Nitrile  |          | Silicone |          | Ø in     | Nitrile  |          | Silicone |          |
|------|----------|----------|----------|----------|----------|----------|----------|----------|----------|
|      | 3*       | \$4.30   | \$6.60   | 33**     |          | \$183.80 | \$276.10 | 34**     | \$188.80 |
| 4    | \$5.90   | \$9.00   | 35**     | \$193.30 | \$290.00 |          |          |          |          |
| 5*   | \$7.30   | \$11.10  | 36**     | \$198.30 | \$297.30 |          |          |          |          |
| 6    | \$9.20   | \$13.70  | 37**     | \$202.80 | \$304.30 |          |          |          |          |
| 7*   | \$13.10  | \$19.90  | 38**     | \$207.50 | \$311.40 |          |          |          |          |
| 8    | \$14.30  | \$21.30  | 39**     | \$212.20 | \$318.20 |          |          |          |          |
| 9*   | \$15.70  | \$23.70  | 40**     | \$217.00 | \$325.50 |          |          |          |          |
| 10   | \$22.50  | \$33.70  | 42**     | \$221.70 | \$343.60 |          |          |          |          |
| 11*  | \$24.30  | \$36.80  | 44**     | \$226.50 | \$352.00 |          |          |          |          |
| 12   | \$26.00  | \$39.00  | • 46**   | \$231.30 | \$360.50 |          |          |          |          |
| 13*  | \$30.70  | \$46.20  | • 48**   | \$236.00 | \$368.80 |          |          |          |          |
| 14*  | \$32.40  | \$48.50  |          |          |          |          |          |          |          |
| 15*  | \$45.20  | \$68.00  |          |          |          |          |          |          |          |
| 16*  | \$47.60  | \$71.40  |          |          |          |          |          |          |          |
| 17*  | \$50.20  | \$75.30  |          |          |          |          |          |          |          |
| 18*  | \$54.10  | \$81.10  |          |          |          |          |          |          |          |
| 19*  | \$56.40  | \$84.60  |          |          |          |          |          |          |          |
| 20*  | \$58.60  | \$88.00  |          |          |          |          |          |          |          |
| 21** | \$89.40  | \$134.30 |          |          |          |          |          |          |          |
| 22*  | \$93.20  | \$139.60 |          |          |          |          |          |          |          |
| 23** | \$96.70  | \$145.10 |          |          |          |          |          |          |          |
| 24*  | \$103.50 | \$155.20 |          |          |          |          |          |          |          |
| 25** | \$107.00 | \$160.70 |          |          |          |          |          |          |          |
| 26** | \$114.00 | \$171.00 |          |          |          |          |          |          |          |
| 27** | \$117.70 | \$176.40 |          |          |          |          |          |          |          |
| 28** | \$126.00 | \$189.00 |          |          |          |          |          |          |          |
| 29** | \$126.00 | \$189.00 |          |          |          |          |          |          |          |
| 30** | \$128.10 | \$192.30 |          |          |          |          |          |          |          |
| 31** | \$131.70 | \$197.60 |          |          |          |          |          |          |          |
| 32** | \$179.10 | \$269.00 |          |          |          |          |          |          |          |

\* Silicone Flange 5 - 7 days lead time  
 \*\* Both Nitrile and Silicone are 5 - 7 days lead time.  
 • Parts will be 4-piece segmented due to size.



Angle Flange Adapter

| Ø in | Ends      | Standard gauge |          | 14ga Galv |
|------|-----------|----------------|----------|-----------|
|      |           | Galv           | 304SS    |           |
| 3    |           | \$68.00 #      | \$120.40 |           |
| 4    |           | \$68.00 #      | \$120.40 |           |
| 5    |           | \$71.50 #      | \$133.90 |           |
| 6    |           | \$85.50 #      | \$149.80 |           |
| 7    |           | \$92.40 #      | \$160.90 |           |
| 8    |           | \$96.20 #      | \$169.10 | \$138.50  |
| 9    |           | \$107.80       | \$173.20 | \$155.10  |
| 10   |           | \$113.60       | \$180.20 | \$162.90  |
| 11   |           | \$125.80       | \$188.80 | \$180.70  |
| 12   |           | \$125.80       | \$188.80 | \$178.00  |
| 13   | QF to AFL | \$131.30       | \$204.10 | \$185.10  |
| 14   |           | \$131.30       | \$204.10 | \$184.30  |
| 15   |           | \$142.70       | \$220.70 | \$201.40  |
| 16   |           | \$142.70       | \$220.70 | \$193.30  |
| 17   |           | \$154.80       | \$274.70 | \$210.30  |
| 18   |           | \$154.80       | \$274.70 | \$209.40  |
| 19   |           | \$164.60       | \$292.80 | \$221.90  |
| 20   |           | \$164.60       | \$292.80 | \$221.90  |
| 21   |           | \$176.20       | \$314.70 | \$237.40  |
| 22   |           | \$176.20       | \$314.70 | \$237.40  |
| 23   |           | \$202.50       | \$362.10 | \$276.30  |
| 24   |           | \$202.50       | \$362.10 | \$276.30  |



Elbow

| Ø in | Ends | 90 Degree  |            |            |            | Ø in       | Ends | Standard gauge |            |            |            |
|------|------|------------|------------|------------|------------|------------|------|----------------|------------|------------|------------|
|      |      | Galv       | 304SS      | 16ga Galv  | 16ga 304SS |            |      | Galv           | 304SS      | 14ga Galv  | 12ga Galv  |
| 3    |      | \$65.80    | TUBED      |            |            | 3          |      | \$98.20        | TUBED      |            |            |
| 4    |      | \$81.30 #  | TUBED      |            |            | 4          |      | \$116.70       | TUBED      |            |            |
| 5    |      | \$90.00 #  | TUBED      |            |            | 5          |      | \$129.50       | TUBED      |            |            |
| 6    |      | \$101.30 # | TUBED      |            |            | 6          |      | \$155.90       | TUBED      |            |            |
| 7    |      | \$135.20 # | \$421.50   | \$266.50   | \$573.40   | 7          |      | \$187.70       | \$620.20   |            |            |
| 8    |      | \$197.00 # | \$457.10   | \$310.70   | \$668.20   | \$315.00   | 8    |                | \$263.30   | \$662.70   | \$344.90   |
| 9    |      | \$204.50   | \$476.20   | \$323.10   | \$694.70   | \$327.30   | 9    |                | \$277.80   | \$683.50   | \$360.10   |
| 10   |      | \$212.80 # | \$480.00   | \$329.30   | \$708.40   | \$340.30   | 10   |                | \$298.70   | \$692.40   | \$376.50   |
| 11   |      | \$270.30   | \$604.90   | \$389.40   | \$836.90   | \$432.50   | 11   |                | \$383.00   | \$832.30   | \$472.00   |
| 12   |      | \$270.30 # | \$604.90   | \$389.40   | \$836.90   | \$432.50   | 12   |                | \$383.00   | \$832.30   | \$486.10   |
| 13   |      | \$287.00   | \$642.70   | \$433.00   | \$931.50   | \$459.20   | 13   |                | \$423.90   | \$882.80   | \$516.90   |
| 14   |      | \$287.00   | \$642.70   | \$433.00   | \$931.50   | \$459.20   | 14   |                | \$423.90   | \$882.80   | \$521.30   |
| 15   |      | \$294.60   | \$676.70   | \$649.60   | \$1,396.60 | \$471.40   | 15   |                | \$477.50   | \$961.00   | \$534.80   |
| 16   |      | \$294.60   | \$676.70   | \$649.60   | \$1,396.60 | \$471.40   | 16   |                | \$477.50   | \$961.00   | \$573.70   |
| 17   |      | \$414.20   | \$927.70   | \$709.20   | \$1,525.30 | \$662.50   | 17   |                | \$611.80   | \$1,303.50 | \$770.30   |
| 18   | QF   | \$414.20   | \$927.70   | \$709.20   | \$1,525.30 | \$662.50   | 18   | AFL            | \$611.80   | \$1,303.50 | \$774.40   |
| 20   |      | \$483.20   | \$1,082.80 | \$1,016.90 | \$2,186.60 | \$773.10   | 20   |                | \$693.20   | \$1,493.80 | \$897.50   |
| 22   |      | \$621.70   | \$1,396.50 | \$1,104.60 | \$2,375.00 | \$994.60   | 22   |                | \$859.00   | \$1,857.80 | \$1,127.20 |
| 24   |      | \$714.70   | \$1,605.90 | \$1,270.20 | \$2,731.30 | \$1,143.60 | 24   |                | \$987.70   | \$2,136.40 | \$1,280.00 |
| 26   |      |            |            |            |            |            | 26   |                | \$1,144.40 | \$2,282.90 | \$1,726.00 |
| 28   |      |            |            |            |            |            | 28   |                | \$1,405.70 | \$2,749.00 | \$2,136.30 |
| 30   |      |            |            |            |            |            | 30   |                | \$1,441.70 | \$2,844.70 | \$2,185.70 |
| 32   |      |            |            |            |            |            | 32   |                | \$1,814.70 | \$2,939.20 | \$2,776.80 |
| 34   |      |            |            |            |            |            | 34   |                | \$2,069.50 | \$3,499.90 | \$3,176.60 |
| 36   |      |            |            |            |            |            | 36   |                | \$2,357.00 | \$4,289.00 | \$3,628.70 |
| 38   |      |            |            |            |            |            | 38   |                | \$2,689.20 | \$5,170.90 | \$3,923.90 |
| 40   |      |            |            |            |            |            | 40   |                | \$3,249.60 | \$6,430.50 | \$4,224.00 |
| 42   |      |            |            |            |            |            | 42   |                |            |            | \$4,561.80 |
| 44   |      |            |            |            |            |            | 44   |                |            |            | \$4,733.00 |
| 46   |      |            |            |            |            |            | 46   |                |            |            | \$4,946.20 |
| 48   |      |            |            |            |            |            | 48   |                |            |            | \$5,161.70 |
| 50   |      |            |            |            |            |            | 50   |                |            |            | \$5,375.50 |

#-Denotes an item that is returnable. See page 26 for a full listing of returnable items.



**Elbow**

| Ø in      | 60 Degree  |            |           |            |           | Ø in | Ends | Standard gauge |            | 14ga Galv  | 12ga Galv  |
|-----------|------------|------------|-----------|------------|-----------|------|------|----------------|------------|------------|------------|
|           | Galv       | 304SS      | 16ga Galv | 16ga 304SS | 14ga Galv |      |      | Galv           | 304SS      |            |            |
| 3         | \$65.80    | TUBED      |           |            |           | 3    |      | \$98.20        | TUBED      |            |            |
| 4         | \$81.30 #  | TUBED      |           |            |           | 4    |      | \$116.70       | TUBED      |            |            |
| 5         | \$84.40 #  | TUBED      |           |            |           | 5    |      | \$123.20       | TUBED      |            |            |
| 6         | \$108.40 # | TUBED      |           |            |           | 6    |      | \$155.90       | TUBED      |            |            |
| 7         | \$135.20 # | \$314.00   | \$191.40  | \$411.20   |           | 7    |      | \$187.70       | \$508.00   |            |            |
| 8         | \$167.80   | \$369.70   | \$204.10  | \$438.80   | \$268.20  | 8    |      | \$232.60       | \$571.70   | \$297.80   |            |
| 9         | \$172.10   | \$385.30   | \$241.80  | \$519.60   | \$275.60  | 9    |      | \$244.00       | \$588.50   | \$308.50   |            |
| 10        | \$192.40   | \$412.20   | \$269.90  | \$580.50   | \$308.00  | 10   |      | \$278.10       | \$621.70   | \$344.10   | \$401.80   |
| 11        | \$209.70   | \$450.50   | \$295.00  | \$634.10   | \$335.40  | 11   |      | \$319.50       | \$670.80   | \$374.80   | \$437.80   |
| 12        | \$209.70   | \$450.50   | \$295.00  | \$634.10   | \$335.40  | 12   |      | \$319.50       | \$670.80   | \$389.10   | \$452.00   |
| 13        | \$240.00   | \$522.50   | \$335.70  | \$722.00   | \$383.90  | 13   |      | \$374.70       | \$756.70   | \$441.70   | \$513.80   |
| 14        | \$240.00   | \$522.50   | \$335.70  | \$722.00   | \$383.90  | 14   |      | \$374.70       | \$756.70   | \$446.20   | \$518.10   |
| 15        | \$280.30   | \$604.90   | \$395.60  | \$850.50   | \$448.50  | 15   |      | \$462.40       | \$886.60   | \$511.80   | \$595.80   |
| 16        | \$280.30   | \$604.90   | \$395.60  | \$850.50   | \$448.50  | 16   |      | \$462.40       | \$886.60   | \$550.90   | \$635.10   |
| 17        | \$317.60   | \$694.50   | \$442.50  | \$951.20   | \$508.20  | 17   |      | \$510.60       | \$1,060.70 | \$615.90   | \$711.10   |
| 18        | \$317.60   | \$694.50   | \$442.50  | \$951.20   | \$508.20  | 18   |      | \$510.60       | \$1,060.70 | \$620.10   | \$715.10   |
| 20        | \$408.90   | \$874.10   | \$565.10  | \$1,214.90 | \$654.30  | 20   | AFL  | \$615.60       | \$1,276.20 | \$778.80   | \$901.20   |
| 22        | \$483.20   | \$1,039.60 | \$659.20  | \$1,417.40 | \$773.10  | 22   |      | \$714.40       | \$1,486.00 | \$905.80   | \$1,050.80 |
| 24        | \$555.60   | \$1,195.40 | \$757.90  | \$1,629.80 | \$889.20  | 24   |      | \$821.30       | \$1,708.70 | \$1,025.30 | \$1,192.00 |
| 26        |            |            |           |            |           | 26   |      | \$879.10       | \$1,740.20 | \$1,302.10 | \$1,513.50 |
| 28        |            |            |           |            |           | 28   |      | \$997.10       | \$1,973.00 | \$1,482.80 | \$1,725.50 |
| 30        |            |            |           |            |           | 30   |      | \$1,160.60     | \$2,296.70 | \$1,736.20 | \$2,023.80 |
| 32        |            |            |           |            |           | 32   |      | \$1,421.90     | \$2,814.00 | \$2,148.60 | \$2,511.70 |
| 34        |            |            |           |            |           | 34   |      | \$1,770.20     | \$3,007.80 | \$2,697.50 | \$3,161.30 |
| 36        |            |            |           |            |           | 36   |      | \$2,167.50     | \$3,124.80 | \$3,120.10 | \$3,660.50 |
| 38        |            |            |           |            |           | 38   |      | \$2,651.20     | \$4,405.70 | \$3,374.50 | \$3,958.20 |
| 40        |            |            |           |            |           | 40   |      | \$3,064.80     | \$6,064.50 | \$3,631.60 | \$4,261.10 |
| 42        |            |            |           |            |           | 42   |      |                |            | \$3,883.10 | \$4,557.70 |
| 44        |            |            |           |            |           | 44   |      |                |            | \$4,068.00 | \$4,774.40 |
| 46        |            |            |           |            |           | 46   |      |                |            | \$4,250.70 | \$4,989.50 |
| 48        |            |            |           |            |           | 48   |      |                |            | \$4,436.40 | \$5,207.00 |
| 50        |            |            |           |            |           | 50   |      |                |            | \$4,619.80 | \$5,422.70 |
| 45 Degree |            |            |           |            |           |      |      |                |            |            |            |
| 3         | \$59.40    | TUBED      |           |            |           | 3    |      | \$67.20        | TUBED      |            |            |
| 4         | \$69.30 #  | TUBED      |           |            |           | 4    |      | \$104.50       | TUBED      |            |            |
| 5         | \$76.70 #  | TUBED      |           |            |           | 5    |      | \$115.30       | TUBED      |            |            |
| 6         | \$91.10 #  | TUBED      |           |            |           | 6    |      | \$138.70       | TUBED      |            |            |
| 7         | \$128.40 # | \$273.00   | \$182.10  | \$391.40   |           | 7    |      | \$180.80       | \$465.70   |            |            |
| 8         | \$138.70   | \$280.00   | \$197.50  | \$425.00   | \$221.90  | 8    |      | \$202.40       | \$478.10   | \$251.70   |            |
| 9         | \$141.30   | \$291.30   | \$204.10  | \$438.80   | \$226.30  | 9    |      | \$211.50       | \$490.60   | \$259.10   |            |
| 10        | \$147.30   | \$308.90   | \$210.30  | \$451.90   | \$235.70  | 10   |      | \$230.80       | \$513.90   | \$271.80   | \$316.20   |
| 11        | \$155.60   | \$335.90   | \$220.00  | \$472.60   | \$248.80  | 11   |      | \$262.90       | \$551.30   | \$288.30   | \$335.00   |
| 12        | \$155.60   | \$335.90   | \$220.00  | \$472.60   | \$248.80  | 12   |      | \$262.90       | \$551.30   | \$302.50   | \$349.20   |
| 13        | \$167.80   | \$359.80   | \$238.40  | \$512.60   | \$268.20  | 13   |      | \$298.70       | \$587.30   | \$325.90   | \$376.40   |
| 14        | \$167.80   | \$359.80   | \$238.40  | \$512.60   | \$268.20  | 14   |      | \$298.70       | \$587.30   | \$330.50   | \$380.60   |
| 15        | \$224.90   | \$485.20   | \$310.70  | \$668.20   | \$359.80  | 15   |      | \$404.40       | \$761.40   | \$423.00   | \$490.40   |
| 16        | \$224.90   | \$485.20   | \$310.70  | \$668.20   | \$359.80  | 16   |      | \$404.40       | \$761.40   | \$462.30   | \$529.60   |
| 17        | \$258.70   | \$562.40   | \$364.00  | \$782.60   | \$414.10  | 17   |      | \$449.20       | \$922.70   | \$521.60   | \$599.20   |
| 18        | \$258.70   | \$562.40   | \$364.00  | \$782.60   | \$414.10  | 18   |      | \$449.20       | \$922.70   | \$525.90   | \$603.50   |
| 20        | \$309.10   | \$665.60   | \$423.70  | \$911.20   | \$494.90  | 20   | AFL  | \$511.90       | \$1,058.60 | \$619.20   | \$712.10   |
| 22        | \$354.80   | \$761.90   | \$480.10  | \$1,032.60 | \$567.80  | 22   |      | \$580.50       | \$1,196.10 | \$700.40   | \$807.00   |
| 24        | \$408.20   | \$876.10   | \$552.40  | \$1,187.30 | \$653.10  | 24   |      | \$667.40       | \$1,375.80 | \$789.10   | \$911.70   |
| 26        |            |            |           |            |           | 26   |      | \$804.30       | \$1,591.30 | \$1,182.00 | \$1,370.90 |
| 28        |            |            |           |            |           | 28   |      | \$992.20       | \$1,960.10 | \$1,474.90 | \$1,716.10 |
| 30        |            |            |           |            |           | 30   |      | \$1,062.50     | \$2,102.50 | \$1,579.40 | \$1,837.70 |
| 32        |            |            |           |            |           | 32   |      | \$1,176.80     | \$2,329.20 | \$1,756.20 | \$2,045.80 |
| 34        |            |            |           |            |           | 34   |      | \$1,261.70     | \$2,497.20 | \$1,884.00 | \$2,194.80 |
| 36        |            |            |           |            |           | 36   |      | \$1,399.20     | \$2,772.30 | \$2,096.00 | \$2,444.40 |
| 38        |            |            |           |            |           | 38   |      | \$1,552.90     | \$3,072.80 | \$2,276.00 | \$2,653.60 |
| 40        |            |            |           |            |           | 40   |      | \$1,725.90     | \$3,416.10 | \$2,446.20 | \$2,853.80 |
| 42        |            |            |           |            |           | 42   |      |                |            | \$2,613.70 | \$3,050.10 |
| 44        |            |            |           |            |           | 44   |      |                |            | \$2,737.90 | \$3,195.00 |
| 46        |            |            |           |            |           | 46   |      |                |            | \$2,860.40 | \$3,338.40 |
| 48        |            |            |           |            |           | 48   |      |                |            | \$2,985.50 | \$3,484.10 |
| 50        |            |            |           |            |           | 50   |      |                |            | \$3,108.40 | \$3,628.00 |

#-Denotes an item that is returnable. See page 26 for a full listing of returnable items.



**Elbow**

| Ø in | Ends | 30 Degree      |          |           |            |           |      |      |                |            |            |            |
|------|------|----------------|----------|-----------|------------|-----------|------|------|----------------|------------|------------|------------|
|      |      | Standard gauge |          | 16ga Galv | 16ga 304SS | 14ga Galv | Ø in | Ends | Standard gauge |            | 14ga Galv  | 12ga Galv  |
|      |      | Galv           | 304SS    |           |            |           |      |      | Galv           | 304SS      |            |            |
| 3    |      | \$59.40        | TUBED    |           |            |           | 3    |      | \$104.50       | TUBED      |            |            |
| 4    |      | \$69.30 #      | TUBED    |           |            |           | 4    |      | \$104.50       | TUBED      |            |            |
| 5    |      | \$76.70 #      | TUBED    |           |            |           | 5    |      | \$115.30       | TUBED      |            |            |
| 6    |      | \$94.50 #      | TUBED    |           |            |           | 6    |      | \$142.40       | TUBED      |            |            |
| 7    |      | \$128.40 #     | \$232.80 | \$175.80  | \$377.90   |           | 7    |      | \$180.80       | \$423.30   |            |            |
| 8    |      | \$130.50       | \$246.60 | \$185.30  | \$398.20   | \$208.80  | 8    |      | \$193.80       | \$443.30   | \$238.70   |            |
| 9    |      | \$135.20       | \$253.20 | \$191.40  | \$411.20   | \$216.20  | 9    |      | \$205.10       | \$451.00   | \$249.10   |            |
| 10   |      | \$141.30       | \$258.70 | \$197.50  | \$425.00   | \$226.30  | 10   |      | \$224.30       | \$461.20   | \$262.50   | \$304.70   |
| 11   |      | \$144.40       | \$271.80 | \$204.10  | \$438.80   | \$231.00  | 11   |      | \$251.30       | \$484.60   | \$270.50   | \$313.70   |
| 12   |      | \$144.40       | \$271.80 | \$204.10  | \$438.80   | \$231.00  | 12   |      | \$251.30       | \$484.60   | \$284.60   | \$327.90   |
| 13   |      | \$159.40       | \$276.00 | \$222.70  | \$479.10   | \$255.10  | 13   |      | \$291.10       | \$499.60   | \$312.90   | \$360.60   |
| 14   |      | \$159.40       | \$276.00 | \$222.70  | \$479.10   | \$255.10  | 14   |      | \$291.10       | \$499.60   | \$317.30   | \$365.30   |
| 15   |      | \$178.00       | \$368.80 | \$251.00  | \$540.00   | \$284.70  | 15   |      | \$355.80       | \$639.90   | \$348.00   | \$401.60   |
| 16   |      | \$178.00       | \$368.80 | \$251.00  | \$540.00   | \$284.70  | 16   |      | \$355.80       | \$639.90   | \$387.30   | \$440.80   |
| 17   |      | \$193.40       | \$420.90 | \$273.00  | \$587.10   | \$309.30  | 17   |      | \$381.60       | \$774.80   | \$417.00   | \$475.00   |
| 18   |      | \$193.40       | \$420.90 | \$273.00  | \$587.10   | \$309.30  | 18   |      | \$381.60       | \$774.80   | \$421.30   | \$479.20   |
| 20   | QF   | \$226.30       | \$489.60 | \$298.20  | \$641.00   | \$362.10  | 20   | AFL  | \$425.20       | \$875.20   | \$486.70   | \$554.70   |
| 22   |      | \$258.70       | \$557.80 | \$364.00  | \$782.60   | \$414.10  | 22   |      | \$480.00       | \$982.90   | \$546.70   | \$624.10   |
| 24   |      | \$297.40       | \$641.80 | \$418.60  | \$900.30   | \$476.10  | 24   |      | \$552.00       | \$1,130.40 | \$612.20   | \$701.50   |
| 26   |      |                |          |           |            |           | 26   |      | \$716.30       | \$1,416.70 | \$1,041.20 | \$1,203.50 |
| 28   |      |                |          |           |            |           | 28   |      | \$786.20       | \$1,552.50 | \$1,145.00 | \$1,324.40 |
| 30   |      |                |          |           |            |           | 30   |      | \$879.10       | \$1,740.20 | \$1,286.10 | \$1,489.30 |
| 32   |      |                |          |           |            |           | 32   |      | \$916.90       | \$1,811.20 | \$1,340.60 | \$1,552.20 |
| 34   |      |                |          |           |            |           | 34   |      | \$1,059.40     | \$2,096.00 | \$1,560.30 | \$1,810.50 |
| 36   |      |                |          |           |            |           | 36   |      | \$1,163.60     | \$2,303.10 | \$1,719.40 | \$1,997.10 |
| 38   |      |                |          |           |            |           | 38   |      | \$1,280.00     | \$2,529.70 | \$1,873.30 | \$2,175.40 |
| 40   |      |                |          |           |            |           | 40   |      | \$1,407.50     | \$2,781.90 | \$2,011.60 | \$2,337.50 |
| 42   |      |                |          |           |            |           | 42   |      |                |            | \$2,148.30 | \$2,497.30 |
| 44   |      |                |          |           |            |           | 44   |      |                |            | \$2,250.30 | \$2,616.10 |
| 46   |      |                |          |           |            |           | 46   |      |                |            | \$2,350.70 | \$2,733.00 |
| 48   |      |                |          |           |            |           | 48   |      |                |            | \$2,453.20 | \$2,852.50 |
| 50   |      |                |          |           |            |           | 50   |      |                |            | \$2,554.40 | \$2,970.00 |



**Elbow Long Radius**

| Ø in | Ends | 90 Degree      |            |            |      |                |            |            |            |  |  |
|------|------|----------------|------------|------------|------|----------------|------------|------------|------------|--|--|
|      |      | Standard gauge |            | 14ga Galv  | Ends | Standard gauge |            | 14ga Galv  | 12ga Galv  |  |  |
|      |      | Galv           | 304SS      |            |      | Galv           | 304SS      |            |            |  |  |
| 3    |      | \$65.80        | TUBED      |            |      | \$98.20        |            |            |            |  |  |
| 4    |      | \$87.60 #      | TUBED      |            |      | \$123.20       |            |            |            |  |  |
| 5    |      | \$98.20 #      | TUBED      |            |      | \$137.70       |            |            |            |  |  |
| 6    |      | \$107.60 #     | TUBED      |            |      | \$155.90       |            |            |            |  |  |
| 7    |      | \$144.40 #     | \$493.00   |            |      | \$187.70       |            |            |            |  |  |
| 8    |      | \$255.10       | \$548.90   | \$408.20   |      | \$327.30       | \$758.70   | \$437.80   |            |  |  |
| 9    |      | \$265.50       | \$571.60   | \$424.60   |      | \$341.10       | \$783.00   | \$457.50   |            |  |  |
| 10   |      | \$270.30       | \$580.10   | \$432.50   |      | \$358.80       | \$796.90   | \$468.50   | \$549.60   |  |  |
| 11   |      | \$319.50       | \$681.20   | \$511.20   |      | \$433.90       | \$911.40   | \$550.60   | \$646.50   |  |  |
| 12   |      | \$319.50       | \$681.20   | \$511.20   |      | \$433.90       | \$911.40   | \$564.90   | \$660.70   |  |  |
| 13   |      | \$354.80       | \$759.20   | \$567.80   |      | \$494.30       | \$1,004.10 | \$625.40   | \$732.00   |  |  |
| 14   |      | \$354.80       | \$759.20   | \$567.80   |      | \$494.30       | \$1,004.10 | \$630.00   | \$736.50   |  |  |
| 15   |      | \$554.10       | \$1,192.10 | \$886.60   |      | \$748.20       | \$1,498.80 | \$949.90   | \$1,116.20 |  |  |
| 16   |      | \$554.10       | \$1,192.10 | \$886.60   |      | \$748.20       | \$1,498.80 | \$989.20   | \$1,155.30 |  |  |
| 17   |      | \$604.90       | \$1,302.20 | \$968.10   |      | \$810.70       | \$1,694.40 | \$1,075.80 | \$1,257.10 |  |  |
| 18   |      | \$604.90       | \$1,302.20 | \$968.10   |      | \$810.70       | \$1,694.40 | \$1,079.90 | \$1,261.40 |  |  |
| 20   | QF   | \$1,003.50     | \$1,400.40 | \$1,605.60 | AFL  | \$1,236.20     | \$1,825.30 | \$1,730.20 | \$2,031.10 |  |  |
| 22   |      | \$1,022.10     | \$1,770.20 | \$1,635.40 |      | \$1,276.70     | \$2,248.40 | \$1,768.40 | \$2,074.90 |  |  |
| 24   |      | \$1,175.90     | \$2,035.90 | \$1,881.10 |      | \$1,468.10     | \$2,585.30 | \$2,017.20 | \$2,369.90 |  |  |
| 26   |      |                |            |            |      | \$1,430.30     | \$2,854.20 | \$2,183.60 | \$2,560.50 |  |  |
| 28   |      |                |            |            |      | \$1,757.10     | \$3,436.30 | \$2,698.50 | \$3,169.30 |  |  |
| 30   |      |                |            |            |      | \$1,802.10     | \$3,555.60 | \$2,762.50 | \$3,242.70 |  |  |
| 32   |      |                |            |            |      | \$2,268.10     | \$3,674.20 | \$3,502.20 | \$4,119.10 |  |  |
| 34   |      |                |            |            |      | \$2,586.90     | \$4,374.90 | \$4,004.30 | \$4,713.00 |  |  |
| 36   |      |                |            |            |      | \$2,946.10     | \$5,361.50 | \$4,571.10 | \$5,383.60 |  |  |
| 38   |      |                |            |            |      | \$3,361.00     | \$6,558.10 | \$5,220.40 | \$6,150.00 |  |  |
| 40   |      |                |            |            |      | \$4,062.00     | \$8,038.00 | \$5,819.20 | \$6,859.20 |  |  |
| 42   |      |                |            |            |      |                |            | \$6,347.80 | \$7,484.50 |  |  |
| 44   |      |                |            |            |      |                |            | \$6,650.20 | \$7,840.70 |  |  |
| 46   |      |                |            |            |      |                |            | \$6,950.50 | \$8,195.10 |  |  |
| 48   |      |                |            |            |      |                |            | \$7,253.10 | \$8,552.10 |  |  |
| 50   |      |                |            |            |      |                |            | \$7,554.00 | \$8,907.10 |  |  |



**Elbow Tubed**

| Ø in             | Ends | 90 Degree      |          |
|------------------|------|----------------|----------|
|                  |      | Standard gauge |          |
|                  |      | Galv           | 304SS    |
| 3                |      | \$98.90        | \$157.20 |
| 4                |      | \$125.10       | \$161.50 |
| 5                | QF   | \$187.90       | \$325.50 |
| 6                |      | \$252.20       | \$397.30 |
| 8 ♦              |      | \$496.60       | \$753.00 |
| <b>60 Degree</b> |      |                |          |
| 3                |      | \$98.90        | \$157.20 |
| 4                |      | \$125.10       | \$161.50 |
| 5                | QF   | \$187.90       | \$325.50 |
| 6                |      | \$252.20       | \$397.30 |
| 8 ♦              |      | \$496.60       | \$753.00 |
| <b>45 Degree</b> |      |                |          |
| 3                |      | \$98.90        | \$157.20 |
| 4                |      | \$125.10       | \$161.50 |
| 5                | QF   | \$187.90       | \$325.50 |
| 6                |      | \$252.20       | \$397.30 |
| 8 ♦              |      | \$496.60       | \$753.00 |
| <b>30 Degree</b> |      |                |          |
| 3                |      | \$98.90        | \$157.20 |
| 4                |      | \$125.10       | \$161.50 |
| 5                | QF   | \$187.90       | \$325.50 |
| 6                |      | \$252.20       | \$397.30 |
| 8 ♦              |      | \$496.60       | \$753.00 |

♦ Items may take longer than standard lead times.

#-Denotes an item that is returnable. See page 26 for a full listing of returnable items.





**Elbow Long Radius**

| 60 Degree |      |                |            |            |      |                |            |            |            |
|-----------|------|----------------|------------|------------|------|----------------|------------|------------|------------|
| Ø in      | Ends | Standard gauge |            | 14ga Galv  | Ends | Standard gauge |            | 14ga Galv  | 12ga Galv  |
|           |      | Galv           | 304SS      |            |      | Galv           | 304SS      |            |            |
| 3         |      | \$65.80        | TUBED      |            |      | \$98.20        |            |            |            |
| 4         |      | \$87.60        | TUBED      |            |      | \$123.20       |            |            |            |
| 5         |      | \$98.20        | TUBED      |            |      | \$137.70       |            |            |            |
| 6         |      | \$107.60       | TUBED      |            |      | \$155.90       |            |            |            |
| 7         |      | \$141.80       | \$439.10   |            |      | \$187.70       |            |            |            |
| 8         |      | \$199.00       | \$456.00   | \$318.40   |      | \$265.50       | \$660.10   | \$347.90   |            |
| 9         |      | \$211.50       | \$472.70   | \$338.50   |      | \$285.10       | \$680.30   | \$371.30   |            |
| 10        |      | \$236.50       | \$505.40   | \$378.20   |      | \$323.40       | \$719.30   | \$414.30   | \$485.20   |
| 11        |      | \$257.10       | \$553.20   | \$411.30   |      | \$368.90       | \$777.80   | \$451.00   | \$528.10   |
| 12        |      | \$257.10       | \$553.20   | \$411.30   |      | \$368.90       | \$777.80   | \$465.00   | \$542.20   |
| 13        |      | \$294.50       | \$640.90   | \$471.00   |      | \$431.90       | \$880.80   | \$528.80   | \$617.10   |
| 14        |      | \$294.50       | \$640.90   | \$471.00   |      | \$431.90       | \$880.80   | \$533.40   | \$621.80   |
| 15        |      | \$344.40       | \$742.80   | \$550.90   |      | \$529.20       | \$1,029.70 | \$614.30   | \$717.60   |
| 16        |      | \$344.40       | \$742.80   | \$550.90   |      | \$529.20       | \$1,029.70 | \$653.40   | \$756.60   |
| 17        |      | \$389.70       | \$852.70   | \$623.60   |      | \$586.20       | \$1,225.30 | \$731.30   | \$848.40   |
| 18        |      | \$389.70       | \$852.70   | \$623.60   |      | \$586.20       | \$1,225.30 | \$735.50   | \$852.30   |
| 20        | QF   | \$502.20       | \$1,072.50 | \$803.30   | AFL  | \$712.80       | \$1,483.20 | \$927.80   | \$1,078.50 |
| 22        |      | \$593.10       | \$1,275.70 | \$948.90   |      | \$829.10       | \$1,732.40 | \$1,081.60 | \$1,259.40 |
| 24        |      | \$682.10       | \$1,467.10 | \$1,091.40 |      | \$953.00       | \$1,991.90 | \$1,227.70 | \$1,432.20 |
| 26        |      |                |            |            |      | \$1,099.20     | \$2,175.60 | \$1,653.70 | \$1,931.30 |
| 28        |      |                |            |            |      | \$1,246.40     | \$2,466.10 | \$1,881.40 | \$2,199.00 |
| 30        |      |                |            |            |      | \$1,450.50     | \$2,870.50 | \$2,200.10 | \$2,575.20 |
| 32        |      |                |            |            |      | \$1,777.60     | \$3,517.50 | \$2,717.30 | \$3,187.20 |
| 34        |      |                |            |            |      | \$2,213.00     | \$3,759.60 | \$3,406.00 | \$4,002.60 |
| 36        |      |                |            |            |      | \$2,709.60     | \$3,906.10 | \$3,921.10 | \$4,611.90 |
| 38        |      |                |            |            |      | \$3,314.00     | \$6,463.30 | \$4,476.60 | \$5,267.00 |
| 40        |      |                |            |            |      | \$3,830.80     | \$7,580.70 | \$4,987.50 | \$5,871.20 |
| 42        |      |                |            |            |      |                |            | \$5,438.70 | \$6,404.70 |
| 44        |      |                |            |            |      |                |            | \$5,697.50 | \$6,709.30 |
| 46        |      |                |            |            |      |                |            | \$5,954.40 | \$7,012.50 |
| 48        |      |                |            |            |      |                |            | \$6,213.90 | \$7,318.00 |
| 50        |      |                |            |            |      |                |            | \$6,471.50 | \$7,621.60 |

| 45 Degree |      |                |            |            |      |                |            |            |            |
|-----------|------|----------------|------------|------------|------|----------------|------------|------------|------------|
| Ø in      | Ends | Standard gauge |            | 14ga Galv  | Ends | Standard gauge |            | 14ga Galv  | 12ga Galv  |
|           |      | Galv           | 304SS      |            |      | Galv           | 304SS      |            |            |
| 3         |      | \$59.40        | TUBED      |            |      | \$67.20        |            |            |            |
| 4         |      | \$87.60        | TUBED      |            |      | \$123.20       |            |            |            |
| 5         |      | \$98.20        | TUBED      |            |      | \$137.70       |            |            |            |
| 6         |      | \$107.60       | TUBED      |            |      | \$155.90       |            |            |            |
| 7         |      | \$178.40       | \$385.30   |            |      | \$180.80       |            |            |            |
| 8         |      | \$199.00       | \$429.10   | \$318.40   |      | \$265.50       | \$662.20   | \$347.90   |            |
| 9         |      | \$211.50       | \$472.70   | \$338.50   |      | \$285.10       | \$680.30   | \$371.30   |            |
| 10        |      | \$236.50       | \$505.40   | \$378.20   |      | \$323.40       | \$719.30   | \$414.30   | \$485.20   |
| 11        |      | \$257.10       | \$553.20   | \$411.30   |      | \$368.90       | \$777.80   | \$451.00   | \$528.10   |
| 12        |      | \$257.10       | \$553.20   | \$411.30   |      | \$368.90       | \$777.80   | \$465.00   | \$542.20   |
| 13        |      | \$294.50       | \$640.90   | \$471.00   |      | \$431.90       | \$880.50   | \$528.80   | \$617.10   |
| 14        |      | \$294.50       | \$640.90   | \$471.00   |      | \$431.90       | \$880.50   | \$533.40   | \$621.80   |
| 15        |      | \$344.40       | \$742.80   | \$550.90   |      | \$529.20       | \$1,029.70 | \$614.30   | \$717.60   |
| 16        |      | \$344.40       | \$742.80   | \$550.90   |      | \$529.20       | \$1,029.70 | \$653.40   | \$756.60   |
| 17        |      | \$389.70       | \$852.70   | \$623.60   |      | \$586.20       | \$1,225.30 | \$731.30   | \$848.40   |
| 18        |      | \$389.70       | \$852.70   | \$623.60   |      | \$586.20       | \$1,225.30 | \$735.50   | \$852.30   |
| 20        | QF   | \$502.20       | \$1,072.50 | \$803.30   | AFL  | \$712.80       | \$1,483.20 | \$927.80   | \$1,078.50 |
| 22        |      | \$593.10       | \$1,275.70 | \$948.90   |      | \$829.10       | \$1,732.40 | \$1,081.60 | \$1,259.40 |
| 24        |      | \$682.10       | \$1,467.10 | \$1,091.40 |      | \$953.00       | \$1,991.90 | \$1,227.70 | \$1,432.20 |
| 26        |      |                |            |            |      | \$1,005.60     | \$1,989.50 | \$1,503.80 | \$1,752.90 |
| 28        |      |                |            |            |      | \$1,240.50     | \$2,450.40 | \$1,871.90 | \$2,187.40 |
| 30        |      |                |            |            |      | \$1,328.00     | \$2,628.10 | \$2,004.10 | \$2,342.20 |
| 32        |      |                |            |            |      | \$1,471.20     | \$2,911.10 | \$2,227.40 | \$2,605.50 |
| 34        |      |                |            |            |      | \$1,577.30     | \$3,121.40 | \$2,389.00 | \$2,794.70 |
| 36        |      |                |            |            |      | \$1,748.90     | \$3,465.40 | \$2,621.10 | \$3,068.00 |
| 38        |      |                |            |            |      | \$1,941.00     | \$3,841.40 | \$2,989.20 | \$3,500.40 |
| 40        |      |                |            |            |      | \$2,157.40     | \$4,270.10 | \$3,323.70 | \$3,895.60 |
| 42        |      |                |            |            |      |                |            | \$3,620.00 | \$4,245.20 |
| 44        |      |                |            |            |      |                |            | \$3,792.50 | \$4,511.10 |
| 46        |      |                |            |            |      |                |            | \$3,962.80 | \$4,647.20 |
| 48        |      |                |            |            |      |                |            | \$4,135.60 | \$4,849.90 |
| 50        |      |                |            |            |      |                |            | \$4,306.60 | \$5,050.90 |



**Elbow Tubed Long Radius**

| 90 Degree |      |                |            |
|-----------|------|----------------|------------|
| Ø in      | Ends | Standard gauge |            |
|           |      | Galv           | 304SS      |
| 3         |      | \$107.60       | \$220.10   |
| 4         |      | \$137.20       | \$293.20   |
| 5         | QF   | \$205.60       | \$500.60   |
| 6         |      | \$327.10       | \$602.70   |
| 8         | ◆    | \$520.20       | \$1,043.00 |
| 60 Degree |      |                |            |
| 3         |      | \$107.60       | \$220.10   |
| 4         |      | \$137.20       | \$293.20   |
| 5         | QF   | \$205.60       | \$500.60   |
| 6         |      | \$327.10       | \$602.70   |
| 8         | ◆    | \$520.20       | \$1,043.00 |
| 45 Degree |      |                |            |
| 3         |      | \$107.60       | \$220.10   |
| 4         |      | \$137.20       | \$220.10   |
| 5         | QF   | \$205.60       | \$375.80   |
| 6         |      | \$327.10       | \$451.90   |
| 8         | ◆    | \$520.20       | \$782.50   |
| 30 Degree |      |                |            |
| 3         |      | \$107.60       | \$220.10   |
| 4         |      | \$137.20       | \$220.10   |
| 5         | QF   | \$205.60       | \$375.80   |
| 6         |      | \$327.10       | \$451.90   |
| 8         | ◆    | \$520.20       | \$782.50   |

◆ Items may take longer than standard lead times.



Elbow Long Radius

| 30 Degree |      |                |          |           |      |                |            |            |            |
|-----------|------|----------------|----------|-----------|------|----------------|------------|------------|------------|
| Ø in      | Ends | Standard gauge |          | 14ga Galv | Ends | Standard gauge |            | 14ga Galv  | 12ga Galv  |
|           |      | Galv           | 304SS    |           |      | Galv           | 304SS      |            |            |
| 3         |      | \$64.40        | TUBED    |           |      | \$67.20        |            |            |            |
| 4         |      | \$87.60        | TUBED    |           |      | \$123.20       |            |            |            |
| 5         |      | \$98.20        | TUBED    |           |      | \$137.70       |            |            |            |
| 6         |      | \$107.60       | TUBED    |           |      | \$155.90       |            |            |            |
| 7         |      | \$133.80       | \$285.90 |           |      | \$180.80       |            |            |            |
| 8         |      | \$154.70       | \$298.10 | \$247.30  |      | \$219.20       | \$502.20   | \$276.90   |            |
| 9         |      | \$163.00       | \$310.70 | \$260.70  |      | \$234.00       | \$510.80   | \$293.40   |            |
| 10        |      | \$168.90       | \$317.30 | \$270.50  |      | \$253.20       | \$522.70   | \$306.50   | \$357.40   |
| 11        |      | \$181.20       | \$333.50 | \$289.90  |      | \$289.80       | \$548.90   | \$329.40   | \$383.90   |
| 12        |      | \$181.20       | \$333.50 | \$289.90  |      | \$289.80       | \$548.90   | \$343.70   | \$398.10   |
| 13        |      | \$193.40       | \$338.40 | \$309.30  |      | \$326.20       | \$565.00   | \$367.00   | \$425.00   |
| 14        |      | \$193.40       | \$338.40 | \$309.30  |      | \$326.20       | \$565.00   | \$371.50   | \$429.50   |
| 15        |      | \$212.00       | \$452.80 | \$338.90  |      | \$390.90       | \$727.40   | \$402.40   | \$466.10   |
| 16        |      | \$212.00       | \$452.80 | \$338.90  |      | \$390.90       | \$727.40   | \$441.50   | \$505.10   |
| 17        |      | \$237.50       | \$516.80 | \$379.90  |      | \$427.20       | \$874.80   | \$487.60   | \$558.90   |
| 18        |      | \$237.50       | \$516.80 | \$379.90  |      | \$427.20       | \$874.80   | \$491.80   | \$563.00   |
| 20        | QF   | \$278.20       | \$600.90 | \$445.10  | AFL  | \$478.90       | \$990.90   | \$569.50   | \$653.10   |
| 22        |      | \$316.90       | \$684.70 | \$507.10  |      | \$541.30       | \$1,115.40 | \$640.30   | \$735.20   |
| 24        |      | \$364.70       | \$787.20 | \$583.20  |      | \$622.60       | \$1,282.80 | \$719.40   | \$828.60   |
| 26        |      |                |          |           |      | \$894.90       | \$1,771.00 | \$1,327.20 | \$1,543.20 |
| 28        |      |                |          |           |      | \$982.70       | \$1,940.80 | \$1,459.60 | \$1,697.90 |
| 30        |      |                |          |           |      | \$1,099.20     | \$2,175.60 | \$1,637.90 | \$1,907.10 |
| 32        |      |                |          |           |      | \$1,146.20     | \$2,264.20 | \$1,707.20 | \$1,987.40 |
| 34        |      |                |          |           |      | \$1,324.10     | \$2,620.20 | \$1,983.80 | \$2,313.70 |
| 36        |      |                |          |           |      | \$1,454.70     | \$2,879.10 | \$2,144.20 | \$2,501.90 |
| 38        |      |                |          |           |      | \$1,599.70     | \$3,161.90 | \$2,443.70 | \$2,852.90 |
| 40        |      |                |          |           |      | \$1,759.30     | \$3,477.40 | \$2,713.40 | \$3,171.10 |
| 42        |      |                |          |           |      |                |            | \$2,953.50 | \$3,453.30 |
| 44        |      |                |          |           |      |                |            | \$3,093.70 | \$3,617.80 |
| 46        |      |                |          |           |      |                |            | \$3,232.50 | \$3,780.10 |
| 48        |      |                |          |           |      |                |            | \$3,373.60 | \$3,945.10 |
| 50        |      |                |          |           |      |                |            | \$3,512.90 | \$4,108.30 |

## Branch End Labels

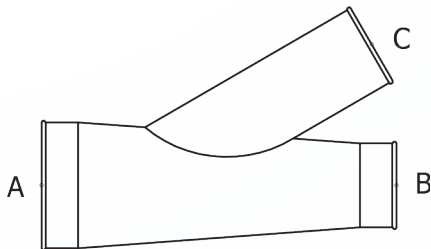

STD. BRANCH

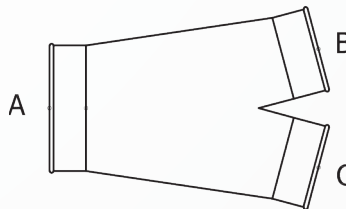

Y BRANCH

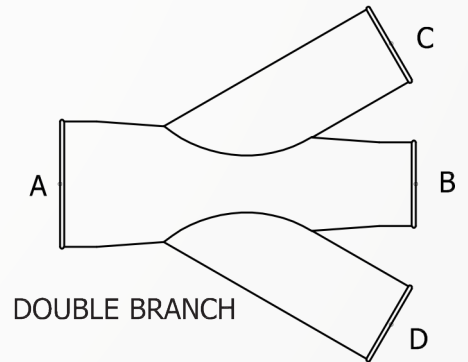

DOUBLE BRANCH

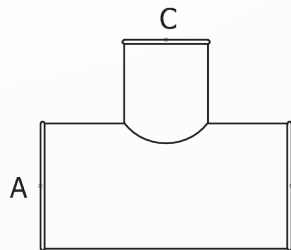

TEE BRANCH

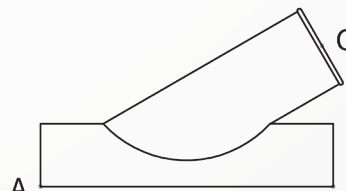

IN CUT

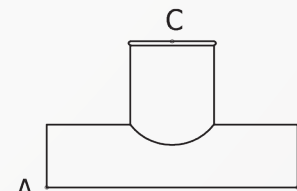

TAP IN



**Branch**

| Ø<br>in | Ends | 30° Standard   |            |              | 45° Optional  |            |            | Ends       | 14ga<br>Galv | 12ga<br>Galv |
|---------|------|----------------|------------|--------------|---|------------|------------|------------|--------------|--------------|
|         |      | Standard gauge |            | 14ga<br>Galv | Standard gauge  |            | Ends       |            |              |              |
|         |      | Galv           | 304SS      |              | Galv  | 304SS      |            |            |              |              |
| 3       |      | \$173.00       | \$359.80   |              |   | \$187.30   | \$427.10   |            |              |              |
| 4       |      | \$173.00       | \$359.80   |              |   | \$187.30   | \$427.10   |            |              |              |
| 5       |      | \$182.30       | \$367.00   |              |   | \$198.20   | \$438.50   |            |              |              |
| 6       |      | \$188.40       | \$374.90   |              |   | \$208.20   | \$450.20   |            |              |              |
| 7       |      | \$191.40       | \$383.00   |              |   | \$212.50   | \$463.70   |            |              |              |
| 8       |      | \$195.80       | \$393.50   | \$293.80     |   | \$221.90   | \$476.70   | \$336.20   |              |              |
| 9       |      | \$205.00       | \$408.90   | \$307.30     |   | \$234.10   | \$492.20   | \$354.40   |              |              |
| 10      |      | \$218.70       | \$435.10   | \$328.00     |   | \$253.30   | \$520.60   | \$379.50   | \$445.10     |              |
| 11      |      | \$243.00       | \$486.60   | \$364.50     |   | \$288.20   | \$576.40   | \$420.90   | \$493.70     |              |
| 12      |      | \$243.00       | \$486.60   | \$364.50     |   | \$288.20   | \$576.40   | \$441.20   | \$514.00     |              |
| 13      |      | \$285.00       | \$573.20   | \$427.80     |   | \$341.30   | \$668.00   | \$510.40   | \$595.80     |              |
| 14      |      | \$285.00       | \$573.20   | \$427.80     |   | \$341.30   | \$668.00   | \$516.80   | \$602.30     |              |
| 15      |      | \$328.10       | \$659.20   | \$492.10     |   | \$404.80   | \$773.20   | \$582.70   | \$681.20     |              |
| 16      |      | \$328.10       | \$659.20   | \$492.10     |   | \$404.80   | \$773.20   | \$638.70   | \$737.10     |              |
| 17      |      | \$357.00       | \$719.20   | \$535.30     |   | \$438.00   | \$869.20   | \$689.70   | \$796.60     |              |
| 18      |      | \$357.00       | \$719.20   | \$535.30     |   | \$438.00   | \$869.20   | \$695.60   | \$802.50     |              |
| 20      | QF   | \$429.70       | \$855.70   | \$644.50     | AFL<br>Cost shown is<br>for flanged A<br>end. Add cost<br>of flange(s)<br>if B and/or C<br>end(s) require<br>flanges. | \$514.70   | \$1,018.30 | \$822.80   | \$951.70     |              |
| 22      |      | \$540.40       | \$1,077.10 | \$810.70     |   | \$635.20   | \$1,256.50 | \$1,000.60 | \$1,162.70   |              |
| 24      |      | \$621.40       | \$1,238.50 | \$932.20     |   | \$723.10   | \$1,448.70 | \$1,127.00 | \$1,313.50   |              |
| 26      |      |                |            |              |   | \$686.30   | \$1,488.00 | \$1,154.40 | \$1,335.20   |              |
| 28      |      |                |            |              |   | \$877.50   | \$1,615.60 | \$1,450.80 | \$1,687.30   |              |
| 30      |      |                |            |              |   | \$986.80   | \$1,763.80 | \$1,624.20 | \$1,891.60   |              |
| 32      |      |                |            |              |   | \$1,105.10 | \$1,845.20 | \$1,808.80 | \$2,110.30   |              |
| 34      |      |                |            |              |   | \$1,229.80 | \$1,964.70 | \$2,005.30 | \$2,342.10   |              |
| 36      |      |                |            |              |   | \$1,354.30 | \$2,024.50 | \$2,201.60 | \$2,573.70   |              |
| 38      |      |                |            |              |   | \$1,490.70 | \$2,184.30 | \$2,423.60 | \$2,833.40   |              |
| 40      |      |                |            |              |   | \$1,636.60 | \$2,304.00 | \$2,604.70 | \$3,047.50   |              |
| 42      |      |                |            |              |   |            |            | \$2,711.40 | \$3,171.70   |              |
| 44      |      |                |            |              |   |            |            | \$2,840.20 | \$3,322.50   |              |
| 46      |      |                |            |              |   |            |            | \$2,966.60 | \$3,470.70   |              |
| 48      |      |                |            |              |   |            |            | \$3,096.30 | \$3,622.60   |              |
| 50      |      |                |            |              |   |            |            | \$3,223.70 | \$3,771.70   |              |

NOTE: See page 26 for returnable sizes



**Y Branch**

| Ø<br>in | Ends | 60° Standard   |            |              | 90° Optional  |            |            | Ends       | 14ga<br>Galv | 12ga<br>Galv |
|---------|------|----------------|------------|--------------|---|------------|------------|------------|--------------|--------------|
|         |      | Standard gauge |            | 14ga<br>Galv | Standard gauge  |            | Ends       |            |              |              |
|         |      | Galv           | 304SS      |              | Galv  | 304SS      |            |            |              |              |
| 3       |      | \$222.60       | \$460.60   |              |   | \$236.90   | \$527.90   |            |              |              |
| 4       |      | \$222.60       | \$460.60   |              |   | \$236.90   | \$527.90   |            |              |              |
| 5       |      | \$234.50       | \$466.70   |              |   | \$250.40   | \$538.20   |            |              |              |
| 6       |      | \$244.40       | \$487.00   |              |   | \$264.20   | \$562.30   |            |              |              |
| 7       |      | \$251.60       | \$503.60   |              |   | \$272.70   | \$584.30   |            |              |              |
| 8       |      | \$262.70       | \$523.00   | \$394.20     |   | \$288.80   | \$606.20   | \$436.70   |              |              |
| 9       |      | \$276.30       | \$548.70   | \$414.40     |   | \$305.40   | \$632.00   | \$461.20   |              |              |
| 10      |      | \$281.50       | \$564.50   | \$422.10     |   | \$316.10   | \$650.00   | \$473.90   | \$558.10     |              |
| 11      |      | \$323.30       | \$643.20   | \$484.90     |   | \$368.50   | \$733.00   | \$541.50   | \$638.40     |              |
| 12      |      | \$323.30       | \$643.20   | \$484.90     |   | \$368.50   | \$733.00   | \$561.60   | \$658.80     |              |
| 13      |      | \$389.20       | \$774.30   | \$583.70     |   | \$445.50   | \$869.10   | \$666.30   | \$783.00     |              |
| 14      |      | \$389.20       | \$774.30   | \$583.70     |   | \$445.50   | \$869.10   | \$672.80   | \$789.40     |              |
| 15      |      | \$432.90       | \$862.60   | \$649.40     |   | \$509.60   | \$976.60   | \$740.10   | \$869.80     |              |
| 16      |      | \$432.90       | \$862.60   | \$649.40     |   | \$509.60   | \$976.60   | \$795.90   | \$926.00     |              |
| 17      |      | \$480.90       | \$956.20   | \$721.20     |   | \$561.90   | \$1,106.20 | \$875.40   | \$1,019.70   |              |
| 18      |      | \$480.90       | \$956.20   | \$721.20     |   | \$561.90   | \$1,106.20 | \$881.50   | \$1,025.60   |              |
| 20      | QF   | \$572.10       | \$1,138.70 | \$858.10     | AFL<br>Cost shown is<br>for flanged A<br>end. Add cost<br>of flange(s)<br>if B and/or C<br>end(s) require<br>flanges. | \$657.10   | \$1,301.30 | \$1,036.50 | \$1,208.10   |              |
| 22      |      | \$657.20       | \$1,311.10 | \$985.80     |   | \$752.00   | \$1,490.50 | \$1,175.90 | \$1,372.90   |              |
| 24      |      | \$756.10       | \$1,507.70 | \$1,134.30   |   | \$857.80   | \$1,717.90 | \$1,329.00 | \$1,555.80   |              |
| 26      |      |                |            |              |   | \$869.20   | \$1,613.30 | \$1,428.70 | \$1,664.30   |              |
| 28      |      |                |            |              |   | \$998.70   | \$1,735.10 | \$1,632.50 | \$1,905.30   |              |
| 30      |      |                |            |              |   | \$1,098.00 | \$1,846.80 | \$1,791.00 | \$2,091.60   |              |
| 32      |      |                |            |              |   | \$1,209.30 | \$1,958.50 | \$1,964.70 | \$2,297.40   |              |
| 34      |      |                |            |              |   | \$1,332.90 | \$2,049.70 | \$2,160.10 | \$2,527.90   |              |
| 36      |      |                |            |              |   | \$1,459.60 | \$2,232.40 | \$2,359.20 | \$2,763.00   |              |
| 38      |      |                |            |              |   | \$1,611.40 | \$2,425.00 | \$2,582.30 | \$3,024.10   |              |
| 40      |      |                |            |              |   | \$1,772.20 | \$2,587.50 | \$2,794.60 | \$3,275.40   |              |
| 42      |      |                |            |              |   |            |            | \$2,936.60 | \$3,441.80   |              |
| 44      |      |                |            |              |   |            |            | \$3,076.10 | \$3,605.70   |              |
| 46      |      |                |            |              |   |            |            | \$3,213.10 | \$3,766.40   |              |
| 48      |      |                |            |              |   |            |            | \$3,353.60 | \$3,931.30   |              |
| 50      |      |                |            |              |   |            |            | \$3,491.50 | \$4,093.30   |              |



**Double Branch**

| Ø in | Ends | 30° Standard   |            |            | 45° Optional  |            |            | Ends       | 14ga Galv  | 12ga Galv  |
|------|------|----------------|------------|------------|---|------------|------------|------------|------------|------------|
|      |      | Standard gauge |            | 14ga Galv  | Standard gauge  |            | Ends       |            |            |            |
|      |      | Galv           | 304SS      |            | Galv  | 304SS      |            |            |            |            |
| 3    | QF   | \$221.50       | \$458.80   |            |   | \$235.80   | \$526.10   |            |            |            |
| 4    |      | \$221.50       | \$458.80   |            |   | \$235.80   | \$526.10   |            |            |            |
| 5    |      | \$233.40       | \$464.50   |            |   | \$249.30   | \$536.00   |            |            |            |
| 6    |      | \$243.40       | \$484.90   |            |   | \$263.20   | \$560.20   |            |            |            |
| 7    |      | \$250.40       | \$501.20   |            |   | \$271.50   | \$581.90   |            |            |            |
| 8    |      | \$261.70       | \$520.70   | \$392.30   | AFL<br>Cost shown is for flanged A end. Add cost of flange(s) if B, C, and/or D end(s) require flanges. | \$287.80   | \$603.90   |            | \$449.20   |            |
| 9    |      | \$274.70       | \$546.50   | \$412.20   |   | \$303.80   | \$629.80   |            | \$474.60   |            |
| 10   |      | \$280.30       | \$562.00   | \$420.40   |   | \$314.90   | \$647.50   |            | \$489.20   | \$573.30   |
| 11   |      | \$321.50       | \$640.60   | \$482.60   |   | \$366.70   | \$730.40   |            | \$557.80   | \$654.40   |
| 12   |      | \$321.50       | \$640.60   | \$482.60   |   | \$366.70   | \$730.40   |            | \$584.90   | \$681.50   |
| 13   |      | \$387.30       | \$771.00   | \$581.10   |   | \$443.60   | \$865.80   |            | \$691.00   | \$807.30   |
| 14   |      | \$387.30       | \$771.00   | \$581.10   |   | \$443.60   | \$865.80   |            | \$699.50   | \$815.90   |
| 15   |      | \$430.80       | \$858.90   | \$646.10   |   | \$507.50   | \$972.90   |            | \$767.00   | \$896.20   |
| 16   |      | \$430.80       | \$858.90   | \$646.10   |   | \$507.50   | \$972.90   |            | \$841.80   | \$971.00   |
| 17   |      | \$478.80       | \$952.10   | \$718.00   |   | \$559.80   | \$1,102.10 |            | \$923.70   | \$1,067.20 |
| 18   |      | \$478.80       | \$952.10   | \$718.00   |   | \$559.80   | \$1,102.10 |            | \$931.70   | \$1,075.20 |
| 20   |      | \$569.70       | \$1,133.50 | \$854.20   |   | \$654.70   | \$1,296.10 |            | \$1,092.00 | \$1,263.00 |
| 22   |      | \$654.30       | \$1,305.30 | \$981.40   |   | \$749.10   | \$1,484.70 |            | \$1,234.60 | \$1,430.90 |
| 24   |      | \$752.40       | \$1,501.40 | \$1,128.50 |   | \$854.10   | \$1,711.60 |            | \$1,388.30 | \$1,614.10 |
| 26   |      |                |            |            |   | \$865.00   | \$1,606.30 |            | \$1,505.50 | \$1,740.20 |
| 28   |      |                |            |            |   | \$994.10   | \$1,727.70 |            | \$1,715.50 | \$1,986.70 |
| 30   |      |                |            |            |   | \$1,092.80 | \$1,839.00 |            | \$1,879.30 | \$2,178.30 |
| 32   |      |                |            |            |   | \$1,203.80 | \$1,950.10 |            | \$2,057.50 | \$2,388.40 |
| 34   |      |                |            |            |   | \$1,327.20 | \$2,040.60 |            | \$2,258.60 | \$2,624.40 |
| 36   |      |                |            |            |   | \$1,453.10 | \$2,222.90 |            | \$2,463.00 | \$2,864.80 |
| 38   |      |                |            |            |   | \$1,603.90 | \$2,414.80 |            | \$2,629.00 | \$3,054.90 |
| 40   |      |                |            | \$1,764.00 |   | \$2,576.30 |            | \$2,762.50 | \$3,210.70 |            |
| 42   |      |                |            |            |   |            |            | \$2,899.10 | \$3,369.70 |            |
| 44   |      |                |            |            |   |            |            | \$3,037.10 | \$3,529.90 |            |
| 46   |      |                |            |            |   |            |            | \$3,171.00 | \$3,686.50 |            |
| 48   |      |                |            |            |   |            |            | \$3,310.10 | \$3,848.00 |            |
| 50   |      |                |            |            |   |            | \$3,445.70 | \$4,006.00 |            |            |



**Tee Branch**

| Ø in | Ends | Standard gauge |            |            | 14ga Galv   | Ends       | Standard gauge |            | Ends       | 14ga Galv  | 12ga Galv |
|------|------|----------------|------------|------------|---|------------|----------------|------------|------------|------------|-----------|
|      |      | Standard gauge |            | 14ga Galv  |   |            | Standard gauge |            |            |            |           |
|      |      | Galv           | 304SS      |            |   |            | Galv           | 304SS      |            |            |           |
| 3    | QF   | \$175.80       | \$364.50   |            |   | \$190.10   | \$431.80       |            |            |            |           |
| 4    |      | \$175.80       | \$364.50   |            |   | \$190.10   | \$431.80       |            |            |            |           |
| 5    |      | \$184.70       | \$371.50   |            |   | \$200.60   | \$443.00       |            |            |            |           |
| 6    |      | \$190.80       | \$379.90   |            |   | \$210.60   | \$455.20       |            |            |            |           |
| 7    |      | \$193.80       | \$388.20   |            |   | \$214.90   | \$468.90       |            |            |            |           |
| 8    |      | \$198.80       | \$399.20   | \$298.10   | AFL<br>Cost shown is for flanged A end. Add cost of flange(s) if B and/or C end(s) require flanges. | \$224.90   | \$482.40       |            | \$340.60   |            |           |
| 9    |      | \$207.60       | \$414.40   | \$311.50   |   | \$236.70   | \$497.70       |            | \$358.50   |            |           |
| 10   |      | \$221.50       | \$440.60   | \$332.20   |   | \$256.10   | \$526.10       |            | \$383.90   | \$450.30   |           |
| 11   |      | \$246.20       | \$493.10   | \$369.20   |   | \$291.40   | \$582.90       |            | \$425.80   | \$499.70   |           |
| 12   |      | \$246.20       | \$493.10   | \$369.20   |   | \$291.40   | \$582.90       |            | \$446.00   | \$519.90   |           |
| 13   |      | \$289.30       | \$581.50   | \$433.80   |   | \$345.60   | \$676.30       |            | \$516.50   | \$603.20   |           |
| 14   |      | \$289.30       | \$581.50   | \$433.80   |   | \$345.60   | \$676.30       |            | \$522.90   | \$609.60   |           |
| 15   |      | \$332.50       | \$667.80   | \$498.90   |   | \$409.20   | \$781.80       |            | \$589.40   | \$689.30   |           |
| 16   |      | \$332.50       | \$667.80   | \$498.90   |   | \$409.20   | \$781.80       |            | \$645.50   | \$745.20   |           |
| 17   |      | \$361.80       | \$728.70   | \$542.80   |   | \$442.80   | \$878.70       |            | \$696.80   | \$805.40   |           |
| 18   |      | \$361.80       | \$728.70   | \$542.80   |   | \$442.80   | \$878.70       |            | \$702.90   | \$811.50   |           |
| 20   |      | \$435.60       | \$866.30   | \$653.50   |   | \$520.60   | \$1,028.90     |            | \$831.90   | \$962.50   |           |
| 22   |      | \$547.80       | \$1,091.10 | \$821.90   |   | \$642.60   | \$1,270.50     |            | \$1,011.80 | \$1,176.20 |           |
| 24   |      | \$630.10       | \$1,254.80 | \$945.40   |   | \$731.80   | \$1,465.00     |            | \$1,140.10 | \$1,329.30 |           |
| 26   |      |                |            |            |   | \$695.90   | \$1,789.10     |            | \$1,168.70 | \$1,352.40 |           |
| 28   |      |                |            |            |   | \$889.70   | \$1,920.90     |            | \$1,469.10 | \$1,709.10 |           |
| 30   |      |                |            |            |   | \$1,000.50 | \$2,077.80     |            | \$1,644.80 | \$1,916.10 |           |
| 32   |      |                |            |            |   | \$1,120.60 | \$2,166.10     |            | \$1,832.10 | \$2,138.10 |           |
| 34   |      |                |            |            |   | \$1,246.70 | \$2,291.10     |            | \$2,031.00 | \$2,372.90 |           |
| 36   |      |                |            |            |   | \$1,373.10 | \$2,357.20     |            | \$2,229.80 | \$2,607.80 |           |
| 38   |      |                |            |            |   | \$1,511.50 | \$2,578.80     |            | \$2,454.80 | \$2,870.70 |           |
| 40   |      |                |            | \$1,659.70 |   | \$2,742.40 |                | \$2,685.00 | \$3,143.80 |            |           |
| 42   |      |                |            |            |   |            |                | \$2,762.60 | \$3,233.20 |            |           |
| 44   |      |                |            |            |   |            |                | \$2,893.90 | \$3,386.90 |            |           |
| 46   |      |                |            |            |   |            |                | \$3,022.50 | \$3,538.00 |            |           |
| 48   |      |                |            |            |   |            |                | \$3,154.80 | \$3,692.80 |            |           |
| 50   |      |                |            |            |   |            | \$3,284.60     | \$3,844.90 |            |            |           |



**In Cut**

| Ø<br>in | Ends | 30° Standard   45° Optional |          |              | Ends       | Standard gauge |            |            | 14ga<br>Galv | 12ga<br>Galv |
|---------|------|-----------------------------|----------|--------------|------------|----------------|------------|------------|--------------|--------------|
|         |      | Standard gauge              |          | 14ga<br>Galv |            | Standard gauge |            |            |              |              |
|         |      | Galv                        | 304SS    |              |            | Galv           | 304SS      |            |              |              |
| 3       | QF   | \$78.30                     | \$154.10 |              | \$92.60    | \$221.40       |            |            |              |              |
| 4       |      | \$78.30                     | \$154.10 |              | \$92.60    | \$221.40       |            |            |              |              |
| 5       |      | \$80.20                     | \$158.10 |              | \$96.10    | \$229.60       |            |            |              |              |
| 6       |      | \$86.10                     | \$167.40 |              | \$105.90   | \$242.70       |            |            |              |              |
| 7       |      | \$91.10                     | \$178.40 |              | \$112.20   | \$259.10       |            |            |              |              |
| 8       |      | \$95.40                     | \$186.90 | \$143.30     | \$121.50   | \$270.10       | \$157.40   |            |              |              |
| 9       |      | \$99.60                     | \$197.20 | \$149.40     | \$128.70   | \$280.50       | \$165.00   |            |              |              |
| 10      |      | \$107.80                    | \$210.50 | \$161.90     | \$142.40   | \$296.00       | \$179.00   | \$211.10   |              |              |
| 11      |      | \$116.00                    | \$225.20 | \$174.20     | \$161.20   | \$315.00       | \$193.10   | \$227.80   |              |              |
| 12      |      | \$116.00                    | \$225.20 | \$174.20     | \$161.20   | \$315.00       | \$199.80   | \$234.50   |              |              |
| 13      |      | \$131.30                    | \$257.50 | \$196.80     | \$187.60   | \$352.30       | \$224.30   | \$263.80   |              |              |
| 14      |      | \$131.30                    | \$257.50 | \$196.80     | \$187.60   | \$352.30       | \$226.50   | \$265.90   |              |              |
| 15      |      | \$148.10                    | \$288.90 | \$222.00     | \$224.80   | \$402.90       | \$252.20   | \$296.50   |              |              |
| 16      |      | \$148.10                    | \$288.90 | \$222.00     | \$224.80   | \$402.90       | \$270.80   | \$315.10   |              |              |
| 17      |      | \$164.30                    | \$322.40 | \$246.50     | \$245.30   | \$472.40       | \$298.00   | \$347.20   |              |              |
| 18      |      | \$164.30                    | \$322.40 | \$246.50     | \$245.30   | \$472.40       | \$300.00   | \$349.10   |              |              |
| 20      |      | \$261.20                    | \$385.50 | \$392.00     | \$346.20   | \$548.10       | \$451.50   | \$529.80   |              |              |
| 22      |      | \$359.30                    | \$840.20 | \$539.00     | \$454.10   | \$1,019.60     | \$602.30   | \$710.10   |              |              |
| 24      |      | \$413.50                    | \$966.20 | \$620.10     | \$515.20   | \$1,176.40     | \$685.20   | \$809.10   |              |              |
| 26      |      |                             |          |              | \$521.00   | \$1,405.30     | \$739.80   | \$893.60   |              |              |
| 28      |      |                             |          |              | \$569.70   | \$1,529.60     | \$809.40   | \$977.50   |              |              |
| 30      |      |                             |          |              | \$630.10   | \$1,654.40     | \$897.30   | \$1,083.60 |              |              |
| 32      |      |                             |          |              | \$691.00   | \$1,687.90     | \$986.40   | \$1,190.70 |              |              |
| 34      |      |                             |          |              | \$837.20   | \$1,746.20     | \$1,202.40 | \$1,450.20 |              |              |
| 36      |      |                             |          |              | \$923.00   | \$1,788.20     | \$1,327.80 | \$1,601.30 |              |              |
| 38      |      |                             |          | \$974.40     | \$1,975.40 | \$1,399.10     | \$1,687.50 |            |              |              |
| 40      |      |                             |          | \$1,025.20   | \$2,102.20 | \$1,472.80     | \$1,776.50 |            |              |              |
| 42      |      |                             |          |              |            | \$1,517.50     | \$1,793.90 |            |              |              |
| 44      |      |                             |          |              |            | \$1,589.80     | \$1,879.20 |            |              |              |
| 46      |      |                             |          |              |            | \$1,661.10     | \$1,963.80 |            |              |              |
| 48      |      |                             |          |              |            | \$1,733.70     | \$2,049.50 |            |              |              |
| 50      |      |                             |          |              |            | \$1,805.30     | \$2,134.10 |            |              |              |

AFL  
Cost  
shown is  
for flanged  
C end.



**Tap In**

| Ø<br>in | Ends | Standard gauge |          |              | Ends       | Standard gauge |            |            | 14ga<br>Galv | 12ga<br>Galv |
|---------|------|----------------|----------|--------------|------------|----------------|------------|------------|--------------|--------------|
|         |      | Standard gauge |          | 14ga<br>Galv |            | Standard gauge |            |            |              |              |
|         |      | Galv           | 304SS    |              |            | Galv           | 304SS      |            |              |              |
| 3       | QF   | \$78.30        | \$154.10 |              | \$92.60    | \$221.40       |            |            |              |              |
| 4       |      | \$78.30        | \$154.10 |              | \$92.60    | \$221.40       |            |            |              |              |
| 5       |      | \$80.20        | \$158.10 |              | \$96.10    | \$229.60       |            |            |              |              |
| 6       |      | \$86.10        | \$167.40 |              | \$105.90   | \$242.70       |            |            |              |              |
| 7       |      | \$91.10        | \$178.40 |              | \$112.20   | \$259.10       |            |            |              |              |
| 8       |      | \$95.40        | \$186.90 | \$143.30     | \$121.50   | \$270.10       | \$157.40   |            |              |              |
| 9       |      | \$99.60        | \$205.10 | \$149.40     | \$128.70   | \$280.50       | \$165.00   |            |              |              |
| 10      |      | \$107.80       | \$210.50 | \$161.90     | \$142.40   | \$296.00       | \$179.00   | \$211.10   |              |              |
| 11      |      | \$116.00       | \$225.20 | \$174.20     | \$161.20   | \$315.00       | \$193.10   | \$227.80   |              |              |
| 12      |      | \$116.00       | \$225.20 | \$174.20     | \$161.20   | \$315.00       | \$199.80   | \$234.50   |              |              |
| 13      |      | \$131.30       | \$257.50 | \$196.80     | \$187.60   | \$352.30       | \$224.30   | \$263.80   |              |              |
| 14      |      | \$131.30       | \$257.50 | \$196.80     | \$187.60   | \$352.30       | \$226.50   | \$265.90   |              |              |
| 15      |      | \$148.10       | \$288.90 | \$222.00     | \$224.80   | \$402.90       | \$252.20   | \$296.50   |              |              |
| 16      |      | \$148.10       | \$288.90 | \$222.00     | \$224.80   | \$402.90       | \$270.80   | \$315.10   |              |              |
| 17      |      | \$164.30       | \$322.40 | \$246.50     | \$245.30   | \$472.40       | \$298.00   | \$347.20   |              |              |
| 18      |      | \$164.30       | \$322.40 | \$246.50     | \$245.30   | \$472.40       | \$300.00   | \$349.10   |              |              |
| 20      |      | \$261.20       | \$385.50 | \$392.00     | \$346.20   | \$548.10       | \$451.50   | \$529.80   |              |              |
| 22      |      | \$359.30       | \$840.20 | \$539.00     | \$454.10   | \$1,019.60     | \$602.30   | \$710.10   |              |              |
| 24      |      | \$413.50       | \$966.20 | \$620.10     | \$515.20   | \$1,176.40     | \$685.20   | \$809.10   |              |              |
| 26      |      |                |          |              | \$521.00   | \$1,405.30     | \$739.80   | \$893.60   |              |              |
| 28      |      |                |          |              | \$569.70   | \$1,529.60     | \$809.40   | \$977.50   |              |              |
| 30      |      |                |          |              | \$630.10   | \$1,654.40     | \$897.30   | \$1,083.60 |              |              |
| 32      |      |                |          |              | \$691.00   | \$1,687.90     | \$986.40   | \$1,190.70 |              |              |
| 34      |      |                |          |              | \$837.20   | \$1,746.20     | \$1,202.40 | \$1,450.20 |              |              |
| 36      |      |                |          |              | \$923.00   | \$1,788.20     | \$1,327.80 | \$1,601.30 |              |              |
| 38      |      |                |          | \$974.40     | \$1,975.40 | \$1,399.10     | \$1,687.50 |            |              |              |
| 40      |      |                |          | \$1,025.20   | \$2,102.20 | \$1,472.80     | \$1,776.50 |            |              |              |
| 42      |      |                |          |              |            | \$1,517.50     | \$1,793.90 |            |              |              |
| 44      |      |                |          |              |            | \$1,589.80     | \$1,879.20 |            |              |              |
| 46      |      |                |          |              |            | \$1,661.10     | \$1,963.80 |            |              |              |
| 48      |      |                |          |              |            | \$1,733.70     | \$2,049.50 |            |              |              |
| 50      |      |                |          |              |            | \$1,805.30     | \$2,134.10 |            |              |              |

AFL  
Cost  
shown is  
for flanged  
C end.





**Reducer**

| Ø in | Ends | Standard gauge |          | 14ga Galv | Ends   | Standard gauge |            | Ends  | 14ga Galv | 12ga Galv |
|------|------|----------------|----------|-----------|--|----------------|------------|---|-----------|-----------|
|      |      | Galv           | 304SS    |           |  | Galv           | 304SS      |   |           |           |
| 3    | QF   | \$73.20        | \$137.20 |           | AFL<br>Cost shown is for flanged A end. Add cost of flange if B end requires flange. | \$87.50        | \$204.50   | AFL<br>cost of flanges on both ends is included |           |           |
| 4    |      | \$73.20        | \$137.20 |           |  | \$87.50        | \$204.50   |   |           |           |
| 5    |      | \$74.50        | \$137.90 |           |  | \$90.40        | \$209.40   |   |           |           |
| 6    |      | \$78.40        | \$150.20 |           |  | \$98.20        | \$225.50   |   |           |           |
| 7    |      | \$78.90        | \$152.20 |           |  | \$100.00       | \$232.90   |   |           |           |
| 8    |      | \$80.50        | \$153.40 | \$120.60  |  | \$106.60       | \$236.60   |   | \$147.70  |           |
| 9    |      | \$91.10        | \$175.80 | \$136.60  |  | \$120.20       | \$259.10   |   | \$166.40  |           |
| 10   |      | \$92.60        | \$177.20 | \$138.70  |  | \$127.20       | \$262.70   |   | \$171.90  | \$199.60  |
| 11   |      | \$109.10       | \$212.40 | \$163.70  |  | \$154.30       | \$302.20   |   | \$199.70  | \$232.60  |
| 12   |      | \$109.10       | \$212.40 | \$163.70  |  | \$154.30       | \$302.20   |   | \$208.30  | \$240.90  |
| 13   |      | \$130.00       | \$247.80 | \$195.10  |  | \$186.30       | \$342.60   |   | \$248.20  | \$287.40  |
| 14   |      | \$130.00       | \$247.80 | \$195.10  |  | \$186.30       | \$342.60   |   | \$252.30  | \$291.30  |
| 15   |      | \$179.40       | \$341.50 | \$269.20  |  | \$256.10       | \$455.50   |   | \$329.00  | \$382.90  |
| 16   |      | \$179.40       | \$341.50 | \$269.20  |  | \$256.10       | \$455.50   |   | \$348.30  | \$402.10  |
| 17   |      | \$187.10       | \$356.70 | \$280.90  |  | \$268.10       | \$506.70   |   | \$381.20  | \$437.20  |
| 18   |      | \$187.10       | \$356.70 | \$280.90  |  | \$268.10       | \$506.70   |   | \$385.60  | \$441.70  |
| 20   |      | \$198.90       | \$382.60 | \$298.50  |  | \$283.90       | \$545.20   |   | \$414.20  | \$473.90  |
| 22   |      | \$226.60       | \$433.40 | \$340.00  |  | \$321.40       | \$612.80   |   | \$465.80  | \$533.80  |
| 24   |      | \$249.70       | \$498.70 | \$374.40  |  | \$351.40       | \$708.90   |   | \$503.90  | \$578.60  |
| 26   |      |                |          |           |  | \$273.40       | \$645.70   |   | \$528.60  | \$585.50  |
| 28   |      |                |          |           |  | \$301.70       | \$684.10   |   | \$597.10  | \$660.70  |
| 30   |      |                |          |           |  | \$328.60       | \$742.00   |   | \$651.00  | \$720.90  |
| 32   |      |                |          |           |  | \$363.00       | \$809.30   |   | \$721.40  | \$800.30  |
| 34   |      |                |          |           |  | \$398.20       | \$896.00   |   | \$789.90  | \$877.20  |
| 36   |      |                |          |           |  | \$439.00       | \$990.20   |   | \$872.00  | \$969.80  |
| 38   |      |                |          | \$483.90  | \$1,088.50   | \$956.40       | \$1,064.30 |   |           |           |
| 40   |      |                |          | \$532.00  | \$1,200.40   | \$1,059.00     | \$1,179.40 |   |           |           |
| 42   |      |                |          |           |  | \$1,140.00     | \$1,270.80 |   |           |           |
| 44   |      |                |          |           |  | \$1,194.10     | \$1,331.20 |   |           |           |
| 46   |      |                |          |           |  | \$1,247.50     | \$1,391.00 |   |           |           |
| 48   |      |                |          |           |  | \$1,301.40     | \$1,451.10 |   |           |           |
| 50   |      |                |          |           |  | \$1,355.60     | \$1,511.50 |   |           |           |

NOTE: See page 26 for returnable sizes

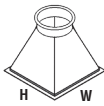

**Transition Rectangular to Round**

| SQ to SQ Size | SQ End     | Standard gauge |            | SQ End        | Standard gauge |            | Standard Metal Thickness |
|---------------|------------|----------------|------------|---------------|----------------|------------|--------------------------|
|               |            | Galv           | 304SS      |               | Galv           | 304SS      |                          |
| 16            | SQ End RAW | \$157.60       | \$319.80   | SQ End FLANGE | \$173.30       | \$404.20   | 22ga                     |
| 36            |            | \$173.70       | \$370.00   |               | \$194.90       | \$450.70   | 22ga                     |
| 64            |            | \$188.00       | \$395.70   |               | \$217.00       | \$479.10   | 22ga                     |
| 100           |            | \$198.30       | \$427.40   |               | \$243.50       | \$517.30   | 22ga                     |
| 144           |            | \$205.40       | \$444.60   |               | \$261.60       | \$539.40   | 22ga                     |
| 196           |            | \$215.50       | \$457.30   |               | \$292.10       | \$571.40   | 20ga                     |
| 256           |            | \$229.60       | \$494.80   |               | \$314.60       | \$657.50   | 20ga                     |
| 324           |            | \$274.60       | \$588.10   |               | \$369.30       | \$767.50   | 20ga                     |
| 400           |            | \$316.30       | \$676.30   |               | \$418.00       | \$886.50   | 18ga                     |
| 484           |            | \$494.30       | \$1,062.80 |               | \$635.80       | \$1,418.60 | 18ga                     |
| 576           |            | \$657.80       | \$1,414.10 |               | \$813.70       | \$1,799.10 | 18ga                     |
| 676           |            | \$832.40       | \$1,789.70 |               | \$1,003.10     | \$2,256.80 | 16ga                     |
| 784           |            | \$1,083.90     | \$2,330.40 |               | \$1,263.10     | \$2,841.80 | 16ga                     |
| 900           |            | \$1,266.10     | \$2,721.90 |               | \$1,462.10     | \$3,289.70 | 16ga                     |
| 1024          |            | \$1,329.80     | \$2,859.10 |               | \$1,525.80     | \$3,433.20 | 16ga                     |
| 1156          |            | \$1,425.20     | \$3,064.10 |               | \$1,637.40     | \$3,766.10 | 16ga                     |
| 1296          |            | \$1,535.20     | \$3,300.70 |               | \$1,763.70     | \$4,056.50 | 16ga                     |
| 1444          |            | \$2,176.90     | \$4,788.90 |               | \$2,421.50     | \$5,811.70 | 14ga                     |
| 1600          |            | \$2,183.20     | \$4,803.10 |               | \$2,444.10     | \$5,866.10 | 14ga                     |
| 1764          |            | \$2,201.00     | \$4,842.40 |               | \$2,478.20     | \$6,195.50 | 14ga                     |
| 1936          |            | \$2,224.60     | \$4,894.00 |               | \$2,517.80     | \$6,294.70 | 14ga                     |
| 2116          |            | \$2,253.70     | \$4,958.10 |               | \$2,563.20     | \$6,664.50 | 14ga                     |
| 2304          |            | \$2,288.40     | \$5,034.60 |               | \$2,624.30     | \$6,823.30 | 14ga                     |
| 2500          |            | \$2,904.70     | CALL       |               | \$3,246.80     | CALL       | 12ga                     |
| 2704          |            | \$2,945.90     | CALL       |               | \$3,304.20     | CALL       | 12ga                     |
| 2916          |            | \$2,995.50     | CALL       |               | \$3,369.90     | CALL       | 12ga                     |
| 3136          |            | \$3,077.80     | CALL       |               | \$3,468.50     | CALL       | 12ga                     |
| 3364          |            | \$3,201.10     | CALL       |               | \$3,608.20     | CALL       | 12ga                     |
| 3600          |            | \$3,363.20     | CALL       |               | \$3,761.90     | CALL       | 12ga                     |
| 3844          |            | \$4,450.70     | CALL       |               | \$4,606.80     | CALL       | 10ga                     |
| 4096          |            | \$4,563.40     | CALL       |               | \$4,701.80     | CALL       | 10ga                     |
| 4356          |            | \$4,679.10     | CALL       |               | \$4,800.00     | CALL       | 10ga                     |
| 4624          |            | \$4,797.70     | CALL       |               | \$4,901.00     | CALL       | 10ga                     |
| 4900          |            | \$4,919.20     | CALL       |               | \$5,004.90     | CALL       | 10ga                     |
| 5184          |            | \$5,363.20     | CALL       |               | \$5,431.30     | CALL       | 10ga                     |

\*  $H \times W = SQ$

If round end is flanged (AFL or FFL) and the size of the round end is 24" or less, the price of an angle flange in the appropriate diameter should be added.



**Machine Adapter**

| Ø in | Ends | Standard gauge |          | 14ga Galv |
|------|------|----------------|----------|-----------|
|      |      | Galv           | 304SS    |           |
| 3    |      | \$32.20 #      | \$59.30  |           |
| 4    |      | \$32.20 #      | \$59.30  |           |
| 5    |      | \$35.80 #      | \$68.30  |           |
| 6    |      | \$41.90 #      | \$81.60  |           |
| 7    |      | \$44.90 #      | \$87.90  |           |
| 8    |      | \$48.40 #      | \$94.60  | \$72.50   |
| 9    |      | \$51.20 #      | \$100.80 | \$76.70   |
| 10   |      | \$54.60 #      | \$107.00 | \$81.80   |
| 11   |      | \$58.10 #      | \$113.10 | \$86.80   |
| 12   |      | \$58.10 #      | \$113.10 | \$86.80   |
| 13   |      | \$61.50 #      | \$119.30 | \$92.20   |
| 14   | QF   | \$61.50 #      | \$119.30 | \$92.20   |
| 15   |      | \$64.40 #      | \$127.70 | \$96.60   |
| 16   |      | \$64.40 #      | \$127.70 | \$96.60   |
| 17   |      | \$71.00 #      | \$138.20 | \$106.60  |
| 18   |      | \$71.00 #      | \$138.20 | \$106.60  |
| 19   |      | \$73.50 #      | \$144.40 | \$110.10  |
| 20   |      | \$73.50 #      | \$144.40 | \$110.10  |
| 21   |      | \$80.60 #      | \$152.50 | \$120.90  |
| 22   |      | \$80.60 #      | \$152.50 | \$120.90  |
| 23   |      | \$92.80 #      | \$175.40 | \$139.40  |
| 24   |      | \$92.80 #      | \$175.40 | \$139.40  |



**Hose Adapter**

| Ø in | Ends | Standard gauge |          | 14ga Galv |
|------|------|----------------|----------|-----------|
|      |      | Galv           | 304SS    |           |
| 3    |      | \$32.60 #      | \$60.50  |           |
| 4    |      | \$32.60 #      | \$60.50  |           |
| 5    |      | \$36.40 #      | \$69.40  |           |
| 6    |      | \$42.80 #      | \$83.10  |           |
| 7    |      | \$46.20 #      | \$89.30  |           |
| 8    |      | \$49.40 #      | \$95.90  | \$74.00   |
| 9    |      | \$52.10 #      | \$102.30 | \$78.10   |
| 10   |      | \$55.40 #      | \$108.80 | \$83.30   |
| 11   |      | \$59.40 #      | \$115.20 | \$89.20   |
| 12   |      | \$59.40 #      | \$115.20 | \$89.20   |
| 13   |      | \$62.70 #      | \$121.40 | \$94.00   |
| 14   | QF   | \$62.70 #      | \$121.40 | \$94.00   |
| 15   |      | \$65.50 #      | \$129.90 | \$98.30   |
| 16   |      | \$65.50 #      | \$129.90 | \$98.30   |
| 17   |      | \$72.30 #      | \$140.40 | \$108.40  |
| 18   |      | \$72.30 #      | \$140.40 | \$108.40  |
| 19   |      | \$74.60 #      | \$146.80 | \$112.10  |
| 20   |      | \$74.60 #      | \$146.80 | \$112.10  |
| 21   |      | \$82.20 #      | \$155.50 | \$123.20  |
| 22   |      | \$82.20 #      | \$155.50 | \$123.20  |
| 23   |      | \$94.40 #      | \$178.50 | \$141.60  |
| 24   |      | \$94.40 #      | \$178.50 | \$141.60  |



**End Cap**

| Ø in | Ends | Standard gauge |          | 14ga Galv |
|------|------|----------------|----------|-----------|
|      |      | Galv           | 304SS    |           |
| 3    |      | \$23.40        | \$45.90  |           |
| 4    |      | \$23.40        | \$45.90  |           |
| 5    |      | \$25.20        | \$50.80  |           |
| 6    |      | \$28.50        | \$56.30  |           |
| 7    |      | \$32.00        | \$63.80  |           |
| 8    |      | \$33.90        | \$68.80  | \$50.70   |
| 9    |      | \$36.90        | \$74.10  | \$55.60   |
| 10   |      | \$38.70        | \$79.30  | \$58.10   |
| 11   |      | \$40.80        | \$84.60  | \$61.40   |
| 12   |      | \$40.80        | \$84.60  | \$61.40   |
| 13   |      | \$43.60        | \$89.30  | \$65.30   |
| 14   | QF   | \$43.60        | \$89.30  | \$65.30   |
| 15   |      | \$45.80        | \$94.30  | \$68.80   |
| 16   |      | \$45.80        | \$94.30  | \$68.80   |
| 17   |      | \$48.60        | \$99.30  | \$72.80   |
| 18   |      | \$48.60        | \$99.30  | \$72.80   |
| 19   |      | \$51.70        | \$107.10 | \$77.50   |
| 20   |      | \$51.70        | \$107.10 | \$77.50   |
| 21   |      | \$53.30        | \$131.80 | \$80.20   |
| 22   |      | \$53.30        | \$131.80 | \$80.20   |
| 23   |      | \$61.60        | \$151.30 | \$92.40   |
| 24   |      | \$61.60        | \$151.30 | \$92.40   |



**End Cap with Screen**

| Ø in | Ends | Standard gauge |          |
|------|------|----------------|----------|
|      |      | Galv           | 304SS    |
| 3    |      | \$59.20        | \$66.80  |
| 4    |      | \$59.20        | \$66.80  |
| 5    |      | \$61.60        | \$71.90  |
| 6    |      | \$64.00        | \$77.10  |
| 7    |      | \$68.30        | \$84.80  |
| 8    |      | \$69.90        | \$89.80  |
| 9    |      | \$73.10        | \$95.20  |
| 10   |      | \$74.60        | \$100.50 |
| 11   |      | \$77.10        | \$105.60 |
| 12   |      | \$77.10        | \$105.60 |
| 13   | QF   | \$79.40        | \$110.60 |
| 14   |      | \$79.40        | \$110.60 |
| 15   |      | \$81.50        | \$115.60 |
| 16   |      | \$81.50        | \$115.60 |
| 17   |      | \$84.90        | \$120.80 |
| 18   |      | \$84.90        | \$120.80 |
| 19   |      | \$87.60        | \$128.40 |
| 20   |      | \$87.60        | \$128.40 |
| 21   |      | \$89.40        | \$153.30 |
| 22   |      | \$89.40        | \$153.30 |
| 23   |      | \$102.60       | \$176.20 |
| 24   |      | \$102.60       | \$176.20 |



**End Plate**

| Ø in | 14ga Galv | 12ga Galv |
|------|-----------|-----------|
| 8    | \$24.60   | \$26.40   |
| 9    | \$27.00   | \$29.40   |
| 10   | \$32.40   | \$34.80   |
| 11   | \$42.30   | \$45.50   |
| 12   | \$42.30   | \$45.50   |
| 13   | \$52.40   | \$56.60   |
| 14   | \$52.40   | \$56.60   |
| 15   | \$71.50   | \$77.10   |
| 16   | \$71.50   | \$77.10   |
| 17   | \$75.70   | \$81.50   |
| 18   | \$75.70   | \$81.50   |
| 20   | \$79.40   | \$85.50   |
| 22   | \$88.30   | \$95.20   |
| 24   | \$94.80   | \$102.30  |
| 26   | \$132.00  | \$142.40  |
| 28   | \$145.30  | \$156.90  |
| 30   | \$159.10  | \$171.70  |
| 32   | \$167.10  | \$180.40  |
| 34   | \$180.70  | \$194.90  |
| 36   | \$186.00  | \$200.60  |
| 38   | \$188.80  | \$203.60  |
| 40   | \$202.20  | \$218.30  |
| 42   | \$208.00  | \$224.50  |
| 44   | \$218.90  | \$236.00  |
| 46   | \$228.70  | \$247.00  |
| 48   | \$239.10  | \$257.90  |

#-Denotes an item that is returnable. See page 26 for a full listing of returnable items.



**Blast Gate Manual**

| Ø in | Ends       | Standard gauge |            | 14ga Galv  | Ends       | Standard gauge |            |
|------|------------|----------------|------------|------------|------------|----------------|------------|
|      |            | Galv           | 304SS ◇    |            |            | Galv           | 304SS ◇    |
| 3    | QF         | \$53.30 #      | \$235.20   |            | AFL        | \$81.90        | \$369.70   |
| 4    |            | \$53.30 #      | \$235.20   |            |            | \$81.90        | \$369.70   |
| 5    |            | \$55.40 #      | \$275.90   |            |            | \$87.10        | \$418.90   |
| 6    |            | \$72.90 #      | \$374.50   |            |            | \$112.30       | \$525.10   |
| 7    |            | \$86.30 #      | \$392.50   |            |            | \$128.40       | \$553.90   |
| 8    |            | \$102.10 #     | \$398.50   | \$507.40   |            | \$154.30       | \$564.70   |
| 9    |            | \$141.30 #     | \$513.10   | \$596.40   |            | \$199.40       | \$679.60   |
| 10   |            | \$179.50 #     | \$553.90   | \$669.80   |            | \$248.80       | \$725.10   |
| 11 ◇ |            | \$233.10       | \$700.20   | \$872.80   |            | \$323.70       | \$879.70   |
| 12   |            | \$233.10 #     | \$700.20   | \$872.80   |            | \$323.70       | \$879.70   |
| 14   |            | \$345.20 #     | \$808.90   | \$1,075.80 |            | \$457.60       | \$998.40   |
| 16 ◇ |            | \$502.30       | \$1,503.50 | \$1,197.60 |            | \$655.60       | \$1,731.30 |
| 18 ◇ |            | \$638.20       | \$1,711.60 | \$1,380.30 |            | \$800.20       | \$2,011.80 |
| 20 ◇ |            | \$790.70       | \$2,405.30 | \$1,502.00 |            | \$960.70       | \$2,730.50 |
| 22 ◇ | \$863.10   | \$2,468.70     | \$1,705.10 | \$1,052.70 | \$2,827.60 |                |            |
| 24 ◇ | \$1,020.00 | \$2,539.00     | \$1,908.10 | \$1,223.30 | \$2,959.60 |                |            |
| 26 ◇ |            |                |            | \$1,946.90 | \$3,463.90 |                |            |
| 28 ◇ |            |                |            | \$2,253.60 | \$3,861.30 |                |            |
| 30 ◇ |            |                |            | \$2,765.80 | \$4,258.80 |                |            |
| 32   |            |                |            |            |            |                |            |
| 34   |            |                |            |            |            |                |            |
| 36   |            |                |            |            |            |                |            |
| 38   |            |                |            |            |            |                |            |
| 40   |            |                |            |            |            |                |            |

Contact Nordfab regarding pricing for heavier gauges

◇ SS Blast Gates have a production time of 7 days minimum.



**Blast Gate NFMS**

| Ø in | Ends     | Standard gauge |            |
|------|----------|----------------|------------|
|      |          | Galv           | 304SS ◇    |
| 3    | QF       | \$501.70       | \$860.50   |
| 4    |          | \$501.70       | \$860.50   |
| 5    |          | \$530.10       | \$909.60   |
| 6    |          | \$544.80       | \$934.20   |
| 7    |          | \$584.90       | \$1,003.00 |
| 8    |          | \$604.80       | \$1,037.30 |
| 9    |          | \$642.20       | \$1,101.40 |
| 10   |          | \$716.80       | \$1,229.20 |
| 12   |          | \$742.60       | \$1,273.40 |
| 14   |          | \$762.80       | \$1,307.80 |
| 16 ◇ | \$811.30 | \$1,372.20     |            |

◇ SS Blast Gates have a production time of 7 days minimum.



**SD Automatic Blast Gate**

| Ø in | Ends       | Standard gauge |
|------|------------|----------------|
|      |            | Galv           |
| 3    | QF         | \$836.30       |
| 4    |            | \$836.30       |
| 5    |            | \$852.90       |
| 6    |            | \$852.90       |
| 7    |            | \$919.90       |
| 8    |            | \$1,003.50     |
| 9    |            | \$1,045.50     |
| 10   |            | \$1,045.50     |
| 12   |            | \$1,087.30     |
| 14   |            | \$1,212.80     |
| 16 ◇ |            | \$1,354.70     |
| 18 ◇ |            | \$1,505.30     |
| 20 ◇ |            | \$1,622.40     |
| 22 ◇ |            | \$1,772.90     |
| 24 ◇ | \$1,973.70 |                |

◇ Items may take longer than standard lead times.

120V Control Circuit and 75psi minimum air pressure is standard. Optional 24V DC or AC control circuits available.



**Blast Gate NFES Automatic**

| Ø in | Ends | Standard gauge |            | 14ga Galv  | Ends | 14ga Galv | 12ga Galv  |            |
|------|------|----------------|------------|------------|------|-----------|------------|------------|
|      |      | Galv           | 304SS ◇    |            |      |           |            |            |
| 3    | QF   | \$1,338.00     | \$2,851.60 |            | AFL  |           |            |            |
| 4    |      | \$1,338.00 #   | \$2,851.60 |            |      |           |            |            |
| 5    |      | \$1,405.00 #   | \$2,866.50 |            |      |           |            |            |
| 6    |      | \$1,405.00 #   | \$2,880.90 |            |      |           |            |            |
| 7    |      | \$1,438.60 #   | \$2,895.80 |            |      |           |            |            |
| 8    |      | \$1,438.60 #   | \$3,166.20 | \$1,524.90 |      |           | \$1,553.00 |            |
| 9    |      | \$1,505.30     | \$3,977.60 | \$1,595.60 |      |           | \$1,627.10 |            |
| 10   |      | \$1,547.10     | \$4,051.50 | \$1,640.10 |      |           | \$1,674.40 | \$1,736.40 |
| 12   |      | \$1,589.00     | \$4,287.10 | \$1,684.30 |      |           | \$1,735.50 | \$1,798.90 |
| 14   |      | \$1,772.90     | \$4,542.70 | \$1,879.30 |      |           | \$1,938.70 | \$2,009.50 |
| 16 ◇ |      | \$2,007.20     | \$4,700.50 | \$2,127.60 |      |           | \$2,225.20 | \$2,305.60 |
| 18 ◇ |      | \$2,157.60     | \$5,272.20 | \$2,287.10 |      |           | \$2,393.80 | \$2,480.10 |
| 20 ◇ |      | \$2,341.70     | \$5,678.50 | \$2,482.10 |      |           | \$2,601.00 | \$2,694.60 |
| 22 ◇ |      | \$2,425.30     | \$6,145.60 | \$2,570.90 |      |           | \$2,697.50 | \$2,794.50 |

◇ SS Blast Gates have a production time of 7 days minimum.

120V Control Circuit and 75psi minimum air pressure is standard. Optional 24V DC or AC control circuits available.

#-Denotes an item that is returnable. See page 26 for a full listing of returnable items.

**Rubber Hose, Black\***

| Ø in  | Price PER FOOT | Ø in | Price PER FOOT |
|-------|----------------|------|----------------|
| 1     | \$6.20         | 20   | \$73.20        |
| 1.5   | \$6.20         | 22   | \$84.40        |
| 2     | \$6.80         | 24   | \$97.20        |
| 2.5   | \$8.70         |      |                |
| 80 mm | \$10.70        |      |                |
| 3.5   | \$10.50        |      |                |
| 4     | \$10.50        |      |                |
| 5     | \$13.40        |      |                |
| 5.5   | \$15.30        |      |                |
| 6     | \$17.00        |      |                |
| 7     | \$19.90        |      |                |
| 8     | \$21.80        |      |                |
| 9     | \$32.90        |      |                |
| 10    | \$33.90        |      |                |
| 12    | \$35.00        |      |                |
| 14    | \$52.50        |      |                |
| 16    | \$60.50        |      |                |
| 18    | \$68.50        |      |                |

\*Sold in 5' increments

**Rubber Hose, Clear\***

| Ø in  | Price PER FOOT |
|-------|----------------|
| 2     | \$7.90         |
| 2.5   | \$9.90         |
| 80 mm | \$11.70        |
| 4     | \$13.50        |
| 5     | \$15.70        |
| 5.5   | \$16.40        |
| 6     | \$20.30        |
| 7     | \$22.60        |
| 8     | \$26.10        |
| 9     | \$35.90        |
| 10    | \$39.10        |
| 12    | \$39.70        |
| 14    | \$58.50        |
| 16    | \$67.60        |

\*Sold in 5' increments

**Static Dissipative Urethane Hose, Clear\***

| Ø in  | Price PER FOOT |
|-------|----------------|
| 80 mm | \$20.50        |
| 4     | \$24.20        |
| 5     | \$32.50        |
| 6     | \$35.90        |
| 8     | \$40.00        |
| 10    | \$50.80        |
| 12    | \$71.40        |

\*Sold in 5' increments

**Hose Clamp**

| Ø in | 304SS     |
|------|-----------|
| 2    | \$4.00 #  |
| 3    | \$4.00 #  |
| 4    | \$6.60 #  |
| 5    | \$6.60 #  |
| 6    | \$8.20 #  |
| 7    | \$9.90 #  |
| 8    | \$12.40 # |
| 9    | \$13.40 # |
| 10   | \$13.90 # |
| 12   | \$20.20 # |
| 14   | \$21.50   |
| 16   | \$24.30   |
| 18   | \$25.90   |
| 20   | \$27.70   |
| 22   | \$30.30   |
| 24   | \$32.90   |

**Rigid Flex Steel Hose ♦\***

| Ø in | Galv Price PER FOOT | 304SS Price PER FOOT |
|------|---------------------|----------------------|
| 1.5  | \$8.10              | N/A                  |
| 2    | \$10.30             | \$28.00              |
| 2.5  | \$10.70             | N/A                  |
| 3    | \$15.70             | \$41.20              |
| 4    | \$19.60             | \$54.50              |
| 5    | \$24.10             | \$67.70              |
| 6    | \$29.60             | \$69.60              |
| 7    | \$33.80             | \$78.70              |
| 8    | \$38.50             | \$89.20              |
| 9    | \$43.20             | \$104.30             |
| 10   | \$46.50             | \$106.60             |
| 12   | \$56.40             | \$124.00             |
| 14   | \$65.10             | \$146.00             |

♦ Items may take longer than standard lead times. \*Sold in 5' increments

**Ultra Flex Steel Hose ♦\***

| Ø in | Galv Price PER FOOT | 304SS Price PER FOOT |
|------|---------------------|----------------------|
| 3    | \$29.40             | \$69.40              |
| 4    | \$29.40             | \$69.40              |
| 5    | \$36.50             | \$85.80              |
| 6    | \$44.60             | \$105.00             |
| 7    | \$52.80             | \$123.90             |
| 8    | \$59.70             | \$137.40             |

♦ Items may take longer than standard lead times. \*Sold in 5' increments

**Bridge Clamp for Hose**

| Ø in | 304SS   |
|------|---------|
| 2    | \$9.50  |
| 2.5  | \$10.40 |
| 3    | \$10.10 |
| 3.5  | \$12.70 |
| 4    | \$11.20 |
| 5    | \$12.40 |
| 6    | \$15.20 |
| 7    | \$17.40 |
| 8    | \$18.70 |
| 10   | \$21.10 |
| 12   | \$30.40 |

**Rigid Flex Steel Hose Assembly ♦**

| Ø in | Ends | Galv Price PER 5' | 304SS Price PER 5' | Ends | Galv Price PER 5' | 304SS Price PER 5' |
|------|------|-------------------|--------------------|------|-------------------|--------------------|
|      |      | ASSEMBLY          | ASSEMBLY           |      | ASSEMBLY          | ASSEMBLY           |
| 3    | QF   | \$119.00          | \$246.70           | AFL  | \$147.70          | \$381.40           |
| 4    |      | \$138.60          | \$313.00           |      | \$167.20          | \$447.60           |
| 5    |      | \$160.90          | \$379.20           |      | \$192.50          | \$522.30           |
| 6    |      | \$188.60          | \$388.10           |      | \$228.00          | \$538.60           |
| 7    |      | \$209.60          | \$433.90           |      | \$251.70          | \$595.40           |
| 8    |      | \$233.20          | \$486.70           |      | \$285.40          | \$653.00           |
| 9    |      | \$256.20          | \$561.70           |      | \$314.30          | \$728.30           |
| 10   |      | \$273.10          | \$573.30           |      | \$342.30          | \$744.40           |
| 12   |      | \$322.40          | \$660.40           |      | \$413.00          | \$840.10           |
| 14   |      | \$366.30          | \$770.60           |      | \$478.90          | \$960.20           |

♦ Items may take longer than standard lead times.

**Ultra Flex Steel Hose Assembly ♦**

| Ø in | Ends | Galv Price PER 5' | 304SS Price PER 5' | Ends | Galv Price PER 5' | 304SS Price PER 5' |
|------|------|-------------------|--------------------|------|-------------------|--------------------|
|      |      | ASSEMBLY          | ASSEMBLY           |      | ASSEMBLY          | ASSEMBLY           |
| 3    | QF   | \$187.20          | \$387.40           | AFL  | \$215.90          | \$522.00           |
| 4    |      | \$187.20          | \$387.40           |      | \$215.90          | \$522.00           |
| 5    |      | \$223.10          | \$469.80           |      | \$254.70          | \$612.80           |
| 6    |      | \$263.60          | \$565.80           |      | \$303.20          | \$716.40           |
| 7    |      | \$304.20          | \$659.80           |      | \$346.30          | \$821.20           |
| 8    |      | \$338.70          | \$727.40           |      | \$390.90          | \$893.60           |

♦ Items may take longer than standard lead times.

## Flex Hose Styles

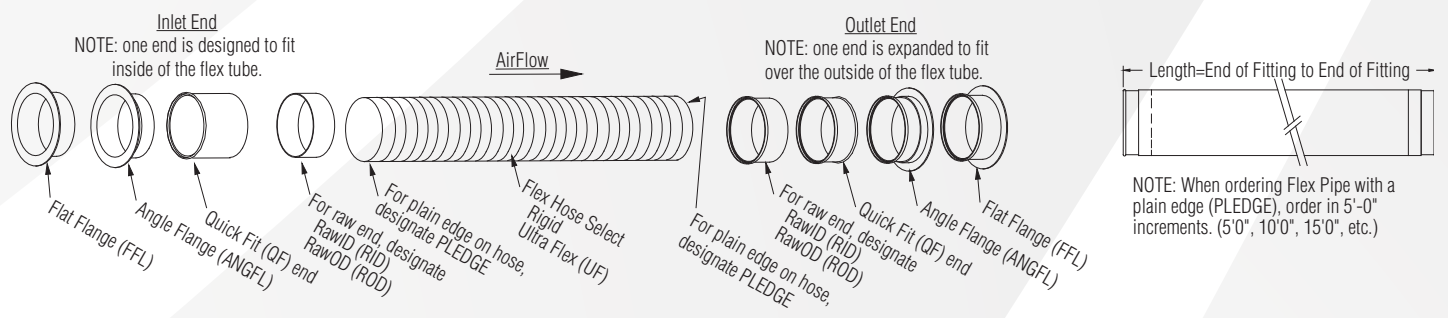

#—Denotes an item that is returnable. See page 26 for a full listing of returnable items.



**Bell Mouth Hood**

| Ø in | Ø End    | Standard gauge |          |
|------|----------|----------------|----------|
|      |          | Galv           | 304SS ◊  |
| 3    | QF       | \$124.20       | \$213.20 |
| 4    |          | \$124.20       | \$213.20 |
| 5    |          | \$144.20       | \$247.10 |
| 6    |          | \$157.70       | \$271.10 |
| 7    |          | \$168.60       | \$289.40 |
| 8    |          | \$181.00       | \$310.60 |
| 9    |          | \$197.70       | \$339.70 |
| 10   |          | \$212.80       | \$365.70 |
| 11   |          | \$254.50       | \$436.70 |
| 12   |          | \$254.50       | \$436.70 |
| 13   |          | \$258.80       | \$444.60 |
| 14   |          | \$258.80       | \$444.60 |
| 15   |          | \$263.60       | \$452.80 |
| 16   |          | \$263.60       | \$452.80 |
| 17   | \$305.00 | \$523.80       |          |
| 18   | \$305.00 | \$523.80       |          |
| 20   | \$346.20 | \$594.80       |          |
| 22   | \$387.40 | \$665.90       |          |
| 24   | \$445.90 | \$765.60       |          |

◊ SS Bell Mouth Hoods have a lead time of 4-5 business days minimum.

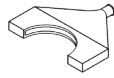

**Barrel Hood**

| Ø in | Ends | Standard gauge |            |
|------|------|----------------|------------|
|      |      | Galv           | 304SS ◊    |
| 4    | QF   | \$571.60       | \$1,584.40 |
| 6    |      | \$612.70       | \$1,698.60 |
| 8    |      | \$632.70       | \$1,772.60 |

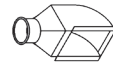

**Radial Arm Saw Hood**

| Ø in | Ø End | Standard gauge |              |
|------|-------|----------------|--------------|
|      |       | Galv           | 304SS        |
| 4    | QF    | \$308.60       | Call Nordfab |
| 5    |       | \$376.40       |              |
| 6    |       | \$517.30       |              |



**Canopy Hood**

| Ø in | Ø End | Rect. End  | Standard gauge |            | 14ga Galv  | Ends | 14ga Galv  | 12ga Galv  |
|------|-------|------------|----------------|------------|------------|------|------------|------------|
|      |       |            | Galv           | 304SS ◊    |            |      |            |            |
| 16   | QF    | 18" square | \$287.80       | \$625.30   | \$431.60   | AFL  | \$485.40   |            |
| 16   |       | 24" square | \$526.00       | \$1,140.80 | \$789.00   |      | \$842.90   | \$1,000.90 |
| 18   |       | 36" square | \$1,360.30     | \$2,939.80 | \$2,040.60 |      | \$2,096.60 | \$2,504.60 |
| 18   |       | 48" square | \$2,419.00     | \$5,228.30 | \$3,628.80 |      | \$3,684.70 | \$4,410.40 |



**Suction Hood**

| Ø End | No. of Pickups | Standard gauge |            |
|-------|----------------|----------------|------------|
|       |                | Galv           | 304SS      |
| QF    | 2              | \$347.00       | \$730.10   |
|       | 3              | \$425.00       | \$882.60   |
|       | 4              | \$515.00       | \$1,120.50 |
|       | 5              | \$640.00       | \$1,550.40 |
|       | 6              | \$732.00       | \$1,820.80 |



**Router Hood**

| Ø in | Ø End | Standard gauge |          |
|------|-------|----------------|----------|
|      |       | Galv           | 304SS    |
| 3    | QF    | \$260.90       | \$723.80 |
| 4    |       | \$260.90       | \$723.80 |
| 5    |       | \$268.10       | \$744.00 |
| 6    |       | \$276.80       | \$768.40 |
| 7    |       | \$285.20       | \$792.00 |
| 8    |       | \$293.20       | \$813.70 |
| 9    |       | \$305.00       | \$846.40 |
| 10   |       | \$325.40       | \$902.60 |



**Router Hood with Magnet**

| Ø in | Ø End | Standard gauge |            |
|------|-------|----------------|------------|
|      |       | Galv           | 304SS      |
| 3    | QF    | \$327.50       | \$908.70   |
| 4    |       | \$327.50       | \$908.70   |
| 5    |       | \$335.10       | \$930.40   |
| 6    |       | \$345.70       | \$959.80   |
| 7    |       | \$352.30       | \$977.10   |
| 8    |       | \$358.00       | \$994.10   |
| 9    |       | \$370.60       | \$1,028.70 |
| 10   |       | \$392.00       | \$1,088.50 |





**Manual Diverter Valve**

| Ø in | Ends       | Standard gauge |            | 14ga Galv Collar & Transition | Ends       | 14ga Galv Collar & Transition | 12ga Galv Collar & Transition |
|------|------------|----------------|------------|-------------------------------|------------|-------------------------------|-------------------------------|
|      |            | Mild Steel     | 304SS      |                               |            |                               |                               |
| 3    |            | \$2,126.80     | \$3,063.70 |                               |            |                               |                               |
| 4    |            | \$2,126.80     | \$3,063.70 |                               |            |                               |                               |
| 5    |            | \$2,396.20     | \$3,348.40 |                               |            |                               |                               |
| 6    |            | \$2,561.30     | \$3,576.20 |                               |            |                               |                               |
| 7    |            | \$2,698.50     | \$3,769.70 |                               |            |                               |                               |
| 8    |            | \$2,825.60     | \$3,946.50 | \$3,051.60                    |            | \$3,096.20                    |                               |
| 9    |            | \$2,952.40     | \$4,123.00 | \$3,188.80                    |            | \$3,238.00                    |                               |
| 10   |            | \$3,074.60     | \$4,293.60 | \$3,320.60                    |            | \$3,374.50                    | \$3,497.80                    |
| 11   | QF         | \$3,275.50     | \$4,573.30 | \$3,537.40                    | AFL        | \$3,596.60                    | \$3,727.80                    |
| 12   |            | \$3,275.50     | \$4,573.30 | \$3,537.40                    |            | \$3,617.90                    | \$3,748.90                    |
| 13   |            | \$3,580.20     | \$4,999.90 | \$3,866.60                    |            | \$3,953.30                    | \$4,096.60                    |
| 14   |            | \$3,580.20     | \$4,999.90 | \$3,866.60                    |            | \$3,959.90                    | \$4,103.10                    |
| 15   |            | \$3,885.20     | \$5,427.40 | \$4,196.10                    |            | \$4,290.90                    | \$4,446.30                    |
| 16   |            | \$3,885.20     | \$5,427.40 | \$4,196.10                    |            | \$4,349.80                    | \$4,505.20                    |
| 17   |            | \$4,192.80     | \$5,854.20 | \$4,528.00                    |            | \$4,689.80                    | \$4,857.60                    |
| 18   |            | \$4,192.80     | \$5,854.20 | \$4,528.00                    |            | \$4,696.10                    | \$4,863.80                    |
| 20   |            | \$4,375.50     | \$6,110.50 | \$4,725.80                    |            | \$4,912.40                    | \$5,087.40                    |
| 22   |            | \$4,558.50     | \$6,366.80 | \$4,923.20                    |            | \$5,122.30                    | \$5,304.80                    |
| 24   | \$5,242.40 | \$7,321.90     | \$5,661.60 | \$5,866.00                    | \$6,075.70 |                               |                               |

◇ Diverter Valves have a lead time of 7 days minimum



**Automatic Diverter Valve**

| Ø in | Ends       | Standard gauge |             | 14ga Galv   | Ends        | 14ga Galv  | 12ga Galv  |
|------|------------|----------------|-------------|-------------|-------------|------------|------------|
|      |            | Mild Steel     | 304SS       |             |             |            |            |
| 3    |            | \$3,361.70     | \$4,840.30  |             |             |            |            |
| 4    |            | \$3,361.70     | \$4,840.30  |             |             |            |            |
| 5    |            | \$3,669.40     | \$5,125.30  |             |             |            |            |
| 6    |            | \$4,078.20     | \$5,694.50  |             |             |            |            |
| 7    |            | \$4,179.90     | \$5,837.40  |             |             |            |            |
| 8    |            | \$4,322.40     | \$6,036.30  | \$4,668.20  |             | \$4,712.50 |            |
| 9    |            | \$4,485.10     | \$6,264.10  | \$4,843.70  |             | \$4,892.90 |            |
| 10   |            | \$4,792.50     | \$6,691.60  | \$5,175.60  |             | \$5,229.90 | \$5,421.40 |
| 11   | QF         | \$5,097.20     | \$7,118.40  | \$5,504.70  | AFL         | \$5,564.10 | \$5,768.10 |
| 12   |            | \$5,097.20     | \$7,118.40  | \$5,504.70  |             | \$5,585.50 | \$5,789.30 |
| 13   |            | \$5,402.00     | \$7,545.70  | \$5,834.40  |             | \$5,920.60 | \$6,136.90 |
| 14   |            | \$5,402.00     | \$7,545.70  | \$5,834.40  |             | \$5,927.50 | \$6,143.70 |
| 15   |            | \$6,507.50     | \$9,088.70  | \$7,028.20  |             | \$7,123.10 | \$7,383.50 |
| 16   |            | \$6,507.50     | \$9,088.70  | \$7,028.20  |             | \$7,182.00 | \$7,442.20 |
| 17   |            | \$7,066.50     | \$9,869.00  | \$7,631.80  |             | \$7,793.40 | \$8,076.00 |
| 18   |            | \$7,066.50     | \$9,869.00  | \$7,631.80  |             | \$7,799.60 | \$8,082.20 |
| 20   |            | \$7,579.80     | \$10,586.40 | \$8,186.20  |             | \$8,373.00 | \$8,676.30 |
| 22   |            | \$8,657.00     | \$12,090.00 | \$9,349.60  |             | \$9,548.90 | \$9,895.20 |
| 24   | \$9,955.80 | \$13,903.50    | \$10,752.40 | \$10,956.70 | \$11,354.90 |            |            |

◇ Diverter Valves have a lead time of 7 days minimum

120V Control Circuit and 75psi minimum air pressure is standard. Optional 24V DC or AC control circuits available.



**SD Manual Diverter Valve**

| Ø in | Ends | Std 14ga Galv | Std 14ga 304SS |
|------|------|---------------|----------------|
| 3    |      | \$1,569.60    | \$1,900.10     |
| 4    |      | \$1,569.60    | \$1,900.10     |
| 5    |      | \$1,569.60    | \$1,900.10     |
| 6    |      | \$1,890.10    | \$2,217.90     |
| 7    |      | \$1,890.10    | \$2,217.90     |
| 8    | QF   | \$2,085.30    | \$2,447.60     |
| 9    |      | \$2,085.30    | \$2,447.60     |
| 10   |      | \$2,269.00    | \$2,663.10     |
| 11   |      | \$2,269.00    | \$2,663.10     |
| 12   |      | \$2,417.50    | \$2,836.10     |
| 13   |      | \$2,417.50    | \$2,836.10     |

◇ Diverter Valves have a lead time of 7 days minimum



**SD Automatic Diverter Valve ◇**

| Ø in | Ends | Std 14ga Galv | Std 14ga 304SS |
|------|------|---------------|----------------|
| 3    |      | \$2,481.10    | \$3,001.80     |
| 4    |      | \$2,481.10    | \$3,001.80     |
| 5    |      | \$2,481.10    | \$3,001.80     |
| 6    |      | \$3,009.80    | \$3,531.70     |
| 7    |      | \$3,009.80    | \$3,531.70     |
| 8    | QF   | \$3,189.70    | \$3,743.60     |
| 9    |      | \$3,189.70    | \$3,743.60     |
| 10   |      | \$3,536.50    | \$4,150.00     |
| 11   |      | \$3,536.50    | \$4,150.00     |
| 12   |      | \$3,761.80    | \$4,414.80     |
| 13   |      | \$3,761.80    | \$4,414.80     |

◇ Diverter Valves have a lead time of 7 days minimum

120V Control Circuit and 75psi minimum air pressure is standard. Optional 24V DC or AC control circuits available.



**Gripple Hanger**

| Size Weight  | Price     |
|--------------|-----------|
| Up to 22lbs  | \$11.10 # |
| Up to 100lbs | \$15.60 # |
| Up to 200lbs | \$18.70 # |
| Up to 495lbs | \$35.90 # |
| Up to 715lbs | \$47.10 # |



**Pipe Hanger**

| Ø in | Galv      | 304SS    |
|------|-----------|----------|
| 3    | \$12.20 # | \$25.70  |
| 4    | \$12.20 # | \$25.70  |
| 5    | \$13.30 # | \$28.00  |
| 6    | \$15.50 # | \$31.70  |
| 7    | \$15.50 # | \$35.50  |
| 8    | \$18.50 # | \$40.80  |
| 9    | \$23.00 # | \$50.30  |
| 10   | \$23.90 # | \$53.80  |
| 11   | \$26.80   | \$59.70  |
| 12   | \$26.80 # | \$59.70  |
| 13   | \$30.40   | \$67.30  |
| 14   | \$30.40 # | \$67.30  |
| 15   | \$39.50   | \$83.60  |
| 16   | \$39.50   | \$83.60  |
| 17   | \$42.00   | \$85.70  |
| 18   | \$42.00   | \$85.70  |
| 19   | \$45.90   | \$93.20  |
| 20   | \$45.90   | \$93.20  |
| 21   | \$56.60   | \$113.50 |
| 22   | \$56.60   | \$113.50 |
| 23   | \$64.70   | \$130.50 |
| 24   | \$64.70   | \$130.50 |
| 26   | \$73.70   | \$143.30 |
| 28   | \$80.10   | \$150.70 |
| 30   | \$83.20   | \$171.50 |
| 32   | \$102.80  | \$212.20 |
| 34   | \$112.80  | \$234.70 |
| 36   | \$126.40  | \$258.70 |
| 38   | \$139.60  | \$285.00 |
| 40   | \$153.00  | \$313.00 |

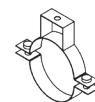

**Pipe Hanger HJ**

| Ø in | Galv     | 304SS    |
|------|----------|----------|
| 3    | \$24.10  | \$52.30  |
| 4    | \$24.10  | \$52.30  |
| 5    | \$27.00  | \$58.00  |
| 6    | \$30.60  | \$66.30  |
| 7    | \$30.60  | \$66.30  |
| 8    | \$36.50  | \$79.00  |
| 9    | \$45.20  | \$97.50  |
| 10   | \$48.20  | \$103.40 |
| 11   | \$53.30  | \$114.80 |
| 12   | \$53.30  | \$114.80 |
| 13   | \$61.00  | \$131.30 |
| 14   | \$61.00  | \$131.30 |
| 15   | \$79.00  | \$169.50 |
| 16   | \$79.00  | \$169.50 |
| 17   | \$83.50  | \$180.10 |
| 18   | \$83.50  | \$180.10 |
| 19   | \$91.90  | \$197.20 |
| 20   | \$91.90  | \$197.20 |
| 21   | \$112.80 | \$242.70 |
| 22   | \$112.80 | \$242.70 |
| 23   | \$130.00 | \$279.10 |
| 24   | \$130.00 | \$279.10 |



**Clamp Hanger**

| Ø in | Galv     | 304SS    |
|------|----------|----------|
| 3    | \$34.10  | \$72.80  |
| 4    | \$34.10  | \$72.80  |
| 5    | \$37.70  | \$81.40  |
| 6    | \$42.90  | \$92.70  |
| 7    | \$42.90  | \$92.70  |
| 8    | \$51.40  | \$110.60 |
| 9    | \$63.30  | \$136.80 |
| 10   | \$67.50  | \$144.60 |
| 11   | \$74.90  | \$160.90 |
| 12   | \$74.90  | \$160.90 |
| 13   | \$91.10  | \$183.60 |
| 14   | \$91.10  | \$183.60 |
| 15   | \$110.50 | \$237.40 |
| 16   | \$110.50 | \$237.40 |
| 17   | \$117.10 | \$251.70 |
| 18   | \$117.10 | \$251.70 |
| 19   | \$128.60 | \$277.20 |
| 20   | \$128.60 | \$277.20 |
| 21   | \$158.00 | \$339.80 |
| 22   | \$158.00 | \$339.80 |
| 23   | \$182.10 | \$391.40 |
| 24   | \$182.10 | \$391.40 |



**Strut Hanger**

| Size | Galv    | 304SS    |
|------|---------|----------|
| 3    | \$18.30 | \$39.00  |
| 4    | \$18.30 | \$39.00  |
| 5    | \$20.30 | \$42.30  |
| 6    | \$23.30 | \$47.50  |
| 7    | \$23.30 | \$52.70  |
| 8    | \$27.40 | \$61.50  |
| 9    | \$34.20 | \$75.40  |
| 10   | \$36.10 | \$80.90  |
| 11   | \$39.90 | \$89.40  |
| 12   | \$39.90 | \$89.40  |
| 13   | \$45.80 | \$100.80 |
| 14   | \$45.80 | \$100.80 |
| 15   | \$59.30 | \$125.80 |
| 16   | \$59.30 | \$125.80 |
| 17   | \$63.10 | \$128.60 |
| 18   | \$63.10 | \$128.60 |
| 19   | \$68.90 | \$139.80 |
| 20   | \$68.90 | \$139.80 |
| 21   | \$85.20 | \$170.30 |
| 22   | \$85.20 | \$170.30 |
| 23   | \$97.40 | \$195.70 |
| 24   | \$97.40 | \$195.70 |

#-Denotes an item that is returnable. See page 26 for a full listing of returnable items.



Wall Flashing

| Ø in | Standard gauge |          |
|------|----------------|----------|
|      | Galv           | 304SS    |
| 4    | \$71.20        | \$126.10 |
| 5    | \$75.00        | \$140.30 |
| 6    | \$89.70        | \$157.00 |
| 7    | \$97.00        | \$168.60 |
| 8    | \$100.90       | \$177.30 |
| 9    | \$113.00       | \$181.50 |
| 10   | \$119.10       | \$188.90 |
| 12   | \$132.00       | \$197.90 |
| 14   | \$137.50       | \$214.00 |
| 16   | \$149.60       | \$245.30 |
| 18   | \$162.20       | \$288.00 |
| 20   | \$172.50       | \$306.80 |
| 22   | \$184.60       | \$329.90 |
| 24   | \$212.30       | \$379.30 |



Roof Flashing

| Ø in | Standard gauge |          |
|------|----------------|----------|
|      | Galv           | 304SS    |
| 4    | \$71.20        | \$126.10 |
| 5    | \$75.00        | \$140.30 |
| 6    | \$89.70        | \$147.90 |
| 7    | \$97.00        | \$168.60 |
| 8    | \$100.90       | \$177.30 |
| 9    | \$113.00       | \$181.50 |
| 10   | \$119.20       | \$188.90 |
| 12   | \$132.00       | \$197.90 |
| 14   | \$137.50       | \$214.00 |
| 16   | \$149.60       | \$231.40 |
| 18   | \$162.20       | \$288.00 |
| 20   | \$172.50       | \$306.80 |
| 22   | \$184.60       | \$329.90 |
| 24   | \$212.30       | \$379.50 |



Roof Skirt

| Ø in | Standard gauge |          |
|------|----------------|----------|
|      | Galv           | 304SS    |
| 4    | \$84.40        | \$160.80 |
| 5    | \$95.60        | \$184.20 |
| 6    | \$97.10        | \$185.80 |
| 7    | \$114.40       | \$222.60 |
| 8    | \$114.40       | \$222.60 |
| 9    | \$136.40       | \$259.70 |
| 10   | \$136.40       | \$259.70 |
| 12   | \$188.00       | \$357.90 |
| 14   | \$196.20       | \$373.80 |
| 16   | \$208.40       | \$401.10 |
| 18   | \$237.50       | \$454.40 |
| 20   | \$261.70       | \$522.60 |
| 22   | \$286.50       | \$646.20 |
| 24   | \$316.30       | \$717.00 |



Weather Cap

| Ø in | Ends       | Standard gauge |            | Ends       | Standard gauge |            |
|------|------------|----------------|------------|------------|----------------|------------|
|      |            | Galv           | 304SS      |            | Galv           | 304SS      |
| 3    | QF         | \$208.00       | \$325.00   | AFL        | \$222.30       | \$392.30   |
| 4    |            | \$221.00       | \$338.00   |            | \$235.30       | \$405.30   |
| 5    |            | \$247.00       | \$364.00   |            | \$262.90       | \$435.50   |
| 6    |            | \$260.00       | \$390.00   |            | \$279.50       | \$465.30   |
| 7    |            | \$292.50       | \$429.00   |            | \$313.60       | \$509.70   |
| 8    |            | \$299.00       | \$468.00   |            | \$325.10       | \$551.20   |
| 9    |            | \$338.00       | \$507.00   |            | \$367.10       | \$590.30   |
| 10   |            | \$361.40       | \$546.00   |            | \$396.00       | \$631.50   |
| 12   |            | \$413.40       | \$585.00   |            | \$458.60       | \$674.80   |
| 14   |            | \$448.50       | \$650.00   |            | \$504.80       | \$744.80   |
| 16   |            | \$546.00       | \$780.00   |            | \$622.70       | \$894.00   |
| 18   |            | \$650.00       | \$845.00   |            | \$731.00       | \$995.00   |
| 20   |            | \$806.00       | \$988.00   |            | \$891.00       | \$1,150.60 |
| 22   |            | \$1,092.00     | \$1,170.00 |            | \$1,186.80     | \$1,349.40 |
| 24   | \$1,209.00 | \$1,300.00     | \$1,310.70 | \$1,510.20 |                |            |



No-Loss Stackhead

| Ø in | Ends | Standard gauge |            | 14ga Galv | Ends | Standard gauge |       | 14ga Galv | 12ga Galv |            |            |            |
|------|------|----------------|------------|-----------|------|----------------|-------|-----------|-----------|------------|------------|------------|
|      |      | Galv           | 304SS      |           |      | Galv           | 304SS |           |           |            |            |            |
| 3    | QF   | \$132.60       | \$299.70   | AFL       |      |                |       |           |           |            |            |            |
| 4    |      | \$132.60       | \$299.70   |           |      |                |       |           |           | \$322.30   |            |            |
| 5    |      | \$138.10       | \$310.30   |           |      |                |       |           |           | \$357.50   |            |            |
| 6    |      | \$146.90       | \$332.40   |           |      |                |       |           |           | \$396.20   | \$471.90   |            |
| 7    |      | \$168.20       | \$379.10   |           |      |                |       |           |           | \$464.10   | \$552.90   |            |
| 8    |      | \$204.90       | \$461.80   |           |      |                |       |           |           | \$307.30   | \$471.00   | \$560.00   |
| 9    |      | \$227.40       | \$480.90   |           |      |                |       |           |           | \$341.10   | \$556.80   | \$662.40   |
| 10   |      | \$251.90       | \$568.50   |           |      |                |       |           |           | \$378.00   | \$559.10   | \$664.60   |
| 11   |      | \$296.10       | \$667.90   |           |      |                |       |           |           | \$444.20   | \$650.90   | \$774.80   |
| 12   |      | \$296.10       | \$667.90   |           |      |                |       |           |           | \$444.20   | \$670.50   | \$794.40   |
| 13   |      | \$352.00       | \$794.20   |           |      |                |       |           |           | \$527.90   | \$894.00   | \$1,061.80 |
| 14   |      | \$352.00       | \$794.20   |           |      |                |       |           |           | \$527.90   | \$896.10   | \$1,064.20 |
| 15   |      | \$412.90       | \$931.80   |           |      |                |       |           |           | \$619.20   | \$1,118.50 | \$1,330.00 |
| 16   |      | \$412.90       | \$931.80   |           |      |                |       |           |           | \$619.20   | \$1,242.50 | \$1,477.70 |
| 17   |      | \$560.20       | \$1,264.10 |           |      |                |       |           |           | \$840.10   | \$1,420.50 | \$1,691.00 |
| 18   |      | \$560.20       | \$1,264.10 |           |      |                |       |           |           | \$840.10   | \$1,580.40 | \$1,878.90 |
| 20   |      | \$704.20       | \$1,588.30 |           |      |                |       |           |           | \$1,056.50 | \$1,220.30 | \$2,121.00 |
| 22   |      | \$784.20       | \$1,769.60 |           |      |                |       |           |           | \$1,176.10 | \$1,325.50 | \$2,305.40 |
| 24   |      | \$901.80       | \$2,034.80 |           |      |                |       |           |           | \$1,352.70 | \$1,496.70 | \$2,609.80 |
| 26   |      |                |            |           |      |                |       |           |           |            | \$1,531.70 | \$2,667.00 |
| 28   |      |                |            |           |      |                |       |           |           |            | \$1,564.60 | \$2,721.30 |
| 30   |      |                |            |           |      |                |       |           |           |            | \$1,797.10 | \$3,129.90 |
| 32   |      |                |            |           |      |                |       |           |           |            | \$1,924.90 | \$3,355.40 |
| 34   |      |                |            |           |      |                |       |           |           |            |            |            |
| 36   |      |                |            |           |      |                |       |           |           |            |            |            |
| 38   |      |                |            |           |      |                |       |           |           |            |            |            |
| 40   |      |                |            |           |      |                |       |           |           |            |            |            |



**Ball Joint**

| Ø in | Standard gauge |       |
|------|----------------|-------|
|      | Galv           | 304SS |
| 3    | \$269.40       |       |
| 4    | \$269.40       |       |
| 5    | \$325.90       |       |
| 6    | \$340.30       |       |
| 7    | \$354.40       |       |
| 8    | \$453.30       |       |
| 9    | \$538.60       |       |
| 10   | \$595.30       |       |
| 12   | \$666.10       |       |
| 14 * | \$1,161.90     |       |

\* 14" diameter - up to 6 weeks lead time



**Jet Cap**

| Ø in | Ends | Standard gauge |            | Ends       | Standard gauge |            |            |
|------|------|----------------|------------|------------|----------------|------------|------------|
|      |      | Galv           | 304SS      |            | Galv           | 304SS      |            |
| 6    | QF   | \$235.30       | \$531.80   | AFL        |                |            |            |
| 8    |      | \$327.90       | \$739.10   |            |                |            |            |
| 10   |      | \$403.40       | \$909.90   |            |                |            |            |
| 12   |      | \$473.90       | \$1,068.90 |            |                |            |            |
| 13   |      | \$563.20       | \$1,271.00 |            |                |            |            |
| 14   |      | \$563.20       | \$1,271.00 |            |                |            |            |
| 15   |      | \$660.40       | \$1,491.00 |            |                |            |            |
| 16   |      | \$660.40       | \$1,491.00 |            |                |            |            |
| 17   |      | \$896.00       | \$2,022.50 |            |                |            |            |
| 18   |      | \$896.00       | \$2,022.50 |            |                |            |            |
| 20   |      | \$1,127.00     | \$2,541.40 |            |                |            |            |
| 22   |      | \$1,254.80     | \$2,825.80 |            |                |            |            |
| 24   |      | \$1,442.90     | \$3,255.90 |            |                |            |            |
| 26   |      |                |            |            |                | \$1,732.30 | \$3,374.70 |
| 28   |      |                |            |            |                | \$1,952.20 | \$3,404.20 |
| 30   |      |                |            |            |                | \$2,120.70 | \$3,618.20 |
| 32   |      |                |            |            |                | \$2,394.90 | \$3,819.10 |
| 34   |      |                |            |            |                | \$2,450.80 | \$4,282.90 |
| 36   |      |                |            | \$2,503.30 | \$4,497.20     |            |            |
| 38   |      |                |            | \$2,875.30 | \$4,925.40     |            |            |
| 40   |      |                |            | \$3,080.10 | \$5,278.40     |            |            |



**Silencer**

| Ø in | Ends | Standard gauge |            | Ends       | Standard gauge |            |            |
|------|------|----------------|------------|------------|----------------|------------|------------|
|      |      | Galv           | 304SS      |            | Galv           | 304SS      |            |
| 3    | QF   | \$761.80       | \$1,436.20 | AFL        |                |            |            |
| 4    |      | \$794.40       | \$1,497.60 |            |                |            |            |
| 5    |      | \$819.90       | \$1,544.90 |            |                |            |            |
| 6    |      | \$851.80       | \$1,605.10 |            |                |            |            |
| 7    |      | \$996.20       | \$1,877.30 |            |                |            |            |
| 8    |      | \$1,178.60     | \$2,221.10 |            |                |            |            |
| 9    |      | \$1,270.00     | \$2,393.20 |            |                |            |            |
| 10   |      | \$1,391.50     | \$2,622.50 |            |                |            |            |
| 12   |      | \$1,444.60     | \$2,722.70 |            |                |            |            |
| 14   |      | \$1,535.70     | \$2,894.50 |            |                |            |            |
| 16   |      | \$1,741.20     | \$3,281.50 |            |                |            |            |
| 18   |      | \$1,887.00     | \$3,914.30 |            |                |            |            |
| 20   |      | \$2,212.60     | \$4,169.90 |            |                |            |            |
| 22   |      | \$2,395.10     | \$4,514.10 |            |                |            |            |
| 24   |      | \$2,603.10     | \$4,906.20 |            |                |            |            |
| 26   |      |                |            |            |                | \$3,906.00 | \$7,361.10 |
| 28   |      |                |            |            |                | \$3,935.90 | \$7,417.80 |
| 30   |      |                |            |            |                | \$4,016.00 | \$7,568.60 |
| 32   |      |                |            | \$4,135.00 | \$7,793.00     |            |            |
| 34   |      |                |            | \$4,176.60 | \$7,871.50     |            |            |
| 36   |      |                |            | \$4,977.20 | \$9,379.80     |            |            |
| 38   |      |                |            | \$5,086.40 | \$9,586.30     |            |            |
| 40   |      |                |            | \$5,122.80 | \$9,654.20     |            |            |

**Suction Nozzle Assembly**

| Ø in | Ends | Galv     | 304SS    |
|------|------|----------|----------|
| 4    | QF   | \$149.90 | \$428.00 |



**Butterfly Valve**

| Ø in | Ends     | Standard gauge |          |
|------|----------|----------------|----------|
|      |          | Galv           | 304SS    |
| 3    | QF       | \$91.50        | \$206.20 |
| 4    |          | \$91.50        | \$206.20 |
| 5    |          | \$92.20        | \$207.40 |
| 6    |          | \$93.00        | \$209.70 |
| 7    |          | \$98.50        | \$221.50 |
| 8    |          | \$99.20        | \$223.90 |
| 9    |          | \$100.60       | \$227.60 |
| 10   |          | \$101.80       | \$229.60 |
| 11   |          | \$107.10       | \$241.90 |
| 12   |          | \$107.10       | \$241.90 |
| 13   |          | \$122.60       | \$276.00 |
| 14   |          | \$122.60       | \$276.00 |
| 15   |          | \$131.30       | \$296.00 |
| 16   |          | \$131.30       | \$296.00 |
| 17   |          | \$142.40       | \$321.40 |
| 18   |          | \$142.40       | \$321.40 |
| 20   |          | \$159.90       | \$361.10 |
| 22   |          | \$177.50       | \$401.10 |
| 24   | \$204.20 | \$461.20       |          |



**Bleed-in Valve**

| Ø in | Ends     | Standard gauge |          |
|------|----------|----------------|----------|
|      |          | Galv           | 304SS    |
| 3    | QF       | \$92.70        | \$158.70 |
| 4    |          | \$92.70        | \$158.70 |
| 5    |          | \$106.50       | \$182.70 |
| 6    |          | \$110.80       | \$190.20 |
| 7    |          | \$119.30       | \$204.60 |
| 8    |          | \$123.20       | \$211.40 |
| 9    |          | \$135.70       | \$232.60 |
| 10   |          | \$144.30       | \$247.30 |
| 11   |          | \$150.80       | \$259.20 |
| 12   |          | \$150.80       | \$259.20 |
| 13   |          | \$166.00       | \$285.40 |
| 14   |          | \$166.00       | \$285.40 |
| 15   |          | \$182.10       | \$312.10 |
| 16   |          | \$182.10       | \$312.10 |
| 17   |          | \$203.30       | \$348.90 |
| 18   |          | \$203.30       | \$348.90 |
| 20   |          | \$235.20       | \$404.20 |
| 22   |          | \$261.70       | \$449.30 |
| 24   | \$300.70 | \$516.90       |          |



**Sliding Access Panel**

| Ø in | Ends | Standard gauge |            |
|------|------|----------------|------------|
|      |      | Galv           | 304SS      |
| 6    | QF   | \$196.70       | \$337.50   |
| 7    |      | \$217.50       | \$385.80   |
| 8    |      | \$228.20       | \$402.10   |
| 9    |      | \$238.30       | \$432.40   |
| 10   |      | \$248.40       | \$457.10   |
| 11   |      | \$276.40       | \$518.60   |
| 12   |      | \$285.50       | \$518.60   |
| 13   |      | \$338.30       | \$636.60   |
| 14   |      | \$338.30       | \$636.60   |
| 15   |      | \$394.60       | \$742.00   |
| 16   |      | \$394.60       | \$742.00   |
| 17   |      | \$437.50       | \$844.60   |
| 18   |      | \$437.50       | \$844.60   |
| 20   |      | \$498.80       | \$978.90   |
| 22   |      | \$546.00       | \$1,085.20 |
| 24   |      | \$614.00       | \$1,235.70 |



**In Line Back Draft Damper**

| Ø in | Ends | Standard gauge |            | Ends | Standard gauge |            |            |
|------|------|----------------|------------|------|----------------|------------|------------|
|      |      | Galv           | 304SS      |      | Galv           | 304SS      |            |
| 3    | QF   | \$258.80       | \$443.40   | AFL  |                |            |            |
| 4    |      | \$258.80       | \$443.40   |      |                |            |            |
| 5    |      | \$327.00       | \$560.20   |      |                |            |            |
| 6    |      | \$385.20       | \$660.00   |      |                |            |            |
| 7    |      | \$449.80       | \$770.80   |      |                |            |            |
| 8    |      | \$514.80       | \$881.70   |      |                |            |            |
| 9    |      | \$569.40       | \$976.00   |      |                |            |            |
| 10   |      | \$631.00       | \$1,081.30 |      |                |            |            |
| 11   |      | \$692.10       | \$1,186.60 |      |                |            |            |
| 12   |      | \$692.10       | \$1,186.60 |      |                |            |            |
| 13   |      | \$763.50       | \$1,308.70 |      |                |            |            |
| 14   |      | \$763.50       | \$1,308.70 |      |                |            |            |
| 15   |      | \$834.50       | \$1,430.50 |      |                |            |            |
| 16   |      | \$834.50       | \$1,430.50 |      |                |            |            |
| 17   |      | \$919.00       | \$1,574.70 |      |                |            |            |
| 18   |      | \$919.00       | \$1,574.70 |      |                |            |            |
| 20   |      | \$1,048.30     | \$1,796.70 |      |                |            |            |
| 22   |      | \$1,297.10     | \$2,223.50 |      |                |            |            |
| 24   |      | \$1,459.10     | \$2,501.10 |      |                |            |            |
| 26   |      |                |            |      |                | \$1,565.90 | \$2,683.70 |
| 28   |      |                |            |      |                | \$1,630.50 | \$2,794.60 |
| 30   |      |                |            |      |                | \$1,814.80 | \$3,110.90 |
| 32   |      |                |            |      |                | \$1,934.70 | \$3,316.00 |
| 34   |      |                |            |      |                | \$2,063.90 | \$3,537.80 |



**Viewing Spool**

| Ø in | Ends | Standard gauge |            |
|------|------|----------------|------------|
|      |      | Galv           | 304SS      |
| 3    | QF   | \$427.30       | \$544.60   |
| 4    |      | \$427.30       | \$544.60   |
| 5    |      | \$437.70       | \$557.60   |
| 6    |      | \$445.00       | \$566.80   |
| 7    |      | \$473.30       | \$603.30   |
| 8    |      | \$496.30       | \$632.60   |
| 9    |      | \$545.00       | \$694.70   |
| 10   |      | \$580.80       | \$740.20   |
| 11   |      | \$637.00       | \$811.90   |
| 12   |      | \$637.00       | \$811.90   |
| 14   |      | \$695.80       | \$886.60   |
| 16   |      | \$731.50       | \$932.10   |
| 18   |      | \$915.30       | \$1,014.50 |



**Vibration Isolator**

| Ø in | Ends | Standard gauge |            | Ends     | Standard gauge |          |            |
|------|------|----------------|------------|----------|----------------|----------|------------|
|      |      | Galv           | 304SS      |          | Galv           | 304SS    |            |
| 3    | QF   | \$123.00       | \$210.60   | AFL      |                |          |            |
| 4    |      | \$123.00       | \$210.60   |          |                |          |            |
| 5    |      | \$133.60       | \$228.70   |          |                |          |            |
| 6    |      | \$147.00       | \$252.60   |          |                |          |            |
| 7    |      | \$164.50       | \$282.40   |          |                |          |            |
| 8    |      | \$184.70       | \$317.10   |          |                |          |            |
| 9    |      | \$194.00       | \$332.80   |          |                |          |            |
| 10   |      | \$203.60       | \$349.20   |          |                |          |            |
| 11   |      | \$307.20       | \$526.80   |          |                |          |            |
| 12   |      | \$307.20       | \$526.80   |          |                |          |            |
| 13   |      | \$352.00       | \$603.30   |          |                |          |            |
| 14   |      | \$352.00       | \$603.30   |          |                |          |            |
| 15   |      | \$429.10       | \$735.90   |          |                |          |            |
| 16   |      | \$429.10       | \$735.90   |          |                |          |            |
| 17   |      | \$463.60       | \$795.50   |          |                |          |            |
| 18   |      | \$463.60       | \$795.50   |          |                |          |            |
| 20   |      | \$498.00       | \$854.50   |          |                |          |            |
| 22   |      | \$542.10       | \$929.50   |          |                |          |            |
| 24   |      | \$623.50       | \$1,069.00 |          |                |          |            |
| 26   |      |                |            |          |                | \$639.00 | \$2,135.60 |
| 28   |      |                |            |          |                | \$686.30 | \$2,249.00 |
| 30   |      |                |            |          |                | \$726.70 | \$2,349.60 |
| 32   |      |                |            |          |                | \$770.90 | \$2,461.90 |
| 34   |      |                |            |          |                | \$817.20 | \$2,572.20 |
| 36   |      |                |            | \$866.10 | \$2,693.90     |          |            |
| 38   |      |                |            | \$918.60 | \$2,966.50     |          |            |
| 40   |      |                |            | \$974.00 | \$3,198.10     |          |            |



**In-line Spark Trap 2.0**

| Ø in | Ends       | Powder coated Mild Steel | Ends | Powder coated Mild Steel |
|------|------------|--------------------------|------|--------------------------|
|      |            |                          |      |                          |
| 5    | \$1,072.80 | \$1152.20                |      |                          |
| 6    | \$1,313.90 | \$1402.30                |      |                          |
| 7    | \$1,542.60 | \$1635.20                |      |                          |
| 8    | \$1,750.90 | \$1854.70                |      |                          |
| 9    | \$1,853.10 | \$1964.10                |      |                          |
| 10   | \$1,979.70 | \$2104.90                |      |                          |
| 11   | \$2,114.60 | \$2264.40                |      |                          |
| 12   | \$2,114.60 | \$2264.40                |      |                          |
| 13   | \$2,582.40 | \$2758.40                |      |                          |
| 14   | \$2,582.40 | \$2758.40                |      |                          |
| 15   | \$2,875.80 | \$3097.80                |      |                          |
| 16   | \$2,875.80 | \$3097.80                |      |                          |
| 17   | \$3,235.00 | \$3467.60                |      |                          |
| 18   | \$3,235.00 | \$3467.60                |      |                          |
| 19   | \$3,594.40 | \$3837.40                |      |                          |
| 20   | \$3,594.40 | \$3837.40                |      |                          |
| 22   | \$3,954.10 | \$4219.50                |      |                          |
| 24   | \$4,313.30 | \$4601.70                |      |                          |

◊ Items may take longer than standard lead times.

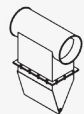

**Drop Out Box**

| Ø in | Ends | Standard gauge |
|------|------|----------------|
|      |      | Galv           |
| 6    | QF   | \$1,960.40     |
| 7    |      | \$2,001.00     |
| 8    |      | \$2,061.80     |
| 9    |      | \$2,203.80     |
| 10   |      | \$2,203.80     |
| 11   |      | \$2,311.90     |
| 12   |      | \$2,311.90     |
| 14   |      | \$2,447.10     |
| 16   |      | \$2,528.20     |



**Floor Sweep**

| Ø in | Ends | Standard gauge |          |
|------|------|----------------|----------|
|      |      | Galv           | 304SS    |
| 3    | QF   | \$312.30       | \$608.40 |
| 4    |      | \$312.30       | \$608.40 |
| 5    |      | \$328.00       | \$641.30 |
| 6    |      | \$343.30       | \$669.50 |
| 7    |      | \$374.30       | \$756.10 |
| 8    |      | \$392.70       | \$791.60 |
| 9    |      | \$408.30       | \$825.00 |
| 10   |      | \$423.80       | \$848.90 |
| 11   |      | \$439.30       | \$933.70 |
| 12   |      | \$439.30       | \$933.70 |





| Ø in | Gasket  |
|------|---------|
| 3    | \$4.40  |
| 4    | \$4.60  |
| 5    | \$4.60  |
| 6    | \$5.90  |
| 7    | \$6.80  |
| 8    | \$8.20  |
| 9    | \$8.20  |
| 10   | \$10.80 |
| 11   | \$10.80 |
| 12   | \$14.00 |
| 13   | \$14.00 |
| 14   | \$16.40 |
| 15   | \$16.40 |
| 16   | \$18.70 |
| 18   | \$20.50 |
| 20   | \$22.80 |
| 22   | \$28.20 |
| 24   | \$30.80 |



| Ø in | O-Ring |
|------|--------|
| 3    | \$2.60 |
| 4    | \$2.60 |
| 5    | \$3.00 |
| 6    | \$3.00 |
| 7    | \$3.40 |
| 8    | \$3.50 |
| 9    | \$3.80 |
| 10   | \$3.90 |
| 11   | \$4.20 |
| 12   | \$4.20 |
| 13   | \$4.60 |
| 14   | \$4.60 |
| 15   | \$4.90 |
| 16   | \$4.90 |
| 18   | \$5.50 |
| 20   | \$5.70 |
| 22   | \$6.10 |
| 24   | \$6.40 |

| Ø in | QFS Sealant  |
|------|--------------|
| 3    | 25% Upcharge |
| 4    |              |
| 5    |              |
| 6    |              |
| 7    |              |
| 8    |              |
| 9    |              |
| 10   |              |
| 11   |              |
| 12   |              |
| 13   |              |
| 14   |              |
| 15   |              |
| 16   |              |
| 18   |              |
| 20   |              |
| 22   |              |
| 24   |              |

| Ø in | Buffing      |
|------|--------------|
| 3    | 10% Upcharge |
| 4    |              |
| 5    |              |
| 6    |              |
| 7    |              |
| 8    |              |
| 9    |              |
| 10   |              |
| 11   |              |
| 12   |              |
| 13   |              |
| 14   |              |
| 15   |              |
| 16   |              |
| 18   |              |
| 20   |              |
| 22   |              |
| 24   |              |

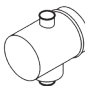

| Ø in | Ends | Standard gauge |            |
|------|------|----------------|------------|
|      |      | Galv           | 304SS      |
| 3    | QF   | \$650.00       | \$1,503.70 |
| 4    |      | \$650.00       | \$1,503.70 |
| 5    |      | \$650.00       | \$1,503.70 |
| 6    |      | \$650.00       | \$1,503.70 |
| 7    |      | \$774.50       | \$1,791.70 |
| 8    |      | \$774.50       | \$1,791.70 |
| 9    |      | \$774.50       | \$1,791.70 |
| 10   |      | \$774.50       | \$1,791.70 |
| 12   |      | \$934.10       | \$2,161.10 |

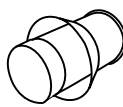

| Ø in | Ends | Standard gauge |                             | Ends | Standard gauge |                             |
|------|------|----------------|-----------------------------|------|----------------|-----------------------------|
|      |      | Galv           | 304SS                       |      | Galv           | 304SS                       |
| 3    | QF   | \$126.20       | Contact Nordfab for pricing | AFL  | \$140.70       | Contact Nordfab for pricing |
| 4    |      | \$133.00       |                             |      | \$147.40       |                             |
| 5    |      | \$155.90       |                             |      | \$171.70       |                             |
| 6    |      | \$165.40       |                             |      | \$186.40       |                             |
| 7    |      | \$168.00       |                             |      | \$189.00       |                             |
| 8    |      | \$179.50       |                             |      | \$205.70       |                             |
| 9    |      | \$191.50       |                             |      | \$220.50       |                             |
| 10   |      | \$200.30       |                             |      | \$235.00       |                             |
| 12   |      | \$213.90       |                             |      | \$259.20       |                             |





# Nordfab Americas: Terms & Conditions of Sale

Effective September 13, 2023

## GENERAL TERMS

These Terms & Conditions of Sale (these "Terms") shall govern all conduct between the Buyer and Nordfab, LLC ("Nordfab") regardless of the nature or form of Buyer's offer to purchase products or services from Nordfab (the "Products"). To the extent a Nordfab order acknowledgement, invoice, or other document or transmittal constitutes an acceptance of an offer from Buyer, such acceptance is expressly made conditional upon Buyer's assent to these Terms. "Buyer" means the individual or entity identified on Buyer's purchase order, or if different, on Nordfab's quote.

The entire agreement of Nordfab and Buyer is expressed exclusively in: (i) the terms, covenants and conditions set forth in these Terms, (ii) the drawings, specifications and descriptions attached hereto or transmitted herewith (if any) (collectively, the "Documentation"), (iii) a Nordfab quote and (iv) Nordfab's acceptance or acknowledgement of Buyer's purchase order (clauses (iii) and (iv) together, an "Order"). In the event that any quotation, proposal, purchase order, order acknowledgement, order acceptance and/or other sales form or documentation contains terms which are in addition to, different from or inconsistent with those set forth in these Terms, these Terms shall be controlling and any such additional, different or inconsistent terms and conditions shall be inapplicable and are hereby objected to. Receipt and acceptance by Buyer of Products supplied by Nordfab shall constitute Buyer's acceptance and assent to these Terms. Buyer should print and retain a copy of these Terms for its records.

These Terms shall be governed, construed, and enforced in accordance with the laws of the State of North Carolina, excluding that State's conflict of law principles, as to all matters arising out of or relating to these Terms. Nordfab and the Buyer exclude the application of the 1980 United Nations Convention on Contracts for the International Sale of Goods if otherwise applicable. Any claim, or litigation arising out of or relating to the Products shall be brought exclusively in a court of competent jurisdiction in Davidson County, North Carolina.

Nordfab and Buyer may modify these Terms, or the associated Order, only by an express written agreement signed by both parties. Nordfab's waiver of any breach of any provision contained in these Terms will not waive any other breach by Buyer. Nordfab's delay or failure to enforce its rights under these Terms shall not be deemed a waiver of such rights. Except for Buyer's payment and indemnification obligations, neither party shall be liable for its failure to perform any obligation hereunder or under any Order to the extent that such failure results from circumstances beyond such party's reasonable control, including, without limitation, fire, explosion, flood, or other acts of God; acts, regulations, or the laws of any government; plague, epidemic, pandemic, outbreaks of infectious disease or any other public health crisis (including quarantine or other employee restrictions); riot, war or civil commotion; acts of terrorism; strike, lock-out or labor disturbances; or failure of public utilities or common carriers. The relationship between the parties is that of independent contractors. Neither party shall have authority to contract for or bind the other party in any manner whatsoever. Any part of these Terms held to be invalid or unenforceable by a tribunal of competent jurisdiction shall be deemed ineffective to the extent thereof without affecting the validity or enforceability of any other part of these Terms. Provisions of these Terms which by their nature should apply beyond their terms will remain in force after any termination or expiration of these Terms.

These Terms are binding upon, and shall inure to the benefit of Buyer, Nordfab and their successors and permitted assigns. Buyer may not assign all or any portion of its rights or obligations hereunder without the prior written consent of Nordfab. Nordfab may assign, delegate or subcontract an Order or any of its obligations under these Terms, in whole or in part, without Buyer's consent.

## LIMITED WARRANTY

Nordfab warrants that the Products sold hereunder conform to any applicable Documentation and will be free from any defects in material and workmanship which become apparent under normal use. This limited warranty applies to the original Buyer only and is non-transferable. To make a claim under this limited warranty, Buyer must give written notice to Nordfab within a period of 12 months from the date of installation or 12 months from the date of shipment, whichever period first expires. If, within that period, Nordfab receives from Buyer written notice of any alleged defect in or non-conformance of any Product covered by this limited warranty and if, in Nordfab's sole judgment, the Product does not conform with this limited warranty, then Buyer shall, at Nordfab's request, return the part or Product F.O.B. Nordfab's shipping point. Nordfab, at its sole option and expense, shall then repair or replace the defective part or Product or repay Buyer the full price paid for such part or Product. Dismounting of defective or non-conforming parts and remounting of any repaired or replaced parts is at Buyer's sole expense. This limited warranty, as it relates to the delivery of spare parts or replacement for non-conforming parts, expires when the limited warranty for the original Product or equipment expires. Any repayment of the purchase price shall be without interest. **NORDFAB'S SOLE RESPONSIBILITY, AND BUYER'S EXCLUSIVE REMEDY HEREUNDER, SHALL BE LIMITED TO SUCH REPAIR, REPLACEMENT, OR REPAYMENT OF THE PURCHASE PRICE AS ABOVE PROVIDED. NO OTHER WARRANTIES, EXPRESS, STATUTORY, OR IMPLIED, ARE MADE AND ANY AND ALL IMPLIED WARRANTIES OF MERCHANTABILITY, TITLE, NON-INFRINGEMENT, QUALITY, OR FITNESS FOR PARTICULAR PURPOSE ARE EXPRESSLY DISCLAIMED.** This limited warranty does not cover and Nordfab makes no warranty with respect to:

- failures not reported to Nordfab within the warranty period specified above;
- failure or damage due to misapplication, abuse, improper installation or abnormal conditions of any kind, including, but not limited to, temperature, dirt or other corrosive matter;
- failures due to operation, either intentional or otherwise, above rated capacities or in an otherwise improper manner;
- Products which have been in any way tampered with or altered by anyone other than an authorized representative of Nordfab;
- Products damaged in shipment or otherwise without fault of Nordfab;
- expenses incurred by Buyer in an attempt to repair, rework, or replace any alleged defective Product; and
- defects in material and workmanship which are attributable to drawings and specifications provided by Buyer.

## TERMS OF PAYMENT

Unless agreed to in writing by an authorized officer of Nordfab, the payment terms hereunder and under each Order are NET 30. If the full purchase price is not paid by Buyer NET 30, then interest shall accrue at the rate of 1.5% per month. Buyer agrees that if Nordfab is required to bring suit to collect any sums due Nordfab under these Terms, then Buyer shall be responsible for all costs and expenses incurred by Nordfab, including but not limited to Nordfab's reasonable attorney's fees.

## CLAIMS FOR SHORTAGES

Any claims for loss, breakage (obvious or concealed), or shortage are Buyer's sole responsibility and should be made to the carrier immediately. Nordfab will render Buyer reasonable assistance in securing satisfactory adjustment of such claims. Any notice of shortages or other errors must be made in writing to Nordfab within 30 days after receipt of shipment. Failure to give such notice shall constitute unqualified acceptance of the Product and a waiver by Buyer of all claims against Nordfab for loss, breakage or shortage. Risk of loss for damage to Products sold under these Terms passes to Buyer when the carrier takes custody of any of the Products purchased under these Terms regardless of which party pays shipping costs.

## ORDERING NOTES:

Unless specified, 3" through 24" is QF; over 24" is flanged. Data is subject to change without notice. Stainless steel components requiring flanges will be supplied with SS flanges unless otherwise specified. Stainless steel components are manufactured with standard gauges 304SS. (Call for quotation on SS 316 & 304SS heavy gauge prices) For special parts or items to be custom manufactured, call for quotation.

If you would like more information regarding our use of information you provide to us, please see our Privacy Policy on our website at [nordfab.com/en-us/privacy-policy](http://nordfab.com/en-us/privacy-policy)

## NORDFAB NOW®

Nordfab will make commercially reasonable efforts to ship Nordfab Now Products the following day if an Order is received by Nordfab's then-current standard daily order cutoff time ("Next Day Shipment"). However, there will be occasions where Next Day Shipment is not possible due to various circumstances, and time of delivery is not of the essence. Nordfab makes no guarantee for Next Day Shipment of Nordfab Now Products.

## LIMITATION OF LIABILITY

IN NO EVENT SHALL NORDFAB BE LIABLE FOR ANY SPECIAL, INDIRECT, INCIDENTAL, CONSEQUENTIAL OR COMPENSATORY DAMAGES OF ANY CHARACTER, INCLUDING, BUT NOT LIMITED TO, LOSS OF USE OF PRODUCTION FACILITIES OR EQUIPMENT, LOST REVENUES OR PROFITS, BUSINESS OR GOODWILL, PROPERTY DAMAGE, EXPENSES INCURRED IN RELIANCE ON NORDFAB'S PERFORMANCE HEREUNDER, AND/OR LOST PRODUCTION, WHETHER SUFFERED BY BUYER OR ANY THIRD PARTY, IN EACH CASE EVEN IF NORDFAB HAS BEEN ADVISED OR IS AWARE OF THE POSSIBILITY OF SUCH DAMAGES. NORDFAB SPECIFICALLY DISCLAIMS ALL LIABILITY FOR ANY AND ALL COSTS, CLAIMS, DEMANDS, CHARGES, EXPENSES OR OTHER DAMAGES, EITHER DIRECT OR INDIRECT, INCIDENT TO ALL PROPERTY DAMAGES ARISING OUT OF ANY CAUSE OF ACTION BASED ON STRICT LIABILITY. UNDER NO CIRCUMSTANCES SHALL NORDFAB'S AGGREGATE LIABILITY ARISING OUT OF OR IN CONNECTION WITH THE SALE OF PRODUCTS, IN CONTRACT, TORT OR OTHERWISE, EXCEED THE PURCHASE PRICE OF THE PRODUCT TO WHICH SUCH LIABILITY RELATES. ANY CAUSE OF ACTION BROUGHT BY BUYER ARISING OUT OF OR RELATING TO THESE TERMS, AN ORDER OR THE SALE OF PRODUCTS, INCLUDING WITHOUT LIMITATION, FOR BREACH OF CONTRACT OR TORT, MUST BE COMMENCED WITHIN ONE YEAR AFTER THE CAUSE OF ACTION HAS ACCRUED.

The foregoing limitations, exclusions and disclaimers are an allocation of the risk between the parties and will apply to the maximum extent permitted by applicable law, even if any remedy fails in its essential purpose.

## INTELLECTUAL PROPERTY RIGHTS

The sale of Products or provision of services hereunder does not convey any express or implied license under any patent, copyright, trademark or other proprietary rights owned or controlled by Nordfab (beyond the use of the Product in the manner intended by Nordfab). Buyer agrees not to infringe, directly or indirectly, any patents and other intellectual property rights of Nordfab or its affiliates through any combination or system incorporating a Product sold hereunder. In the event a Product is made or modified in accordance with Buyer's drawings, samples, manufacturing specifications, or the like, Buyer agrees to indemnify, defend, and hold Nordfab harmless from any and all damages, costs and expenses (including attorney's fees) related to any claim of patent or other intellectual property right infringement arising from such manufacture or modification. Buyer agrees, at Nordfab's sole discretion, to undertake the defense of such suit at its own expense.

## NOTICES

All notices will be in writing and sent via certified mail or overnight courier, return receipt requested, to the address set forth in the Order, or to such other address as a party may give to the other party in the manner provided herein for giving notice. Notice will be considered given upon receipt.

## COMPLIANCE WITH LAWS

Buyer shall comply with all laws and regulations applicable to the Products, including, but not limited to, all applicable import and export laws and regulations. Buyer has sole responsibility for obtaining any required export licenses. If the ultimate destination of the Products is outside of the United States, Buyer shall designate such country on its purchase order. In the event that Buyer purchases Products for export without so notifying Nordfab, Nordfab reserves the right to cancel the applicable Order. Buyer will have sole liability and shall defend, indemnify, release and hold Nordfab harmless for any loss or damage (including without limitation, claims of governmental authorities) arising from the export from the United States or import into another country of such Products.

Without limiting the foregoing, Buyer represents and warrants to Nordfab that: (i) it is in compliance with all laws, ordinances, regulations and orders administered by the Office of Foreign Assets Control within the U.S. Department of the Treasury ("OFAC") or any other governmental authority imposing economic sanctions and trade embargoes ("Economic Sanctions Laws") against designated countries ("Embargoed Countries"), entities and persons (collectively, "Embargoed Targets"), and (ii) it is not itself an Embargoed Target or otherwise subject to any Economic Sanctions Law. Buyer shall comply with all Economic Sanctions Laws. Without limiting the generality of the foregoing, Buyer shall not (x) directly or indirectly export, re-export, transship, or otherwise deliver any Product (or any component or part thereof) to an Embargoed Target, or (y) broker, finance, or otherwise facilitate any transaction in violation of any Economic Sanctions Law.

## ORDER CHANGES

Buyer may request changes to an Order (including the cancellation thereof) by sending an e-mail to Buyer's Inside Sales Account Manager and specifying in detail the requested changes (a "Change Order Request"). No Change Order Request will become effective until accepted or acknowledged in writing by Nordfab. In the event Nordfab accepts a Change Order Request, Buyer may be charged a change fee ranging from 10% to 100% of the total purchase price of the Products affected by such Change Order Request (the "Change Fee"), in each case as determined in Nordfab's sole discretion based on the production status and type of the affected Products and the nature of the Change Order Request. If Buyer submits a Change Order Request to delay the shipment of Products that have been produced and are ready for shipment, Buyer will be charged a storage fee of \$50 per day per box of affected Products (such storage fee together with the Change Fee, the "Change Order Fees"). All Change Order Fees will be in addition to the purchase price charged to Buyer under the applicable Order. Nordfab will invoice Buyer for any Change Order Fees, and Buyer shall pay such amounts in accordance with the payment terms set forth herein. Once an Order has shipped, Buyer may not submit a Change Order Request for such Order, provided that this section shall not affect Buyer's right to return Products as otherwise set forth herein.

## RETURN MATERIAL AUTHORIZATION

To return Products to Nordfab, dealers must fill out an RGA Worksheet. The RGA can be requested from Nordfab's Sales Department. Each RGA must be filled out completely. Absolutely no shipments will be accepted by Nordfab without an RGA. Shipments without RGAs will be returned to shipper at shipper's expense. No RGA will be issued for any Order more than 90 days from the original ship date. If issued, an RGA is valid for 30 days from date of issue. Nordfab Products must be received at our designated return point factory within that 30 days in order for the dealer to receive credit. Only restockable items may be returned to Nordfab. Restockable items are identified in Nordfab's Product Reference and on Nordfab's website. All other items are considered custom or special order and are nonreturnable. Nordfab reserves the right to limit return quantities. All returned goods must be shipped freight prepaid. All Nordfab ductwork must be shipped vertically with rolled edge down to avoid incurring out-of-round damage during shipping. There is a 25% restocking charge for all returned goods. All components must arrive in "as-new" sellable condition. Damage and "white rust" occur over time at job sites, which may cause the items to not be sellable. Final determination of sell ability will be determined by Nordfab, at its sole discretion.

