

# TECHNICAL DATA SHEET: FLANGED FLN FLANGE

| Ø mm | d mm | d1 mm | D mm | Galvanised / Mild Steel Thickness mm | Galvanised / Mild Steel Weight kg | 304SS Thickness mm | 304SS Weight kg | W mm | Hole Ø | No. holes |
|------|------|-------|------|--------------------------------------|-----------------------------------|--------------------|-----------------|------|--------|-----------|
| 80   | 81   | 107   | 121  | 5                                    | 0,3                               | 3                  | 0,3             | 20   | 10     | 4         |
| 100  | 101  | 127   | 143  | 5                                    | 0,3                               | 3                  | 0,3             | 20   | 10     | 4         |
| 125  | 126  | 157   | 178  | 5                                    | 0,5                               | 3                  | 0,4             | 25   | 10     | 4         |
| 140  | 141  | 172   | 193  | 5                                    | 0,5                               | 3                  | 0,4             | 25   | 10     | 6         |
| 150  | 151  | 182   | 203  | 5                                    | 0,5                               | 5                  | 0,5             | 25   | 10     | 6         |
| 160  | 161  | 192   | 213  | 5                                    | 0,6                               | 5                  | 0,6             | 25   | 10     | 6         |
| 180  | 181  | 212   | 233  | 5                                    | 0,6                               | 5                  | 0,6             | 25   | 10     | 6         |
| 200  | 203  | 232   | 253  | 5                                    | 0,7                               | 5                  | 0,7             | 25   | 10     | 6         |
| 225  | 227  | 257   | 279  | 5                                    | 0,8                               | 5                  | 0,8             | 25   | 10     | 6         |
| 250  | 253  | 289   | 313  | 5                                    | 1,1                               | 5                  | 0,9             | 30   | 10     | 6         |
| 300  | 303  | 339   | 363  | 5                                    | 1,3                               | 5                  | 1,0             | 30   | 10     | 6         |
| 315  | 317  | 349   | 377  | 5                                    | 1,3                               | 5                  | 1,3             | 30   | 10     | 8         |
| 350  | 353  | 387   | 413  | 5                                    | 1,4                               | 6                  | 1,8             | 30   | 10     | 8         |
| 400  | 404  | 438   | 464  | 5                                    | 1,6                               | 6                  | 2,1             | 30   | 10     | 12        |
| 450  | 454  | 488   | 514  | 5                                    | 1,8                               | 6                  | 2,3             | 30   | 10     | 12        |
| 500  | 504  | 538   | 564  | 5                                    | 2,0                               | 6                  | 2,6             | 30   | 10     | 12        |
| 550  | 554  | 588   | 614  | 5                                    | 2,1                               | 6                  | 2,8             | 30   | 10     | 12        |
| 560  | 565  | 600   | 625  | 5                                    | 2,2                               | 6                  | 2,8             | 30   | 10     | 12        |
| 600  | 604  | 640   | 664  | 5                                    | 3,0                               | 6                  | 3,0             | 30   | 10     | 16        |
| 630  | 635  | 670   | 695  | 5                                    | 3,2                               | 6                  | 3,2             | 30   | 10     | 16        |
| 650  | 654  | 688   | 714  | 5                                    | 3,3                               | 6                  | 3,3             | 30   | 10     | 16        |
| 700  | 704  | 738   | 764  | 5                                    | 3,5                               | 6                  | 3,5             | 30   | 10     | 16        |
| 710  | 715  | 750   | 775  | 5                                    | 3,6                               | 6                  | 3,5             | 30   | 10     | 16        |
| 750  | 754  | 788   | 814  | 5                                    | 4,0                               | 6                  | 5,1             | 30   | 10     | 16        |
| 800  | 804  | 848   | 884  | 5                                    | 4,2                               | 6                  | 5,4             | 40   | 10     | 16        |
| 900  | 904  | 948   | 984  | 5                                    | 4,7                               | 6                  | 6,1             | 40   | 10     | 16        |
| 1000 | 1004 | 1048  | 1084 | 5                                    | 6,2                               | 6                  | 6,7             | 40   | 10     | 16        |

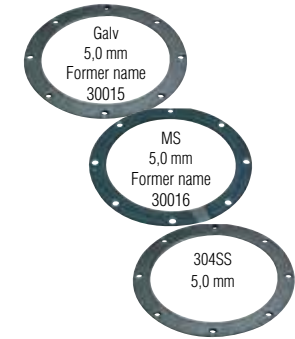
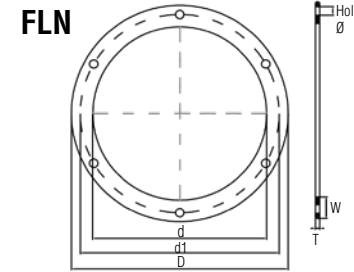

Also formerly named Nordfab flange

### Additional Notes

At temperatures ranging between 200° C and 250° C, the zinc-iron alloy layers in galvanised steel will continue to provide a high level of protection from corrosion. However, there may be some peeling, changes in mechanical properties, and reduction in the corrosion protection.

### Temperature Rating of Product Components

| Flanged FLN Flange |                  |                           |            |
|--------------------|------------------|---------------------------|------------|
| 593°C              |                  | 304 / 316 Stainless Steel | Mild Steel |
| 200°C              | Galvanised Steel |                           |            |
| -20°C              |                  |                           |            |

### Compliance / Rating of Product Components

| Product            | Material                  | Compliance / Rating |
|--------------------|---------------------------|---------------------|
| Flanged FLN Flange | Hot Dipped Galvanised     | S235JR              |
|                    | 304 / 316 Stainless Steel | EN.1.4301/TP.304    |
|                    | Mild Steel                | S235JR              |

