

# TECHNICAL DATA SHEET: QUICK-FIT (QF) TABULAR RIVET ADAPTER

Ø mm	O/D mm	I/D mm	Rolled Edge (nom. mm)	Length (nom. mm)	Weight kg	Galvanised Steel Thickness mm
080	79	78	6	46	0,1	0,7
100	98	97	6	46	0,1	0,7
125	124	123	6	46	0,2	0,7
140	139	138	6	46	0,2	0,7
150	148	147	6	46	0,2	0,7
160	159	158	6	46	0,2	0,7
180	179	178	8	46	0,2	0,7
200	200	199	8	46	0,3	0,7
224	224	223	8	46	0,3	0,7
250	250	249	8	46	0,3	0,7
300	298	297	10	46	0,4	0,7
315	313	312	10	46	0,4	0,7
350	348	347	10	46	0,5	0,9
400	400	398	10	46	0,7	0,9
450	449	447	10	46	0,8	0,9
500	499	497	10	46	0,8	0,9
560	559	557	10	46	1,0	0,9
630	629	627	10	46	1,1	0,9
710	709	707	10	46	1,2	0,9

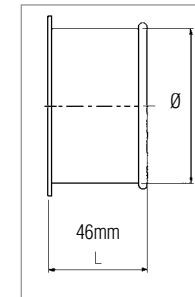

**Ends:** QF (Quick-Fit rolled edge)

### Additional Notes

At temperatures ranging between 200° C and 250° C, the zinc-iron alloy layers in galvanised steel will continue to provide a high level of protection from corrosion. However, there may be some peeling, changes in mechanical properties, and reduction in the corrosion protection. Recommended max. service temperature is +80° C. Stainless Steel available upon request.

### Compliance / Rating of Product Components

Product	Material	Compliance / Rating
Quick-Fit (QF) Tabular Rivet Adapter	Galvanised 304 / 316 Stainless Steel	DX51D with Z275 Coating EN.1.4301/TP.304
Joka Seal Metal Sealant 2315	Aceton Blend	AAMA Specification 801.1

### Temperature Rating of Product Components

	Quick-Fit (QF) Tabular Rivet Adapter	Sealant
<b>593°C</b>		
<b>200°C</b>		
<b>121°C</b>	Galvanised Steel	304 / 316 Stainless Steel
<b>-20°C</b>		Joka Seal Metal Sealant 2315

